



# Power Tools

Product Catalog



## Osborn worldwide



Osborn offers the best solutions for your mechanical surface treatment challenges. Our experts are highly trained to serve you with the best off-the-shelf or customized tools, when and where you need them. Unlike others, we help you optimize your process, meet the highest quality and safety requirements and reduce your costs.

General Information .....	4
Power Tools .....	7
SKU Index .....	106

## Optimal Processes. High Quality.



### Modern Production

Our production systems represent the central element in manufacturing our premium products. We are not only able to produce large volumes and custom products, we can offer them first and foremost with constantly high quality. We have invested considerably in our production facilities in Burgwald. We have modernised the machinery and automated many areas.

At our other sites, we are also active in optimising our production processes. The production systems for our polishing buffs in Portugal, in the heart of the European textile industry, were recently equipped with new machines. An automated filling system has been added to our polishing compound plant in Haan. Furthermore, our production site in Romania has been extended with additional installations.

## Logistics. Always Delivered Quickly.



For us to be able to deliver orders quickly anywhere in the world, we have two advanced logistics warehouses with the corresponding infrastructure, and automated warehousing.

### **nexmart** nexMart

#### **Easy ordering around the clock**

Speedy response and delivery times represent an elementary part of a modern service/customer relationship.

As a retailer, you can order our products using nexMart. It offers the full convenience of an online ordering platform and is now available in many European countries. NexMart is the biggest information source in the industry and allows full order functionality on its platform – whenever and wherever you need it.



#### **AEO Certified.**

##### **For a reliable supply chain**

We are granted the status “Authorized Economic Operator (AEO)”. This is a standard adopted on European level with the goal of rendering possible reliable, end-to-end, international supply chains. The prerequisite for holding the “Authorized Economic Operator” certificate is conformance to special criteria, defined by the customs authorities, in regard to reliability, financial solvency, abiding by legal regulations and meeting safety standards.

The holder of a certificate is regarded as particularly reliable and is granted eased access to legal customs simplifications, accelerated permit procedures and ease in security-related customs checks. The certificates are valid in all EU member states.

You benefit from the fact that higher priority is generally attached to our goods when checks are performed and they are processed quickly. This means shipping delays due to inspections can be minimised greatly

## Power Tools

Angle Grinders .....	13
Power Drills .....	49
High Speed Machines .....	69
Burnishing Machines .....	83
Stationary Machines .....	87

### Technical information & safety information for brushes



#### Working and clamping width of a brush

The working width defines the contact surface between brush and workpiece. To measure the working width, gently press together the trim area. The clamping width is measured between the cover plates. For products without cover plates, the clamping width corresponds to the body width.



#### Working and safety speeds

The maximum safety speed must be observed in line with workplace safety requirements. Information is in the product overview in this catalogue, on the packaging and on the brush itself (see picture). The working speed is defined by factors circumferential speed and brush diameter. The optimum working speed is generally far below the safety speed.



#### Brush diameter and trim length

The diameter of the brush (body of the brush) and the length of the respective trim are the determining factors for the working characteristics of the brush. Generally applicable:

- **Soft, flexible brushes,**  
e.g. for working with textured workpieces and for gentle surface finishing.
- **More aggressive brushes,**  
e.g. for deburring or removing dirt.



#### Optimal positioning of the brush in relation to the workpiece

One of the factors defining the contact pressure of a brush is its penetration depth at the workpiece. Never press a brush into the workpiece and only work with the tips of the filament. Excessive contact pressure lowers the brush performance and expedites wear. For manually operated machines, the recommendation is to only work with the weight of the machine. For an abrasive trim, a filament diameter of 3 times applies, e.g. 1.0 mm penetration depth for a filament diameter of 0.35 mm.

We will be glad to help out if you have questions.



#### Filament density of brushes

The filament density is determined by the number of filament tips per surface unit. High filament densities optimise cutting performance and useful lives (for deburring work for example). Lower filament densities increase the flexibility of the brushes and are the prerequisite for processing strongly profiled surfaces.

For efficient and safe deployment, always select the maximum possible brush diameter that can be fitted on the drive unit.

Because the circumferential speed is defined by the brush diameter, as mentioned above under working speeds, the performance of a brush can also be changed with this factor.

The following table provides an overview:

**Remember the following before fitting a brush:**

- The speed of the drive shaft of your machine must not exceed the maximum safety speed of the brush.
- The length of the drive shaft must fit firmly in the chuck.
- Brushes with clamp shaft can easily be fitted into standard drill chucks or collet chucks.
- The connecting threads of brushes have spanner flats, guaranteeing easy fitting and removal.

RPM min-1	Brush diameters (in mm)											
	20	40	50	80	100	125	150	180	200	250	300	350
800				3.35	4.19	5.23	6.28	7.53	8.37	10.47	12.56	14.75
900			2.35	3.77	4.71	5.88	7.06	8.48	9.41	11.77	14.12	16.47
1,150			3.01	4.81	6.01	7.52	9.02	10.83	12.03	15.04	18.04	21.04
1,200	1.25	2.51	3.14	5.02	6.28	7.85	9.41	11.30	12.55	15.69	18.83	21.97
1,400	1.46	2.93	3.66	5.86	7.32	9.15	10.98	13.18	14.64	18.31	21.97	25.63
1,500	1.57	3.14	3.92	6.28	7.85	9.81	11.77	14.13	15.69	19.61	23.54	27.46
1,800	1.88	3.77	4.71	7.54	9.41	11.77	14.12	16.95	18.83	23.54	28.24	32.95
2,000	2.09	4.19	5.23	8.37	10.26	13.08	15.69	18.84	20.92	26.15	31.38	36.61
2,500	2.62	5.23	6.54	10.47	13.08	16.35	19.61	23.55	26.15	32.67	39.23	45.76
2,800	2.93	5.86	7.32	11.72	14.64	18.31	21.97	26.37	29.29	36.61	43.93	51.25
3,000	3.14	6.28	7.85	12.56	15.69	19.62	23.54	28.26	31.38	39.23	47.07	54.92
3,200	3.35	6.70	8.37	13.40	16.74	20.92	25.10	30.14	33.47	41.84	50.12	58.58
3,500	3.66	7.33	9.15	14.65	18.31	22.89	27.46	32.97	36.61	45.76	54.92	64.07
4,000	4.19	8.37	10.46	16.75	20.92	26.16	31.38	37.68	41.84	52.33	62.76	73.22
4,500	4.70	9.42	11.77	18.84	23.54	29.43	35.30	42.40	47.07	58.84	70.61	82.43
5,000	5.23	10.47	13.08	20.93	26.15	32.70	39.23	47.10	52.33	65.38	78.50	
5,400	5.65	11.30	14.12	22.94	28.24	35.31	42.36	50.67	56.48	70.61	84.78	
6,000	6.28	12.56	15.69	25.12	31.38	39.24	47.07	56.52	62.76	78.50		
7,000	7.33	14.66	18.31	29.31	36.61	45.78	54.92	65.94	73.22	91.58		
8,000	8.37	16.75	20.92	33.94	41.48	52.32	62.76	75.36	83.73			
9,000	9.42	18.84	23.54	37.68	47.07	58.86	70.61	84.78	94.20			
10,000	10.47	20.93	26.17	41.86	52.33	65.40	78.50	94.20				
12,500	13.08	26.17	32.71	52.33	65.42	81.75	98.13					
15,000	15.70	31.40	39.25	62.80								
17,500	18.32	36.63	45.79	73.26								
20,000	20.93	41.87	52.33	83.73								
22,500	23.55	47.10	58.88	94.20								
25,000	26.17	52.33	65.42	104.66								



# Power Tools

## Technical and General Information

### Fill Materials. Types and Usage.

For our tools, we only use filling materials developed in our house or selected specially. Regular quality tests in our R&D labs guarantee highest material quality at all times. Below you find pictures of all the facing materials used for the tools in this catalog. The table shows the properties of all fill materials used by Osborn.



Steel wire

Stainless steel wire

Osborn special steel wire



Cordwire

Brass-coated steel wire

Brass wire

Material	Property	Additional Properties	Benefits	Used on
Steel wire	straight or flat	Most common trim material for brushes	<ul style="list-style-type: none"> <li>Dimensionally stable</li> <li>Diversity of applications</li> </ul>	Steel, cast iron, softwood, hardwood
	crimped			Steel, cast steel
	knotted			
Stainless steel wire	straight	Standard alloys: 1.4310 and 1.4401 (1.4571 on request)	<ul style="list-style-type: none"> <li>Usage in particular where residues of steel wires would adversely affect the surface (such as rust spots)</li> </ul>	Stainless steel, non-ferrous metals, aluminium
	crimped			
	knotted			
Osborn special steel wire	straight		<ul style="list-style-type: none"> <li>High-performance wire with high tensile strength</li> <li>Long service life</li> <li>For extreme brush applications</li> </ul>	Steel, cast iron, softwood, hardwood
	crimped			
	knotted			
XTREME wire (steel wire)	stranded		<ul style="list-style-type: none"> <li>Extremely long life</li> <li>Combines the benefits of crimped and knotted wire</li> </ul>	Steel, cast iron, softwood, hardwood
Brass-coated steel wire	Mono wire	stranded	<ul style="list-style-type: none"> <li>High tensile strength</li> </ul>	Steel, cast iron, softwood, hardwood
	Cordwire		<ul style="list-style-type: none"> <li>Particularly well suited to texturing wood</li> </ul>	
Brass wire	crimped			Non-ferrous metals, softwood



Synthetic bristles

Abrasive bristle

Novofil®

Novoflex-B®

Material	Property	Additional Properties	Benefits	Used on
Synthetic bristles	straight		<ul style="list-style-type: none"> <li>Abrasion-resistant</li> <li>Resistant to weak acids and bases</li> <li>Flexible</li> </ul>	Steel, cast iron, stainless steel, non-ferrous metals, aluminium
Abrasive bristle	Aluminium oxide	Nylon threads with aluminium oxide; <b>red</b> trim material	<ul style="list-style-type: none"> <li>High elasticity without risk of breakage</li> <li>Uniform abrasive effect</li> </ul>	Steel, cast iron, stainless steel, non-ferrous metals, aluminium, wood
	Silicone carbide	Nylon threads with silicone carbide; <b>blue</b> trim material.	<ul style="list-style-type: none"> <li>High elasticity without risk of breakage</li> <li>Uniform abrasive effect</li> </ul>	
	Ceramic, sintered twice	Aluminium oxide sintered twice; available in different hardness grades, light grey trim material	<ul style="list-style-type: none"> <li>Particularly hard and aggressive abrasive grit</li> <li>The abrasive grit released during brushing has a better breaking edge and makes possible faster, more efficient deburring</li> <li>Perfect results through uniform, homogeneous abrasive effect</li> </ul>	Steel, cast iron, stainless steel, non-ferrous metals, aluminium
Novofil®	round	High temperature resistance; available with different hardness, grit and filament thicknesses; abrasive can be made of chromium oxide, silicone carbide, aluminium oxide, zirconium, diamond or nylon resistant to extreme heat.	<ul style="list-style-type: none"> <li>High flexibility and trim density, prolonged life</li> <li>For working with workpieces particular high in contours</li> </ul>	Steel, cast iron, stainless steel, non-ferrous metals, aluminium
	flat		<ul style="list-style-type: none"> <li>Very high abrasive grit content, higher removal rate (approx. 50% lower processing time)</li> <li>Ideal for honing</li> </ul>	
Novoflex-B®	spherical	Trim material with aluminium oxide or silicone carbide; grit sizes from 60 to 400 possible	<ul style="list-style-type: none"> <li>Abrasive balls on flexible design</li> <li>Tool is self-centring</li> </ul>	Steel, cast iron, stainless steel, non-ferrous metals, aluminium



Fibre



Horse hair

Material	Property	Additional Properties	Benefits	Used on
Fibre		Pure plant fibre	<ul style="list-style-type: none"> <li>For wet and dry application</li> <li>Heat-resistant</li> <li>Also suitable for polishing in conjunction with polishing compound</li> </ul>	All materials
Horse hair		Pure horse hair	<ul style="list-style-type: none"> <li>Excellent sealing properties</li> </ul>	

## Angle Grinders

Wheel Brushes .....	16
Cup Brushes .....	21
Bevel Brushes .....	30
Tools for Cordless Machines .....	34
Coarse Cleaning Fleece .....	38
Flap Discs for Grinding .....	39
Flap Discs for Polishing .....	44
Accessoires .....	47

# Angle Grinders

## Technical and General Information

### Brushes for Angle Grinders. Important user information.

#### Determining the maximum working speed

The maximum working speed of a brush is dependent on its diameter. The wider the diameter of a brush, the lower the maximum working speed. The maximum working speed has a relevance to safety. It must never be exceeded. This information is on the brush itself. Additionally you will find below an aid for the most popular angle grinder sizes with their maximum speeds.

Angle grinder size (mm)	115 mm	125mm	150 mm	180 mm	230 mm
Angle grinder size (in)	4 1/2"	5"	6"	7"	9"
Max. working speed	12,500 min <sup>-1</sup>	12,500 min <sup>-1</sup>	8,500 min <sup>-1</sup>	8,500 min <sup>-1</sup>	6,500 min <sup>-1</sup>

#### Which brush is used on which angle grinder?



Not every brush can be fitted to every angle grinder. There are safety specifications for this too. To get the best out of your device and brush, please use the angle grinder sizes specified here for the respective brush (refer to the table).

Important: You must on no account use a smaller angle grinder size than specified here. For our retail packs, the suitable angle grinder size is generally on the packaging itself, with symbol.

Brush	Filament	Brush diameter in mm													
		60	65	75	80	90	100	115	120	125	130	140	150	178	230
Wheel brush	knotted						115	115		125			150	180	230
	crimped						115	115							
	abrasive										150*	150*			
Bevel brush	knotted						115	115		125					
	crimped						115	115							
	abrasive						115*	115/125							
Cup brush	knotted		115/125	125	150		180		230						
	crimped	115/125		125	150		150/180			230			230		
	abrasive		115/125				150*								

\*variable speed angle grinders or cordless angle grinders

## Product Advice for Weld Seam Cleaning

MMA, TIG/MIG/MAG and plasma welding techniques leave different debris and inclusions on the surface of the weld seam. Slag, spatters, silicates and blue discolouring must be removed. If the welded part is not optimally cleaned, faults/defects in the coating and corrosion can occur in the area of the inclusions.

Osborn can offer you the right cleaning tool for every welding technique and type of seam treated (root and closure welds, fill layers). In the product range for this work, we have brushes as well as roughing, flap and polishing flap discs, coarse cleaning fleeces, and carbide cutters.

### MMA

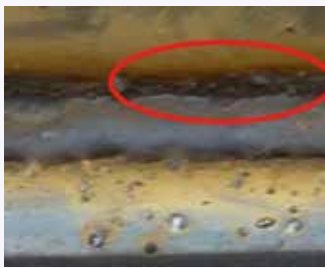

#### Slag

Residue formed when the electrodes wear. Use coarsely knotted wires with a diameter of 0.50 - 0.80 mm to remove slag.

### TIG, MIG, MAG, Plasma



#### Spatters

Abrasive discs are required to grind of these residues.

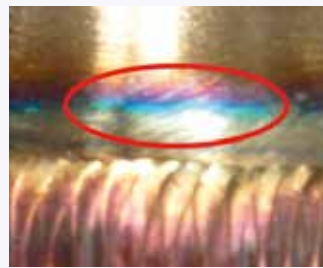

#### Blue discolouration

Oxide deposits, formed mainly when welding stainless steel. Crimped fine stainless steel wires with a diameter of 0.20 - 0.30 mm are ideal for removing blue discolouration.



#### Silicates

They form when silicone, present in most steel alloys, is burnt during the welding process and turn to silicone dioxide. Use a medium wire with a diameter of 0.35 - 0.50 mm to remove silicates.



#### Treatment of Weld Seams. When to use what.

Our practical welding matrix shows you the right tool for every application.

[www.osborn.com/en/service/catalogues](http://www.osborn.com/en/service/catalogues)



# Angle Grinders

## Wheel Brushes



Appearance can vary from picture depending on variant.



EUPBWB001 | SUPERIOR ★★☆☆☆

## Wheel brushes, knotted wire

**Knotted wheel brush, industrial quality, for general use on all common angle grinders.**

- Aggressive and speedy cleaning; all wire tips are in use at the same time
- Long service life
- TÜV-Süd certified (safety tested, production monitored)
- Available in diverse specifications with arbor hole or thread M14

**Application:** For roughing, deburring and simple rust removal work.

Available in practical POS box packaging with Euro-standard hole for ideal presentation at the POS.



∅	A	T	B	G	Adapt.	RPM max.	DU	PKG.	Steel 0.35	Steel 0.50	Steel 0.80
75	12	15	13			20000	12		● 0002-611 131	● 0002-611 151	
100	12	20	22.2		HP	12500	8	POS Box	● 0002-621 131	● 0002-621 151	
115	6	19	22.2			12000	10	POS Box	● 9502-626 301	● 9502-626 501	
115	12	12	22.2		HP	12500	10	POS Box	● 0002-631 131		
115	12	22	22.2		HP	12500	10	POS Box		● 0002-631 151	
115	12	23		M14		12500	6	POS Box	● 0402-631 131	● 0402-631 151	
125	6	24	22.2			12000	8	POS Box	● 9502-626 311	● 9502-626 251	
125	13	28		M14		12500	8	POS Box	● 1402-631 131	● 1402-631 151	
125	13	28	22.2		HP	12500	8	POS Box	● 6152-631 131	● 2202-631 151	
150	13	37	22.2		HP	12000	5	POS Box	● 0002-641 131	● 0002-641 151	● 0002-641 181
178	6	38	22.2			12000	12		● 4602-626 131		
178	13	42	22.2		HP	10000	6	POS Box	● 0002-653 131	● 0002-653 151	● 0002-653 181
230	6	57	22.2			12000	1	POS Box		● 4306-026 904	
230	13	58	22.2		HP	8500	1	POS Box		● 9502-664 151	

∅	A	T	B	G	Adapt.	RPM max.	DU	PKG.	INOX 0.35	INOX 0.50	
100	12	20	22.2		HP	12500	4	POS Box		● 0002-621 351	
115	12	22		M14		12500	4	POS Box	● 0402-631 331		
115	12	23		M14		12500	4	POS Box		● 0402-631 351	
115	12	23	22.2		HP	12500	4	POS Box	● 0002-631 331	● 0002-631 351	
125	6	24	22.2			12000	3	POS Box		● 9502-626 651	
125	13	26		M14		12500	3	POS Box		● 1402-631 351	
125	13	27.5	22.2		HP	12500	3	POS Box		● 2202-631 351	
125	13	28		M14		12500	3	POS Box	● 1402-631 331		
125	13	28	22.2		HP	12500	3	POS Box	● 2202-631 331		
150	13	37	22.2		HP	12000	3	POS Box		● 0002-641 351	
178	6	38	22.2		HP	12000	12		● 4612-626 331		
178	13	42	22.2		HP	10000	3	POS Box		● 0002-653 351	



Appearance can vary from picture depending on variant.



EUPBWB002 | PERFECT ★★☆☆☆

## Wheel brushes, knotted wire

**Knotted wheel brush, quality craftsman quality, for general use on all common angle grinders.**

- Speedy cleaning
- Satisfactory removal rate
- Suitable for many DIY projects

**Application:** For simple deburring and cleaning work.

Available in practical PET packaging with Euro-standard hole for ideal presentation at the POS.



Ø	A	T	B	RPM max.	DU	PKG.	Steel 0.50
115	10	20	22.2	12500	10	POS PET	● 2008-631 151
125	12	27	22.2	12500	12	POS PET	● 2118-631 151



Appearance can vary from picture depending on variant.



EUPBWB003 | SUPERIOR ★★★★★

## Wheel brushes, knotted wire

**Knotted wheel brush with special left/right knotting, industrial quality, for simple fitting on all common angle grinders.**

- Low-vibration and quiet operation
- Prolonged life and high removal rate
- “untwisting” of the knots during use is minimised
- Reduced kick-back
- TÜV-Süd certified (safety tested, production monitored)

**Application:** Deburring, cleaning of weld seams (slag, silicates, blue discolouring), removal of stubborn rust deposits.

Ø	A	T	B	RPM max.	DU	Steel 0.35	Steel 0.50
115	12	23	22.2	12500	10	● 1202-631 131	● 1202-631 151
125	13	28	22.2	12500	8	● 1212-631 131	● 1212-631 151
178	13	42	22.2	10000	6	● 1202-653 131	● 1202-653 151

# Angle Grinders

## Wheel Brushes



Appearance can vary from picture depending on variant.

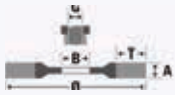

EUPBWB004 | EVOLUTION ★★★★★

## Wheel brushes, knotted Osborn wire

**Knotted wheel brush, high-end quality, for simple fitting on all common angle grinders.**

- High-performance wire developed by Osborn
- Particularly cost-effective
- Long life, high tensile strength, high breaking strain and short set-up times
- Wire ensures the brush is worn uniformly

**Application:** Deburring, cleaning of weld seams (slag, silicates, blue discolouring), removal of stubborn rust deposits.

∅	A	T	B	G	Adapt.	RPM max.	DU	Steel 0.35	Steel 0.50	INOX 0.50
75	13	17	12.7			20000	12	● 9906-026 011		
100	13	22	15.88			18000	12	● 9906-026 116		
100	13	22	15.88		HP	18000	12		● 9906-026 117	
115	6	19	22.2		HP	12500	12		● 2906-026 501	● 0002-626 650
125	6	24	22.2		HP	12000	12		● 0002-626 251	● 0002-626 651
150	6	38		M14		12000	10		● 9906-026 500	
150	6	38	22.2		HP	12000	12		● 9906-026 501	
150	25	38	22.2			12000	12	● 9906-026 247		
165	6	29	22.2		HP	10000	12		● 0002-626 061	
171	6	29	22.2		HP	12000	12		● 9706-026 904	
178	6	38	22.2		HP	12000	12		● 9906-026 051	



Appearance can vary from picture depending on variant.



EUPBWB005 | EVOLUTION ★★★★★

## Wheel brushes, knotted Osborn wire, plastic-bonded

**Plastic-bonded, knotted wheel brush, high-end quality.**

- Reduced wire breakage due to plastic bonding
- Very long service life
- More aggressive cleaning effect than conventional wheel brushes

**Application:** Removal of slag and silicates, suitable for root welds and fill layers, recommended for hand-welded joints with high levels of dirt.

∅	A	T	B	RPM max.	DU	Steel 0.50
115	6	19	22.2	12000	10	● 5402-921 873
125	6	24	22.2	12000	10	● 9802-921 873
178	6	38	22.2	8500	12	● 9802-921 875





Appearance can vary from picture depending on variant.



EUPBWB006 | EVOLUTION ★★★★★

## Wheel brushes, crimped wire, plastic-bonded

**Plastic-bonded, crimped wheel brush, high-end quality.**

- Particularly narrow design for tight joints
- Precision working
- Reduced wire breakage due to plastic bonding
- Lower applied force, lower contact pressure

**Application:** Removal of silicate and weld residues, recommended for root seams welded using TIG/MIG/MAG.

∅	A	T	B	G	RPM max.	DU	Brass Coated Steel 0.38
125	5	32.5		M14	12000	12	● 4102-921 051
152.4	5	29	22.23		8500	12	● 0002-921 874
178	3	41	22.23		8500	1	● 7702-921 875
178	5	41	22.23		8500	12	● 0002-921 875



Appearance can vary from picture depending on variant.



EUPBWB007 | SUPERIOR ★★★★★☆

## Wheel brushes, stranded, crimped wire

**Wheel brush with Cordwire for angle grinders with M14 thread.**

- Brass-coated, stranded steel wire
- Effective woodworking, high friction on soft and hardwood
- TÜV-Süd certified (safety tested, production monitored)

**Application:** Excellently suited to texturing wood. The natural grain of the wood is emphasized and an antique or rustic effect is created. The filaments of the brush ream the softer places of the wood more than the hard ones. So they expose the wood grain and leave a sort of relief surface.

Available in practical POS box packaging with Euro-standard hole for ideal presentation at the POS.

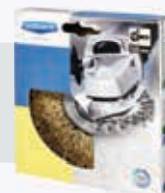

∅	A	T	G	RPM max.	DU	PKG.	Brass Coated Steel 0.27
115	12	27.5	M14	12500	6	POS Box	● 2812-522 051

# Angle Grinders

## Wheel Brushes



Appearance can vary from picture depending on variant.



EUPBWB008 | SUPERIOR ★★★★★

## Wheel brushes, abrasive filament

**Wheel brush for woodworking, with abrasive trim.**

- Suited well to following exactly the material direction for texturing and finishing of wood profiles
- Varying surface patterns possible depending on grit selected
- The low weight of the plastic body ensures it is easy to guide and that work is effortless

**Application:** Removal of lacquer and pickling, cleaning, texturing, finishing and intermediate lacquer sanding.

∅	A	T	G	RPM max.	DU	Novofil NN-S 46	Novofil NN-S 60	Novofil NN-S 80
140	55	30	M14	4500	6	● 5421-401 913	● 5411-401 913	● 5401-401 913



Appearance can vary from picture depending on variant.

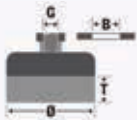

EUPBCB001 | SUPERIOR ★★☆☆☆

## Cup brushes, knotted wire

**Knotted cup brush, industrial quality, for use on angle grinders.**

- General-purpose talent, Osborn bestseller
- Impressive cleaning effect
- Solution of choice for cleaning large surfaces
- Long service life, low set-up costs/time
- TÜV-Süd certified (safety tested, production monitored)

**Application:** Rust removal, paint stripping, removing slag, silicate residuals and blue discolouring.

**3892-608 131** extra long Trim

Available in practical POS box packaging with Euro-standard hole for ideal presentation at the POS.



∅	T	B	G	RPM max.	DU	PKG.	Steel 0.35	Steel 0.50
65	20		M10x1,25	12500	10	POS Box	● 2352-608 131	● 2352-608 151
65	20		M10x1,5	12500	10	POS Box	● 0102-608 131	● 0102-608 151
65	20		M14	12500	10	POS Box	● 0002-608 131	● 0002-608 151
65	20	16		12500	10	POS Box	● 1602-608 131	● 1602-608 151
65	30		M14	12500	10		● 3892-608 131	

∅	T	B	G	RPM max.	DU	PKG.	INOX 0.35	INOX 0.50
65	20		M10x1,25	12500	6	POS Box	● 2352-608 331	
65	20		M10x1,5	12500	6	POS Box	● 0102-608 331	● 0102-608 351
65	20		M14	12500	6	POS Box	● 0002-608 331	● 0002-608 351
65	20	16		12500	6	POS Box	● 1602-608 331	

# Angle Grinders

## Cup Brushes



Appearance can vary from picture depending on variant.

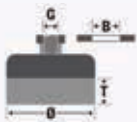

EUPBCB002 | SUPERIOR ★★☆☆☆

## Cup brushes, knotted wire

**Knotted cup brush, industrial quality, for use on angle grinders.**

- Long life, low set-up costs / short set-up times
- Impressive cleaning effect
- Solution of choice for cleaning large surfaces
- Additional stabilisation of the trimming by the support ring
- Support ring is easy to remove. Afterwards the left trim length is useable

**Application:** Rust removal, paint stripping, removing slag, silicate residuals and blue discolouring.

Available in practical POS box packaging with Euro-standard hole for ideal presentation at the POS.



### Did you know?

The support ring is there to stabilise the fill material. After the free filament has worn down, the support ring can be removed, enabling to continue work with the filament material available.

Scan the QR code for video instructions or visit our YouTube channel.



∅	T	G	RPM max.	DU	PKG.	Steel 0.35	Steel 0.50	Steel 0.80
75	20	M14	11000	10	POS Box	● 9908-608 132	● 9908-608 152	
80	20	5/8"	8500	6	POS Box	● 0802-608 133	● 0802-608 153	● 0802-608 183
80	20	M14	8500	6	POS Box	● 0002-608 133	● 0002-608 153	● 0002-608 183
100	20	5/8"	8500	3	POS Box	● 0802-608 134	● 0802-608 154	● 0802-608 184
100	20	M14	8500	3	POS Box	● 0002-608 134	● 0002-608 154	● 0002-608 184
120	20	5/8"	6500	4	POS Box	● 0802-608 135	● 0802-608 155	● 0802-608 185
120	20	M14	6500	4	POS Box	● 0002-608 135	● 0002-608 155	● 0002-608 185

∅	T	G	RPM max.	DU	PKG.	INOX 0.35	INOX 0.50	
80	20	M14	8500	3	POS Box	● 0002-608 333	● 0002-608 353	
100	20	M14	8500	3	POS Box	● 0002-608 334	● 0002-608 354	



Appearance can vary from picture depending on variant.

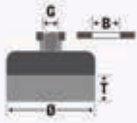

EUPBCB003 | EVOLUTION ★★★★★

## Cup brushes, knotted wire

**Knotted cup brush, high-end quality, for use on angle grinders.**

- High-performance wire developed by Osborn
- Particularly cost-effective
- Long life, high tensile strength, high breaking strain and short set-up times
- Special feature: individual knot ends are slightly open, so that the wire tips are in use immediately and directly
- Higher removal rate, aggressive cleaning performance

**Application:** Paint/rust removal, deburring, descaling, removal of slag, silicate residues and blue discoloration, cleaning of fill layers and surfaces in the oil and gas industries.

ø	T	G	DU	Steel 0.50
90	32	5/8"	6	● 9906-033 126
90	32	M14	6	● 9906-033 125



Appearance can vary from picture depending on variant.

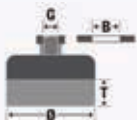

EUPBCB004 | PERFECT ★★★☆☆

## Cup brushes, knotted wire

**Knotted cup brush, craftsman quality, for use on angle grinders.**

- Osborn bestseller in the DIY sector
- Good cleaning performance
- Best price/performance ratio
- Easy cleaning of larger areas

**Application:** Paint/rust removal, removal of slag.

Available in practical PET packaging with Euro-standard hole for ideal presentation at the POS.



ø	T	G	RPM max.	DU	PKG.	Steel 0.35	Steel 0.50
65	20	M14	12500	10	POS PET	● 2008-608 131	● 2008-608 151
75	27	M14	11000	10	POS PET		● 2008-608 152
80	22	M14	8500	10	POS PET		● 2008-608 153
100	22	M14	8500	5	POS PET		● 2008-608 154

# Angle Grinders

## Cup Brushes



Appearance can vary from picture depending on variant.

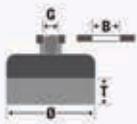

EUPBCB005 | SUPERIOR ★★☆☆☆

## Cup brushes, crimped wire

**Crimped cup brush, industrial quality, for use on angle grinders.**

- Flexible trim material that adapts perfectly to the workpiece contour
- The optimum angle for the brush to operate at is already specified by the trim shape of the brush
- TÜV-Süd certified (safety tested, production monitored)

**Application:** Cleaning, removal of paint, rust, slag, blue discolouration.

Available in practical POS box packaging with Euro-standard hole for ideal presentation at the POS.



ø	T	G	B	RPM max.	DU	PKG.	Steel 0.20	Steel 0.30
60	21	M10x1,5		12500	10	POS Box		● 0102-613 161
60	21	M14		12500	10	POS Box	● 0002-613 141	● 0002-613 161
75	23		16	12500	10	POS Box		● 1602-613 162
75	23	5/8"		12500	10	POS Box	● 0802-613 142	● 0802-613 162
75	23	M10x1,25		12500	10	POS Box	● 5652-613 142	
75	23	M10x1,5		12500	10	POS Box	● 0102-613 142	● 0102-613 162
75	23	M14		12500	10	POS Box	● 0002-613 142	
75	25	M14		12500	10	POS Box		● 0002-613 162

ø	T	G	B	RPM max.	DU	PKG.	INOX 0.30	Brass 0.30
60	21		16	12500	4	POS Box	● 1602-613 361	
60	21	M10x1,25		12500	10	POS Box		● 4912-613 561
60	21	M14		12500	4	POS Box	● 0002-613 361	
60	21	M14		12500	10	POS Box		● 4902-613 561
75	23	5/8"		12500	4	POS Box	● 0802-613 362	
75	25	M14		12500	10	POS Box	● 0002-613 362	● 4902-613 562



Appearance can vary from picture depending on variant.

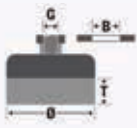

EUPBCB006 | SUPERIOR ★★☆☆☆

## Cup brushes, crimped wire

**Crimped cup brush, industrial quality, for use on angle grinders.**

- Flexible trim material that adapts perfectly to the workpiece contour
- The optimum angle for the brush to operate is already specified by the trim shape of the brush
- TÜV-Süd certified (safety tested, production monitored)

**Application:** Cleaning, removal of paint, rust, slag, blue discoloration.

Available in practical POS box packaging with Euro-standard hole for ideal presentation at the POS.



ø	T	G	RPM max.	DU	PKG.	Steel 0.20	Steel 0.30	Steel 0.50
80	25	M14	8500	5	POS Box	● 0002-613 143	● 0002-613 163	● 0002-613 193
100	30	5/8"	8500	3	POS Box	● 0802-613 144	● 0802-613 164	● 0802-613 194
100	30	M14	8500	3	POS Box	● 0002-613 144		● 0002-613 194
100	30	M14	8500	4	POS Box		● 0002-613 164	
125	30	5/8"	6500	4	POS Box		● 0802-613 165	● 0802-613 195
125	30	M14	6500	4	POS Box	● 0002-613 145	● 0002-613 165	
125	35	M14	6500	4	POS Box			● 0002-613 195
150	40	5/8"	4500	3	POS Box		● 0802-613 166	● 0802-613 196
150	40	M14	4500	3	POS Box	● 0002-613 146	● 0002-613 166	● 0002-613 196

ø	T	G	RPM max.	DU	PKG.	INOX 0.30	Brass 0.30	
80	25	5/8"	8500	4	POS Box	● 0802-613 363		
80	25	M14	8500	4	POS Box	● 0002-613 363		
80	25	M14	8500	5	POS Box		● 4902-613 563	
100	25	M14	8500	3	POS Box	● 0002-613 364		
100	30	5/8"	8500	3	POS Box	● 0802-613 364		
125	30	M14	6500	2	POS Box	● 0002-613 365		

# Angle Grinders

## Cup Brushes



Appearance can vary from picture depending on variant.

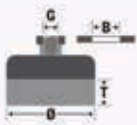

EUPBCB007 | PERFECT ★★☆☆☆

## Cup brushes, crimped wire

**Crimped cup brush, craftsman quality, for use on angle grinders.**

- Osborn bestseller in the DIY sector
- Flexible trim material that adapts perfectly to the workpiece contour
- Good cleaning performance
- Best price/performance ratio

**Application:** Paint stripping and rust removal from surfaces.

Available in practical PET packaging with Euro-standard hole for ideal presentation at the POS.



ø	T	G	RPM max.	DU	PKG.	Steel 0.30	Brass Coated Steel 0.30
60	18	M14	12500	10	POS PET	● 2008-613 161	● 2008-613 061
75	25	M14	12500	10	POS PET	● 2008-613 162	● 2008-613 062
80	25	M14	8500	10	POS PET	● 2008-613 163	● 2008-613 063
100	25	M14	8500	5	POS PET	● 2008-613 164	● 2008-613 064
125	30	M14	6500	5	POS PET	● 2008-613 165	● 2008-613 065





Appearance can vary from picture depending on variant.

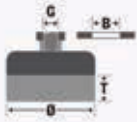

EUPBCB008 | XTREME ★★★★★

## Cup brushes, crimped Xtreme wire

**Crimped cup brush with stranded, special Xtreme wire for use on angle grinders.**

- Four times longer service life than common, crimped cup brushes, Highest removal rate in this segment
- Risks of wire breaks low to none, Ergonomic, low contact pressure necessary
- Effective cleaning performance, Creates a uniform, almost satin surface finish
- Combines the aggressive cleaning performance of knotted brushes with the flexibility of soft, crimped brushes
- TÜV-Süd certified (safety tested, production monitored)

**Application:** Deburring, edge rounding, removal of rust, paint, scales, slag, silicate residues and blue discolouration.

Available in practical POS box packaging with Euro-standard hole for ideal presentation at the POS.



∅	T	G	RPM max.	DU	PKG.	Steel 0.30
60	20	M14	12500	10	POS Box	● 3902-613 161
75	25	M14	12500	10	POS Box	● 3912-613 163
80	25	M14	12500	5	POS Box	● 3902-613 163
100	22	M14	8500	4	POS Box	● 3902-613 164

# Angle Grinders

## Cup Brushes



Appearance can vary from picture depending on variant.

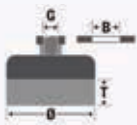

EUPBCB009 | SUPERIOR ★★☆☆☆

### Cup brushes, arbor hole, abrasive filament

**Cup brush with abrasive trim, industrial quality, for use on angle grinders.**

- Powerful high-tech material
- Pinpoint, controlled application on surfaces
- Very flexible trim material; If individual filaments lie flat during use, continue working with the edge nevertheless because the length of the trim material has end-to-end abrasive grit
- Different grits are available for selection: the higher the grit size, the finer the surface pattern

**Application:** Paint removal, deburring and cleaning of metal and wooden surfaces.

ø	T	B	G	RPM max.	DU	Novofil NN-S 80	Novofil NN-S 120	Novofil NN-S 180
100	25	22.2		8500	3	● 8812-607 914	● 2312-607 914	● 1802-607 914



Appearance can vary from picture depending on variant.

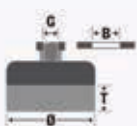

EUPBCB010 | SUPERIOR ★★☆☆☆

### Cup brushes, abrasive filament

**Punched disc brush with abrasive trim material for woodworking, for use on angle grinders with adjustable speed.**

- For use on large surfaces
- Varying surface pattern possible depending on grit selected
- The low weight of the plastic body ensures it is easy to guide and that work is effortless

**Application:** Particularly well suited for removing lacquer and stains, for cleaning, texturing, finishing and intermediate lacquer sanding.

- 9301-614 916** Grit 46 – For creating a depth texture in the wood
- 9311-614 916** Grit 60 – For removing minor to medium levels of dirt, and uniform texturing of the wood
- 9321-614 916** Grit 80 – Preparation before finishing, evens out minor surface irregularities
- 9331-614 916** Korn 120 – Erzeugung des finalen Schriff auf der Holzoberfläche

A	T	G	RPM max.	DU	Novofil NN-S 46	Novofil NN-S 60	Novofil NN-S 80	Novofil NN-S 120
130	50	M14	2500	4	● 9301-614 916	● 9311-614 916	● 9321-614 916	● 9331-614 916



Appearance can vary from picture depending on variant.

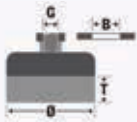

EUPBCB011 | SUPERIOR ★★☆☆☆

## Cup brushes, abrasive filament

Cup brush with abrasive Novofil® trim material, industrial quality, for use on angle grinders.

- Long service life
- Low set-up costs / short set-up times
- For effortless and efficient working

**Application:** Very well suited to treating vertical surfaces and walls made of assembled flat or round wood elements.

- 7902-613 196** Grit 46 – For creating a depth texture in the wood
- 7922-613 196** Grit 60 – For removing minor to medium levels of dirt, and uniform texturing of the wood
- 7932-613 196** Grit 80 – Preparation before finishing, evens out minor surface irregularities
- 7942-613 196** Grit 120 – Creation of the final finish on the wood surface

ø	T	G	RPM max.	DU	Novofil NH-S 46	Novofil NH-S 60	Novofil NH-S 80	Novofil NN-S 120
150	25	M14	8500	2	● 7902-613 196	● 7922-613 196	● 7932-613 196	● 7942-613 196

# Angle Grinders

## Bevel Brushes



Appearance can vary from picture depending on variant.



EUPBBB001 | SUPERIOR ★★★★★

## Bevel brushes, twist knot wire

**Knotted bevel brush, industrial quality, for use on angle grinders.**

- Aggressive cleaning performance
- Long service life
- Combines the best properties of a cup brush with those of a wheel brush
- Workpieces with large areas and difficult to access places can be treated perfectly
- TÜV-Süd certified (safety tested, production monitored)

**Application:** Deburring, removal of rust, paint, slag, silicates and blue discoloration on complex workpieces.

Available in practical POS box packaging with Euro-standard hole for ideal presentation at the POS.



∅	A	T	G	Knots	RPM max.	DU	PKG.	Steel 0.35	Steel 0.50
100	13	22	M10x1,25	18	12500	10	POS Box	● 4802-622 131	● 2352-622 151
100	13	22	M10x1,5	18	12500	10	POS Box	● 0102-622 131	● 0102-622 151
100	13	22	M14	18	12500	10	POS Box	● 0002-622 131	● 0002-622 151
100	13	22	M14	22	12500	10	POS Box	● 0002-623 131	
115	15	20	5/8"	18	12500	10	POS Box	● 0802-632 131	● 0802-632 151
115	15	20	M14	18	12500	10	POS Box	● 0002-632 131	● 0002-632 151
125	15	23	M14	24	12500	10	POS Box	● 3602-632 131	● 2902-632 151

∅	A	T	G	Knots	RPM max.	DU	PKG.	INOX 0.35	INOX 0.50
100	13	22	M10x1,25	18	12500	10	POS Box	● 4802-622 331	● 2352-622 351
100	13	22	M10x1,5	18	12500	10	POS Box	● 0102-622 331	● 0102-622 351
100	13	22	M14	18	12500	10	POS Box	● 0002-622 331	● 0002-622 351
115	15	20	M14	18	12500	5	POS Box	● 0002-632 331	
115	15	20	M14	18	12500	10	POS Box		● 0002-632 351
125	15	23	M14	24	12500	10	POS Box	● 3602-632 331	● 3602-632 351



Appearance can vary from picture depending on variant.



EUPBBB002 | PERFECT ★★☆☆☆

## Bevel brushes, twist knot wire

**Knotted bevel brush, craftsman quality, for use on angle grinders.**

- Good cleaning performance and service life
- Best price/performance ratio
- Processing of large surfaces and hard to reach areas

**Application:** Rust removal, paint stripping, deburring.

Available in practical PET packaging with Euro-standard hole for ideal presentation at the POS.



∅	A	T	G	RPM max.	DU	PKG.	Steel 0.50
100	13	22	M14	12500	8	POS PET	● 2008-622 151

# Angle Grinders

## Bevel Brushes



Appearance can vary from picture depending on variant.



EUPBBB003 | SUPERIOR ★★★★★

## Bevel brushes, crimped wire

**Crimped bevel brush, industrial quality, for use on angle grinders.**

- Flexible trim material, adjusts perfectly to the workpiece
- The longer the trim material, the more flexible the brush. Combines the best properties of a cup brush with those of a wheel brush
- Processing of large surfaces and hard to reach areas
- Depending on the workpiece geometry, the brush is available in different working widths guaranteeing pinpoint deployment
- TÜV-Süd certified (safety tested, production monitored)

**Application:** Rust removal, paint stripping, deburring, silicates.

Ø	A	T	G	RPM max.	DU	Steel 0.30	INOX 0.20
100	10	20	M10x1,25	12500	10	● 2352-512 161	
100	10	20	M10x1,5	12500	10	● 0102-512 161	
100	10	20	M14	12500	10	● 0002-512 161	
100	20	20	M10x1,25	12500	10		● 2352-512 342
100	20	20	M10x1,5	12500	10	● 0102-512 162	● 0102-512 342
100	20	20	M14	12500	10	● 0002-512 162	● 0002-512 342
125	10	25	M14	12500	10	● 0002-514 161	

Ø	A	T	G	RPM max.	DU	INOX 0.30	Brass Coated Steel 0.30
100	10	20	M14	12500	10	● 0002-512 361	● 0002-512 061
100	20	20	M10x1,25	12500	10	● 2352-512 362	
100	20	20	M10x1,5	12500	10	● 0102-512 362	
100	20	20	M14	12500	10	● 0002-512 362	● 0002-512 062
125	10	25	M14	12500	10	● 0002-514 361	



Appearance can vary from picture depending on variant.



EUPBBB004 | PERFECT ★★☆☆☆

## Bevel brushes, crimped wire

**Crimped bevel brush, craftsman quality, for use on angle grinders.**

- Ideal for processing areas and surfaces difficult to access
- Suitable for easy to semi-difficult cleaning work
- Best price/performance ratio

**Application:** Edge rounding, paint/rust removal.

Available in practical PET packaging with Euro-standard hole for ideal presentation at the POS.



∅	A	T	G	RPM max.	DU	PKG.	Steel 0.30	Brass Coated Steel 0.30
100	10	20	M14	12500	10	POS PET		● 2008-512 061
100	16	20	M14	12500	10	POS PET	● 2008-512 161	



Appearance can vary from picture depending on variant.



EUPBBB006 | XTREME ★★★★★★

## Bevel brushes, Xtreme Wire, crimped

**Bevel Brush with crimped Xtreme wire in high-end quality for use on angle grinders.**

- Up to 8 times longer service life than conventional crimped wire brushes
- Flexible Xtreme wire, adjusts perfectly to the workpiece
- Combines the best properties of a cup brush with those of a wheel brush
- Processing of large surfaces and hard to reach areas
- Low vibration, low noise, unique satin finish

**Application:** Derusting, paint stripping, deburring, removal of silicates

∅	A	T	G	RPM max.	DU	Steel 0.30
100	10	20	M14	12500	10	● 3902-512 161

# Angle Grinders

## Technical and General Information



### Cordless is King.

More power, longer runtimes and all wireless. These are the new generations of cordless tools that make it easy to work wherever there is no power socket. The battery runtimes and performance of the tools have made a quantum leap in the last years. This makes them interesting for more and more users. Particularly in the construction industry, in sanitary and heating construction, caretakers, but also fire brigades, road maintenance and other mobile helpers, the devices are now indispensable without electricity.

**Important:** Please note that our cordless power tool accessories are also suitable for variable-speed angle grinders



### Why special tools?

Cordless power tools are commonly used by mobile services, where the full range of accessories is not available. Users therefore need universal tools which can tackle a variety of tasks on different materials.

In this way the amount of accessories to be carried along on a construction site can be reduced when working on steel, stainless steel and wood.

Commonly cordless angle grinders run with a 30 % reduced working speed compared to usual angle grinders. Having specifically developed accessories for common cordless power tools means that the perfect result of brushes can be reached with a speed of 7,000 to 8,000 RPM.

Osborn Brushes are lighter and therefore prolong the battery life between recharges by 20-25 %.

### We make it easy for you!

Osborn has developed tools which are flexible in use, light weight, easy to handle and assure highest precision. The end result will meet all your expectations and fulfill all aspects of work safety. This is the only way to work effectively and get the best out of your cordless power tool.

### Benefits

- Low weight
- Precision working
- Multifunctional
- Ease of use
- Reduced imbalance and vibration
- Longer battery life (by 20 to 25 %)
- Fewer charging cycles
- Universal usage on all materials

### Good to know

Refer to the respective sections for the grinding and polishing products that are suitable for use on battery-operated angle grinders.





Appearance can vary from picture depending on variant.

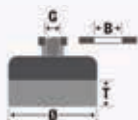

EUPBCB012 | SUPERIOR ★★☆☆☆

## Cup brushes, crimped wire

**Crimped cup brush, industrial quality, for use on cordless angle grinders and variable-speed angle grinders.**

- Low weight
- Extended battery life
- Multifunctional
- reduced imbalance and vibration
- TÜV-Süd certified

**Application:** Cleaning, satin finishing, smoothing and texturing of different materials.

Available in practical PET packaging with Euro-standard hole for ideal presentation at the POS.



ø	T	G	RPM max.	DU	PKG.	Brass 0.30
60	21	M14	12500	5	POS PET	● 6912-613 561

# Angle Grinders

Tools for Cordless Machines



Appearance can vary from picture depending on variant.

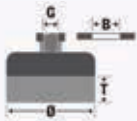

EUPBCB013 | SUPERIOR ★★☆☆☆

## Cup brushes, abrasive filament

Cup brush with abrasive trim material, industrial quality, for use on cordless angle grinders and variable-speed angle grinders.

- Weight-optimised
- TÜV-Süd certified
- Very flexible trim material; If individual filaments lie flat during use, continue working with the edge nevertheless because the length of the trim material has end-to-end abrasive grit
- Extended battery life
- reduced imbalance and vibration

**Application:** Cleaning, satin finishing, smoothing and texturing of different materials.

Available in practical PET packaging with Euro-standard hole for ideal presentation at the POS.



∅	T	G	∅ Fill	RPM max.	DU	PKG.	Novofil NH-S 46
60	21	M14	1.6	12500	5	POS PET	● 6912-613 891



Appearance can vary from picture depending on variant.



EUPBBB005 | SUPERIOR ★★☆☆☆

## Bevel brushes, abrasive filament

Bevel brush with abrasive trim material Novofil NH-S, industrial quality, for use on cordless angle grinders and variable-speed angle grinders.

- Weight-optimised
- TÜV-Süd certified
- Extended battery life
- This means workpieces with large areas and difficult to access places can be treated perfectly
- Reduced imbalance and vibration

**Application:** Weld seam finishing for TIG/MIG/MAG, paint removal, cleaning, texturing, deburring.

Available in practical PET packaging with Euro-standard hole for ideal presentation at the POS.



∅	A	T	G	∅ Fill	RPM max.	DU	PKG.	Novofil NH-S 46
100	10	20	M14	1.6	12500	5	POS PET	● 6912-622 891

# Angle Grinders

## Coarse Cleaning Fleece



Appearance can vary from picture depending on variant.



EUGMCF009 | SUPERIOR ★★☆☆☆

## Coarse cleaning fleece for angle grinders

Coarse cleaning fleece on glass fibre backing. Suitable for cleaning and polishing all surfaces. Cleaning fleeces attain the best results in sanding and cleaning metals, stainless steel, wood and plastic, and can be used as a preliminary stage before polishing. They are made of intertwined nylon fibres which are immersed in synthetic resin and gently hardened. They are available with a glass fibre backing or for the use with straight or cylindrical grinders.

- Removes old paint, rust and weld spots without scratching the surface of the workpiece
- Cleaning and smoothing wood and plastic

**Application:** General-purpose use for metals, stainless steel, wood and plastic.

**Please note:** Coarse cleaning fleeces are not suitable for edge finishing. They remove foreign matter and are non-stock removing.

∅	B	RPM max.	DU	flat
115	22.23	11000	10	● 6700-001 100
125	22.23	10000	10	● 6700-002 100
180	22.23	8500	10	● 6700-003 100



Appearance can vary from picture depending on variant.

EUGMFD001 | PERFECT ★★☆☆☆

## ALOX POWER

Cost-effective product for processing steel and wood. A tough, hard abrasive grain enables good removal rates, particularly when grinding surfaces. The glass fibre backing is characterised by an even grinding finish until the abrasive grain is completely consumed. No scratches appear on the workpiece.

- Quick machining
- Fine surface structure
- Good lifetime

**Application:** Very suitable for processing unalloyed steel, alloyed steel and tool steel. Also suitable for weldseams, wood and plastic.

∅	B	RPM max.	DU	flat 40	flat 60	flat 80	flat 120
115	22.23	13300	10	● 5231-004 100	● 5231-006 100	● 5231-007 100	● 5231-009 100
125	22.23	12250	10	● 5232-004 100	● 5232-006 100	● 5232-007 100	● 5232-009 100

∅	B	RPM max.	DU	tapered 40	tapered 60	tapered 80	
115	22.23	13300	10	● 5231-204 100	● 5231-206 100	● 5231-207 100	
125	22.23	12250	10	● 5232-204 100	● 5232-206 100	● 5232-207 100	

# Angle Grinders

## Flap Discs for Grinding



Appearance can vary from picture depending on variant.

EUGMFD003 | PERFECT ★★☆☆☆

## ZIRCON POWER

**All-round flap disc with zirconium corundum band on a cotton polyester cloth. Good removal rate and service life.**

- Ideal for surface grinding on steel and stainless steel
- High removal rate and effortless work without clogging
- The glass fibre backing is characterised by an even grinding finish until the abrasive grain is completely consumed. No scratches appear on the workpiece.

**Application:** Very suitable for processing stainless steel, (un)alloyed steel, weldseams, cast. Also suitable for wood and plastic.

∅	B	RPM max.	DU	flat 40	flat 60	flat 80
115	22.23	13300	10	● 5231-184 100	● 5231-186 100	● 5231-187 100
125	22.23	12250	10	● 5232-184 100	● 5232-186 100	● 5232-187 100

∅	B	RPM max.	DU	tapered 40	tapered 60	tapered 80
115	22.23	13300	10	● 5231-384 100	● 5231-386 100	● 5231-387 100
125	22.23	12250	10	● 5232-384 100	● 5232-386 100	● 5232-387 100



Appearance can vary from picture depending on variant.

EUGMFD006 | SUPERIOR ★★☆☆☆

## ZIRCON PLUS

**Top-quality zirconium flap disc. Well-suited for deburring, processing welding seams and surface grinding. Very balanced and universally applicable flap disc with brilliant removal rate and outstanding service life. For processing steel and stainless steel. A true four-star all-round disc.**

- Ideal for processing edges
- Also very good for surface grinding
- Outstanding grinding performance with superior lifetime
- High removal rate and effortless work without clogging
- Very good surface quality on workpiece

**Application:** Suits perfectly for (stainless) steel sheets and cast. Very suitable for (un)alloyed steel and weldseams. Also suitable for wood and plastic.

∅	B	RPM max.	DU	flat 40	flat 60	flat 80
115	22.23	13300	10	● 5241-104 100	● 5241-106 100	● 5241-107 100
125	22.23	12250	10	● 5242-104 100	● 5242-106 100	● 5242-107 100

∅	B	RPM max.	DU	tapered 40	tapered 60	tapered 80
115	22.23	13300	10	● 5241-304 100	● 5241-306 100	● 5241-307 100
125	22.23	12250	10	● 5242-304 100	● 5242-306 100	● 5242-307 100

# Angle Grinders

## Flap Discs for Grinding



Appearance can vary from picture depending on variant.

EUGMFD007 | SUPERIOR ★★★★★

### ZIRCON PRIME G-AZ

**Special flap disc with zirconium corundum. This abrasive grain cloth is less hard, but very tough, and gives the disc very good all purpose characteristics.**

- Robust abrasive belt for high demands
- Brilliant grinding capacity
- Outstanding service
- It is used for such demanding operations as deburring, machining welding seams and breaking edges
- The glass fibre backing is characterised by an even grinding finish until all of the abrasive grain has been worn away. Leaves no scratches on the workpiece

**Application:** Suits perfectly for (stainless) steel sheets and cast. Very suitable for (un)alloyed steel and weldseams. Also suitable for wood and plastic.

∅	B	RPM max.	DU	flat 40	flat 60	flat 80	flat 120
115	22.23	13300	10	● 5211-104 100	● 5211-106 100	● 5211-107 100	● 5211-109 100
125	22.23	12250	10	● 5212-104 100	● 5212-106 100	● 5212-107 100	● 5212-109 100

∅	B	RPM max.	DU	tapered 40	tapered 60	tapered 80
115	22.23	13300	10	● 5211-304 100	● 5211-306 100	● 5211-307 100
125	22.23	12200	10		● 5212-306 100	
125	22.23	12250	10	● 5212-304 100		● 5212-307 100





Appearance can vary from picture depending on variant.

EUGMFD011 | SUPERIOR ★★☆☆☆

## CERA PLUS

Flap disc with self-sharpening ceramic grain, which permanently enables an extremely high removal rate and guarantees a long service life. Outstanding results for surface and edge grinding of steel or stainless steel. The robust polyester backing and a full resin bond with additives that actively support grinding guarantee that the abrasive grain on the backing remains resistant to wear, even under high stress. This makes CERA PLUS ideal for extreme grinding work or demanding special tasks.

- Extremely aggressive removal rate with a minimum of effort
- Substantial time savings, clear plus in terms of service life
- Highly resilient
- Self-sharpening
- Cool grinding on surfaces and edges, reduces thermal discolouration on the workpiece

**Application:** Suits perfectly for high alloy steel, titanium alloys, nickel-base alloys, chrome and chrome-nickel-steel. Very suitable for brass, bronze and cast.

∅	B	RPM max.	DU	flat 40	flat 60	flat 80
115	22.23	13300	10	● 5241-434 100	● 5241-436 100	● 5241-437 100
125	22.23	12250	10	● 5242-434 100	● 5242-436 100	● 5242-437 100

∅	B	RPM max.	DU	tapered 40	tapered 60	tapered 80
115	22.23	13300	10	● 5241-444 100	● 5241-446 100	● 5241-447 100
125	22.23	12250	10	● 5242-444 100	● 5242-446 100	● 5242-447 100

# Angle Grinders

Technical and General Information

## Efficient Solutions for Surface Processing.



Osborn polishing flap discs deliver outstanding results for the processing of stainless steel, steel, aluminium and non-ferrous metals thanks to an innovative, highly effective grinding fleece arranged in a fan-shaped lamella structure.

- **Highly effective for welding technology and metal processing applications**  
Delivers optimal results, for example when preparing welding seams, reworking welding seams and removing weld spatter in accordance with EN ISO 5817. Removes oxide films and thermal discolouration after the welding of pipelines, containers and apparatuses or after the plasma cutting of stainless steel sheets in accordance with DIN 50930, DIN 25410 and DVGW W541.
- **Highly effective for painting technology applications**  
Ideal for derusting, paint stripping and preparing surfaces for painting.
- **Extremely versatile**  
For cleaning and polishing unalloyed steel, high alloy steel, aluminium and non-ferrous metals. Suitable for edge and surface grinding.



Surfaces descaled prior to welding result in clean welding seams (see image at left)



Quick, professional derusting and descaling



Sanding fine welding seams and removing thermal discolouration



Appearance can vary from picture depending on variant.

EUGMFD013 | SUPERIOR ★★☆☆☆

## Polimaxx 1 - coarse

**Fleece flap disc with coarse fleece texture (slight machining effect).**

- For descaling and derusting workpieces, preparing welding seams, smoothing welding seam flaking, sanding very fine welding seams, removing weld spatters.
- Polimaxx 1 flap discs are also available in sets with Polimaxx 2 and 3 discs.

**Application:** Universally applicable for stainless steel, steel, aluminium and non-ferrous metals.

∅	B	RPM max.	DU	flat
115	22.23	13300	10	● 5541-204 100
125	22.23	12250	10	● 5542-204 100



Appearance can vary from picture depending on variant.

EUGMFD014 | SUPERIOR ★★☆☆☆

## Polimaxx 2 - medium

**Fleece flap disc with medium fleece texture (no machining effect).**

- For descaling and derusting workpieces, removing paints and varnishes, preparing surfaces for painting, matting of V2A welding seams or surfaces. Removing oxide films and thermal discolouration.
- Polimaxx 2 flap discs are also available in sets with Polimaxx 1 and 3 discs.

**Application:** Universally applicable for stainless steel, steel, aluminium and non-ferrous metals.

∅	B	RPM max.	DU	flat
115	22.23	13300	10	● 5541-206 100
125	22.23	12250	10	● 5542-206 100

# Angle Grinders

## Flap Discs for Polishing



Appearance can vary from picture depending on variant.



EUGMFD015 | SUPERIOR ★★☆☆☆

### Polimaxx 3 - fine

**Fleece flap disc with fine fleece texture (no machining effect).**

- For preparing and re-polishing welding seams, sanding fine welding seams, matting of surfaces, removing oxide films, thermal discolouration or thin layers of varnish on metals, polishing stainless steel.
- Polimaxx 4 for mirror finishes available.
- Polimaxx 3 flap discs are also available in sets with Polimaxx 1 and 2 discs.

**Application:** Universally applicable for stainless steel, steel, aluminium and non-ferrous metals.

∅	B	RPM max.	DU	flat
115	22.23	13300	10	● 5541-207 100
125	22.23	12250	10	● 5542-207 100



Appearance can vary from picture depending on variant.



EUPOBU001 | SUPERIOR ★★☆☆☆

### Polimaxx 4 - gloss

**The gloss polishing flap disc for angle grinders is equipped with lamellas made of a special high-quality felt.**

- Please use with polishing compounds
- Gives a mirror finish

**Application:** Universally applicable for stainless steel, steel, aluminium and non-ferrous metals.

∅	B	RPM max.	DU	tapered
115	22.23	13300	10	● 5541-220 100
125	22.23	12250	10	● 5542-220 100



EUACAD008

## Reducing Ring "HP-Adapter"

Reducing Rings provide a reliable solution for precisely adapting standard bore sizes to smaller diameters.

Appearance can vary from picture depending on variant.

adapt. from	adapt. to	DU	Item Number
16.00	9.50	1	● 0003-000 222
16.00	12.70	1	● 0003-000 223
22.20	9.50	1	● 0003-000 242
22.20	12.70	1	● 0003-000 243
22.20	16.00	1	● 0003-000 244

## Power Drills

Wheel Brushes .....	50
Cup Brushes .....	56
End Brushes .....	60
Flap Wheel Brushes .....	65
Kits .....	66
Accessories .....	67

# Power Drills

## Wheel Brushes



Appearance can vary from picture depending on variant.

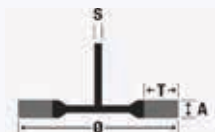

EUPBWB009 | SUPERIOR ★★☆☆☆

## Wheel brushes, knotted wire

**Knotted wheel brush, industrial quality, for use on power drills and high-speed machines.**

- Osborn bestseller
- High cleaning performance
- 6 mm shaft enables simple mounting
- Also suitable for use on high-speed machines
- TÜV-Süd certified (safety tested, production monitored)

**Application:** Cleaning, deburring, removal of slag and silicates, weld seam finishing, removal of protective undercoating in car workshops.

Available on a practical display card with Eurostandard hole for ideal presentation at the POS.



Ø	A	T	S	RPM max.	PKG.	DU	Steel 0.35	Steel 0.50	INOX 0.50
75	8	18	6	20000	POS Card	8		● 7202-611 151	
75	12	15.5	6	20000		12		● 0202-611 151	
75	12	18	6	20000		12	● 0202-611 131		● 0202-611 351
75	12	18	6	20000	POS Card	8			● 7012-611 351



Appearance can vary from picture depending on variant.

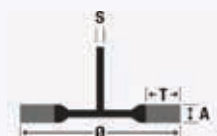

EUPBWB010 | SUPERIOR ★★☆☆☆

## Wheel brushes, crimped wire

**Crimped wheel brush, industrial quality, for use on power drills and high-speed machines.**

- Thanks to a number of selectable trim materials and brush diameters there is a brush for every application
- Small brush diameter enables access to difficult to reached places
- Also suitable for use on high-speed machines
- TÜV-Süd certified (safety tested, production monitored)

**Application:** Edge honing, finishing bores, deburring and minor cleaning work.

Available on a practical display card with Eurostandard hole for ideal presentation at the POS.



Ø	A	T	S	RPM max.	DU	PKG.	Steel 0.15	Steel 0.20	Steel 0.30
20	6	4	6	20000	10		● 0002-501 132	● 0002-501 142	
20	9	4	6	20000	10			● 0002-501 143	
30	6	6	6	20000	10			● 0002-502 141	
30	9	6	6	20000	10		● 0002-502 132	● 0002-502 142	
30	12	6	6	20000	10			● 0002-502 143	
40	7	10	6	18000	10			● 0002-503 141	
40	11	10	6	18000	8	POS Card		● 7002-503 142	
40	11	10	6	18000	10		● 0002-503 132	● 0002-503 142	
40	16	10	6	18000	10			● 0002-503 143	
50	10	13	6	15000	10			● 0002-504 141	● 0002-504 161
50	17	13	6	15000	6	POS Card		● 7602-504 142	
50	17	13	6	15000	10		● 0002-504 132	● 0002-504 142	● 0002-504 162
50	23	13	6	15000	10			● 0002-504 143	● 0002-504 163
60	12	15	6	15000	10			● 0002-505 141	● 0002-505 161
60	18	15	6	15000	6	POS Card		● 7002-505 142	● 7002-505 162
60	18	15	6	15000	10		● 0002-505 132	● 0002-505 142	● 0002-505 162
60	23	15	6	15000	10			● 0002-505 143	● 0002-505 163
70	11	15	6	15000	10			● 0002-506 141	● 0002-506 161
70	18	15	6	15000	6	POS Card			● 7602-506 162
70	18	15	6	15000	10		● 0002-506 132	● 0002-506 142	● 0002-506 162
70	23	15	6	15000	10			● 0002-506 143	● 0002-506 163
80	19	20	6	12000	10			● 0002-507 142	
80	19	20	6	15000	6	POS Card			● 7002-507 162
80	19	20	6	15000	10				● 0002-507 162

more on next page →



# Power Drills

## Wheel Brushes

∅	A	T	S	RPM max.	DU	PKG.	INOX 0.15	INOX 0.20	INOX 0.30
20	6	4	6	20000	10			● 0002-501 342	
20	9	4	6	20000	10			● 0002-501 343	
30	6	6	6	20000	10			● 0002-502 341	
30	9	6	6	20000	10		● 0002-502 332	● 0002-502 342	
30	12	6	6	20000	10		● 0002-502 333	● 0002-502 343	
40	7	10	6	18000	10		● 0002-503 331	● 0002-503 341	
40	11	10	6	18000	10		● 0002-503 332	● 0002-503 342	
40	11	15	6	18000	8	POS Card		● 7002-503 342	
40	16	10	6	18000	10		● 0002-503 333	● 0002-503 343	
50	10	13	6	15000	10			● 0002-504 341	● 0002-504 361
50	17	13	6	15000	6	POS Card		● 3002-504 342	● 7002-504 362
50	17	13	6	15000	10		● 0002-504 332	● 0002-504 342	● 0002-504 362
50	23	13	6	15000	10			● 0002-504 343	● 0002-504 363
60	12	15	6	15000	10			● 0002-505 341	● 0002-505 361
60	18	15	6	15000	6	POS Card		● 7002-505 342	● 7002-505 362
60	18	15	6	15000	10		● 0002-505 332	● 0002-505 342	● 0002-505 362
60	23	15	6	15000	10			● 0002-505 343	● 0002-505 363
70	11	15	6	15000	10			● 0002-506 341	● 0002-506 361
70	18	15	6	15000	6	POS Card			● 7002-506 362
70	18	15	6	15000	10		● 0002-506 332	● 0002-506 342	● 0002-506 362
70	23	15	6	15000	10			● 0002-506 343	● 0002-506 363
80	10	20	6	15000	10				● 5162-507 361
80	12	20	6	15000	10				● 0002-507 361
80	19	20	6	15000	6	POS Card		● 7002-507 342	● 7002-507 362
80	19	20	6	15000	10			● 0002-507 342	● 0002-507 362

∅	A	T	S	RPM max.	DU	PKG.	Brass 0.20		
20	9	4	6	20000	10		● 0002-501 542		
30	9	6	6	20000	10		● 0002-502 542		
40	11	10	6	18000	10		● 0002-503 542		
50	17	13	6	15000	10		● 0002-504 542		
60	18	15	6	15000	6	POS Card	● 7002-505 542		
60	18	15	6	15000	10		● 0002-505 542		
70	18	15	6	15000	6	POS Card	● 7002-506 542		
70	18	15	6	15000	10		● 0002-506 542		
80	19	20	6	15000	10		● 0002-507 542		



Appearance can vary from picture depending on variant.

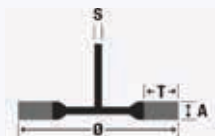

EUPBWB011 | PERFECT ★★☆☆☆

## Wheel brushes, crimped wire

**Crimped wheel brush, craftsman quality, for power drills.**

- Suitable for many DIY projects
- Easy to fit thanks to the shaft
- Flexible brush for simple cleaning tasks

**Application:** Cleaning work such as removal of paint, rust and scales.

Available on a practical display card with Eurostandard hole for ideal presentation at the POS.



∅	A	T	S	RPM max.	DU	PKG.	Steel 0.20	Steel 0.30
50	7	10	6	4500	8	POS Card		● 7003-600 221
50	7	10	6	4500	20		● 0003-600 211	● 0008-600 221
60	9	13	6	4500	20		● 0003-600 311	
63	9	13	6	4500	8	POS Card		● 7003-600 321
63	9	13	6	4500	20			● 0008-600 321
75	10	16	6	4500	8	POS Card	● 7003-600 411	● 7003-600 421
75	10	16	6	4500	10		● 0008-600 411	● 0008-600 421
75	15	16	6	4500	10			● 0008-600 422
100	12	22	6	4500	8	POS Card	● 7003-600 511	● 7003-600 521
100	12	22	6	4500	10		● 0008-600 511	● 0008-600 521
100	17	22	6	4500	10			● 0008-600 522

∅	A	T	S	RPM max.	DU	PKG.	INOX 0.20	INOX 0.30
50	7	10	6	4500	20		● 0088-600 221	
75	10	16	6	4500	6	POS Card		● 7008-600 432
75	10	16	6	4500	10			● 0008-600 432
100	10	22	6	4500	10		● 0008-600 531	
100	12	22	6	4500	6	POS Card		● 7018-600 521
100	12	22	6	4500	10			● 0088-600 521

∅	A	T	S	RPM max.	DU	PKG.	Brass Coated Steel 0.30	Brass 0.20
50	7	12	6	4500	20		● 0008-600 051	
75	10	15	6	4500	10		● 0008-600 075	
75	10	16	6	4500	10			● 0502-600 451
75	10	17	6	4500	8	POS Card		● 7023-600 451
100	12	22	6	4500	10		● 0008-600 010	

# Power Drills

## Wheel Brushes



Appearance can vary from picture depending on variant.

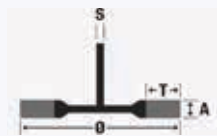

EUPBWB012 | SUPERIOR ★★★★★

## Wheel brushes, stranded, crimped wire

Wheel brush with Cordwire, industrial quality, for use on power drills.

- Brass-coated, stranded steel wire
- Effective woodworking, high friction on soft and hardwood
- Suitable to working on surfaces due to large working width
- TÜV-Süd certified (design tested, production monitored)

**Application:** Excellently suited to texturing wood. The natural grain of the wood is emphasized and an antique or rustic effect is created. The filaments of the brush ream the softer places of the wood more than the hard ones. They expose the wood grain and leave a sort of relief surface.

Available on a practical display card with Eurostandard hole for ideal presentation at the POS.



∅	A	T	B	RPM max.	PKG.	DU	Brass Coated Steel 0.25
80	35	20		4000		10	● 0908-507 061
80	35	20		4000	POS Card	8	● 7003-507 061

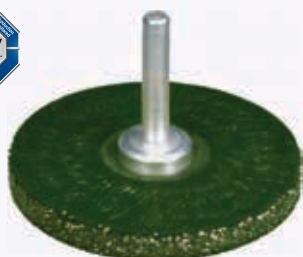

Appearance can vary from picture depending on variant.

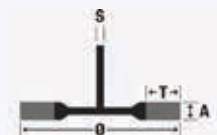

EUPBWB013 | EVOLUTION ★★★★★

## Wheel brushes, crimped wire, plastic-bonded

Plastic-bonded, crimped wheel brush, high-end quality, for use on power drills.

- Reduced wire breakage due to plastic bonding
- Lower effort, lower contact pressure
- TÜV-Süd certified (safety tested, production monitored)

**Application:** Removal of paint and lacquer, cleaning of narrow and inaccessible areas.

∅	A	T	S	RPM max.	DU	Brass Coated Steel 0.30
63	8	20	6	15000	8	● 7002-911 941
63	8	20	6	15000	12	● 0002-911 941
76	8	26	6	15000	12	● 0002-911 951



Appearance can vary from picture depending on variant.



EUPBWB014 | PERFECT ★★☆☆☆

## Wheel brushes, abrasive filament

**Grittyflex wheel brush with abrasive trim, craftsman quality, for power drills.**

- Adapts perfectly to the workpiece's contours
- Brush with abrasive nylon, gentle on material
- When being used, new abrasive grit keeps being released so that the removal rate is uniform
- Different grit sizes generate different surface finishes (blue finer, red coarser)
- TÜV-Süd certified (safety tested, production monitored)

**Application:** Suitable for all materials; for the easy roughing and smoothing of surfaces (depending on grit thickness), product of choice for woodworking.

Available on a practical display card with Eurostandard hole for ideal presentation at the POS.



Available as part of a set. More on page 67



∅	A	T	S	RPM max.	DU	PKG.	Nylon 80 red	Nylon 180 blue
75	10	16	6	4500	8	POS Card	● 7802-600 491	● 7182-600 491
75	10	16	6	4500	10		● 0802-600 491	● 0182-600 491
100	10	23	6	4500	8	POS Card	● 7802-600 591	● 7182-600 591
100	10	23	6	4500	10		● 0802-600 591	● 0182-600 591

# Power Drills

## Cup Brushes



Appearance can vary from picture depending on variant.



EUPBCB014 | SUPERIOR ★★☆☆☆

## Cup brushes, knotted wire

**Knotted cup brush, industrial quality, for use on power drills.**

- Osborn bestseller
- Long service life, low set-up costs / short set-up times
- Impressive cleaning effect on large areas
- TÜV-Süd certified (safety tested, production monitored)

**Application:** Rust removal, paint stripping, removing slag, silicate residuals and blue discolouring.

Available on a practical display card with Eurostandard hole for ideal presentation at the POS.



ø	T	S	RPM max.	DU	PKG.	Steel 0.50
65	23	6	6000	8	POS Card	● 7004-608 151
65	23	6	6000	10		● 1004-608 151



EUPBCB015 | PERFECT ★★☆☆☆

## Cup brushes, crimped wire

**Crimped cup brush, craftsman quality, for power drills.**

- Flexible
- Good price/performance ratio
- Suitable for many DIY projects
- Easy to fit thanks to the shaft

**Application:** Paint stripping and rust removal from surfaces.

Appearance can vary from picture depending on variant.



Available on a practical display card with Eurostandard hole for ideal presentation at the POS.



ø	T	S	RPM max.	DU	PKG.	Steel 0.20	Steel 0.30
50	17	6	4500	8	POS Card		● 7003-600 821
50	17	6	4500	20		● 0008-600 811	● 0008-600 821
75	20	6	4500	8	POS Card		● 7003-600 921
75	20	6	4500	10			● 0008-600 921
75	25	6	4500	8	POS Card	● 7003-600 911	
75	25	6	4500	10		● 0008-600 911	

ø	T	S	RPM max.	DU	PKG.	INOX 0.20	INOX 0.30
50		6		20		● 0008-600 831	
50	17	6	4500	10	POS Card		● 7008-600 832
50	17	6	4500	20			● 0008-600 832
75	20	6	4500	6	POS Card		● 7008-600 361
75	20	6	4500	10			● 0008-600 361

ø	T	S	RPM max.	DU	PKG.	Brass Coated Steel 0.30	Brass 0.20
50	16	6	4500	20		● 0028-600 041	
50	17	6	4500	20			● 0023-600 851
75	20	6	4500	10		● 0028-600 061	● 0023-600 951

# Power Drills

## Cup Brushes



EUPBCB016 | EVOLUTION ★★★★★

### Cup brushes, crimped wire, plastic-bonded

**Cup brush with plastic-bonded, crimped wire, high-end quality, for use on power drills.**

- Reduced wire breakage due to plastic bonding
- Lower applied force, lower contact pressure
- TÜV-Süd certified (safety tested, production monitored)

**Application:** Removal of paint and lacquer, cleaning of large surfaces.

Appearance can vary from picture depending on variant.



ø	T	S	RPM max.	DU	Brass Coated Steel 0.30
50	15	6	15000	12	● 0002-930 821



Appearance can vary from picture depending on variant.



EUPBCB017 | PERFECT ★★☆☆☆

## Cup brushes, abrasive filament

**Grittyflex cup brush with abrasive trim, craftsman quality, for power drills.**

- Adapts perfectly to the workpiece's contours
- Brush with abrasive nylon, gentle on material
- When being used, new abrasive grit keeps being released so that the removal rate is uniform
- Different grit sizes generate different surface finishes (blue finer, red coarser)
- TÜV-Süd certified (safety tested, production monitored)

**Application:** Suitable for all materials; for the easy roughing and smoothing of surfaces (depending on grit thickness), particularly recommended for woodworking.

Available on a practical display card with Eurostandard hole for ideal presentation at the POS.



Available as part of a set. More on page 67



ø	T	S	RPM max.	DU	PKG.	Nylon 80 red	Nylon 180 blue
50	17	6	4500	8	POS Card	● 7802-600 891	● 7182-600 891
50	17	6	4500	10		● 0802-600 891	● 0182-600 891
75	23	6	4500	8	POS Card	● 7802-600 991	● 7182-600 991
75	23	6	4500	10		● 0802-600 991	● 0182-600 991



# Power Drills

## End Brushes



Appearance can vary from picture depending on variant.



EUPBEB001 | SUPERIOR ★★☆☆☆

## End brushes, crimped wire

**Crimped end brush, industrial quality, for use on high-speed machines and power drills.**

- Flexible trim material, adjusts perfectly to the workpiece
- For pinpoint work in places difficult to access, such as boreholes

**Application:** Rust removal, paint stripping, smoothing, edge rounding, deburring, internal finishing.

ø	T	L	S	RPM max.	DU	Steel 0.20	Steel 0.30	Steel 0.50
10	20	60	6	20000	12	● 0003-509 141	● 0003-509 161	
10	20	65	6	20000	12			● 0003-509 191
17	25	68	6	18000	12	● 0002-509 142		● 0002-509 192
17	25	69	6	18000	8		● 7002-509 162	
17	25	69	6	18000	12		● 0002-509 162	
25	25	75	6	18000	12	● 0002-509 143	● 0002-509 163	● 0002-509 193
30	25	68	6	15000	8		● 7002-509 164	
30	25	68	6	15000	12	● 0002-509 144	● 0002-509 164	● 0002-509 194

ø	T	L	S	RPM max.	DU	INOX 0.20	INOX 0.30	Brass 0.30
10	20	60	6	20000	12	● 0003-509 341	● 0003-509 361	
10	20	65	6	20000	12			● 0003-509 561
17	25	68	6	18000	12	● 0002-509 342	● 0002-509 362	● 0002-509 562
25	25	75	6	18000	12	● 0002-509 343	● 0002-509 363	● 0002-509 563
30	25	68	6	15000	12	● 0002-509 344	● 0002-509 364	● 0002-509 564



EUPBEB002 | PERFECT ★★☆☆☆

## End brushes, crimped wire

**Crimped end brush, craftsman quality, for power drills.**

- For pinpoint work in places difficult to access
- Best price/performance ratio

**Application:** Rust removal, paint stripping, smoothing, edge rounding, deburring, internal finishing.

Appearance can vary from picture depending on variant.



Available on a practical display card with Eurostandard hole for ideal presentation at the POS.

ø	T	L	S	PKG.	RPM max.	DU	Steel 0.30	INOX 0.30	Brass Coated Steel 0.30
12	20		6		4500	20	● 0008-509 161		● 0008-509 061
17	25		6		4500	12			● 0008-509 062
17	25	70	6		4500	12	● 0008-509 162		
25	25	75	6		4500	12		● 0008-509 363	
25	25	75	6	POS Card	4500	12		● 7008-509 363	
25	30	80	6		4500	12	● 0008-509 163		● 0008-509 063
25	30	80	6	POS Card	4500	8	● 7002-509 163		
30	35		6		4500	12	● 0008-509 164		
30	35	55	6		4500	12			● 0008-509 064

# Power Drills

## End Brushes



Appearance can vary from picture depending on variant.



EUPBEB003 | EVOLUTION ★★★★★

## End brushes, crimped wire, plastic-bonded

End brush with plastic-bonded, crimped wire, high-end quality, for use on power drills and high-speed machines.

- longer service life
- Higher removal rate
- Reduced wire breakage due to plastic bonding
- Lower effort, lower contact pressure
- TÜV-Süd certified (safety tested, production monitored)

**Application:** Rust removal, paint stripping, smoothing, edge rounding, deburring, internal finishing.

ø	T	L	S	RPM max.	DU	Brass Coated Steel 0.30
17	24	67	6	15000	12	● 0002-930 902
24	23	66	6	15000	12	● 0002-930 907
31	23	66	6	15000	12	● 0002-930 912



Appearance can vary from picture depending on variant.



EUPBEB004 | SUPERIOR ★★☆☆☆

## End brushes, abrasive filament

End brush with abrasive filament in industrial quality for use on power drills.

- Powerful high-tech and very flexible trim material
- If individual filaments lie flat during use, continue working with the edge nevertheless because the length of the trim material has an end-to-end abrasive grit
- Varying surface pattern possible depending on grit selected; The higher the grit size, the finer the surface pattern
- Can be used on all materials
- TÜV-Süd certified (safety tested, production monitored)

**Application:** Roughing, texturing, paint stripping, deburring and cleaning.

∅	T	L	S	RPM max.	DU	Silicon Carbide 120	Silicon Carbide 180	Silicon Carbide 320
10	25		6	5000	12		● 1802-509 911	
10	25	75	6	8000	12			● 3202-509 911
15	25		6	4500	12	● 1202-509 912	● 1802-509 912	● 3202-509 912
22	25		6	4500	12	● 1202-509 913		● 3202-509 913
22	25	68	6	5000	12		● 1802-509 913	
28	25		6	5000	12		● 1802-509 914	
28	25	68	6	4500	12			● 3202-509 914
28	25	68	6	5000	12	● 1202-509 914		

# Power Drills

## End Brushes



Appearance can vary from picture depending on variant.



EUPBEB005 | PERFECT ★★☆☆☆

## End brushes, abrasive filament

**Grittyflex end brush with abrasive trim, craftsman quality, for power drills.**

- Adapts perfectly to the workpiece's contours
- Brush with abrasive nylon, gentle on material
- When being used, new abrasive grit keeps being released so that the removal rate is uniform
- Different grit sizes generate different surface finishes (blue finer, red coarser)
- TÜV-Süd certified (safety tested, production monitored)

**Application:** Suitable for all materials; for the easy roughing and smoothing of surfaces (depending on grit size), for internal finishing, suitable particularly for woodworking.

Available on a practical display card with Eurostandard hole for ideal presentation at the POS.



Available as part of a set. More on page 67



ø	T	L	S	RPM max.	DU	Nylon 80 red	Nylon 180 blue
25	25		6	5000	8		● 7802-509 913
25	25	68	6	5000	12	● 0812-509 913	● 1812-509 913
25	25	75	6	5000	8	● 7812-509 913	



Appearance can vary from picture depending on variant.



EUPBFW001 | PERFECT ★★☆☆☆

## Flap wheel brushes, crimped wire

Flap wheel brush with crimped wire, craftsman quality, for power drills.

- Particularly lightweight and flexible
- TÜV-Süd certified (safety tested, production monitored)

**Application:** Paint stripping, rust removal, deburring, descaling, smoothing and cleaning.

Available on a practical display card with Eurostandard hole for ideal presentation at the POS.

∅	A	T	S	RPM max.	DU	PKG.	Brass Coated Steel 0.30	Steel 0.30
100	23	25	6	3500	5			● 0004-401 132
100	23	25	6	3500	6	POS Card		● 7004-401 132
100	25	25	6	3500	5		● 0004-401 052	



Appearance can vary from picture depending on variant.



EUPBFW002 | PERFECT ★★☆☆☆

## Flap wheel brushes, abrasive filament

Flap wheel brush with abrasive trim, craftsman quality, for power drills.

- Particularly lightweight and flexible
- Adapts perfectly to the workpiece's contours
- When being used, new abrasive grit keeps being released so that the removal rate stays constant
- TÜV-Süd certified (safety tested, production monitored)

**Application:** Woodworking, texturing, paint stripping.

Available on a practical display card with Eurostandard hole for ideal presentation at the POS.



∅	A	T	S	RPM max.	DU	PKG.	Nylon 80 red	Nylon 180 blue
100	23	25	6	3500	5			● 0011-401 912
100	23	25	6	3500	6	POS Card	● 7801-401 912	● 7811-401 912

# Power Drills

Kits

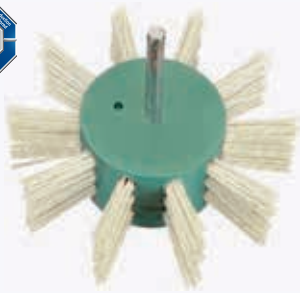

EUPBFW003 | PERFECT ★★☆☆☆

## Flap wheel brushes, natural filament

Flap wheel brushes in craftsman quality, for power drills.

- Particularly lightweight and flexible
- Adapts perfectly to the workpiece's contours
- TÜV-Süd certified (safety tested, production monitored)

**Application:** Cleaning

Appearance can vary from picture depending on variant.



ø	A	T	S	RPM max.	DU	PKG.	Natural Filament print-table-header.fibre
100	25	25	6	3500	5		● 0004-401 942



EUPBKT009 | PERFECT ★★☆☆☆

## Kit of 5 DIY brushes, crimped wire

Kit of 5 DIY brushes, with crimped wire, craftsman quality, for power drills.

- Suitable for any workpiece contour
- Best price/performance ratio

**Application:** Metalworking (cup brush for large areas, wheel brush for narrow places and end brush for internal finishing, corners and edges).

Appearance can vary from picture depending on variant.

Products included	Item Number
wheel brush - Ø50, shank-Ø 6 wheel brush - Ø75, shank-Ø 6 cup brush - Ø50, shank-Ø 6 cup brush - Ø70, shank-Ø 6 end brush - Ø25, shank-Ø 6	● 1418-600 005



Appearance can vary from picture depending on variant.



EUPBKT002 | PERFECT ★★☆☆☆

## Kit of 5 DIY brushes, abrasive filament

**Kit of 5 DIY brushes, with abrasive trim, craftsman quality, for power drills.**

- Suitable for any workpiece contour
- Practical POS blister packaging
- Best price/performance ratio

**Application:** Product of choice for woodworking (cup brush for large areas, wheel brush for narrow places and profiles, and end brush for internal finishing, corners and edges).

Products included	Item Number
contains : wheel brush - Ø50, shank-Ø 6 wheel brush - Ø75, shank-Ø 6 cup brush - Ø50, shank-Ø 6 cup brush - Ø75, shank-Ø 6 end brush - Ø25, shank-Ø 6	● 1518-600 005



Appearance can vary from picture depending on variant.

EUACAD013

## Drive arbor, type I

**For wheel brushes with bore. Brushes can be fitted up to a clamping width of 20 mm.**



Ø	F	S	DU	Item Number
10	20	6	1	● 0003-000 100
12.7	20	6	1	● 0004-000 127



## High Speed Machines

Wheel Brushes .....	70
End Brushes .....	74
Flap Wheels .....	80

# High Speed Machines

## Wheel Brushes



Appearance can vary from picture depending on variant.

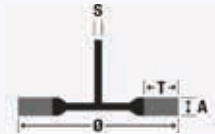

EUPBWB010 | SUPERIOR ★★☆☆☆

## Wheel brushes, crimped wire

**Crimped wheel brush, industrial quality, for use on power drills and high-speed machines.**

- Thanks to a number of selectable trim materials and brush diameters there is a brush for every application
- Small brush diameter enables access to difficult to reached places
- Also suitable for use on high-speed machines
- TÜV-Süd certified (safety tested, production monitored)

**Application:** Edge honing, finishing bores, deburring and minor cleaning work.

Available on a practical display card with Eurostandard hole for ideal presentation at the POS.



Ø	A	T	S	RPM max.	DU	PKG.	Steel 0.15	Steel 0.20	Steel 0.30
20	6	4	6	20000	10		● 0002-501 132	● 0002-501 142	
20	9	4	6	20000	10			● 0002-501 143	
30	6	6	6	20000	10			● 0002-502 141	
30	9	6	6	20000	10		● 0002-502 132	● 0002-502 142	
30	12	6	6	20000	10			● 0002-502 143	
40	7	10	6	18000	10			● 0002-503 141	
40	11	10	6	18000	8	POS Card		● 7002-503 142	
40	11	10	6	18000	10		● 0002-503 132	● 0002-503 142	
40	16	10	6	18000	10			● 0002-503 143	
50	10	13	6	15000	10			● 0002-504 141	● 0002-504 161
50	17	13	6	15000	6	POS Card		● 7602-504 142	
50	17	13	6	15000	10		● 0002-504 132	● 0002-504 142	● 0002-504 162
50	23	13	6	15000	10			● 0002-504 143	● 0002-504 163
60	12	15	6	15000	10			● 0002-505 141	● 0002-505 161
60	18	15	6	15000	6	POS Card		● 7002-505 142	● 7002-505 162
60	18	15	6	15000	10		● 0002-505 132	● 0002-505 142	● 0002-505 162
60	23	15	6	15000	10			● 0002-505 143	● 0002-505 163
70	11	15	6	15000	10			● 0002-506 141	● 0002-506 161
70	18	15	6	15000	6	POS Card			● 7602-506 162
70	18	15	6	15000	10		● 0002-506 132	● 0002-506 142	● 0002-506 162
70	23	15	6	15000	10			● 0002-506 143	● 0002-506 163
80	19	20	6	12000	10			● 0002-507 142	
80	19	20	6	15000	6	POS Card			● 7002-507 162
80	19	20	6	15000	10				● 0002-507 162

more on next page →

## Wheel Brushes

∅	A	T	S	RPM max.	DU	PKG.	INOX 0.15	INOX 0.20	INOX 0.30
20	6	4	6	20000	10			● 0002-501 342	
20	9	4	6	20000	10			● 0002-501 343	
30	6	6	6	20000	10			● 0002-502 341	
30	9	6	6	20000	10		● 0002-502 332	● 0002-502 342	
30	12	6	6	20000	10		● 0002-502 333	● 0002-502 343	
40	7	10	6	18000	10		● 0002-503 331	● 0002-503 341	
40	11	10	6	18000	10		● 0002-503 332	● 0002-503 342	
40	11	15	6	18000	8	POS Card		● 7002-503 342	
40	16	10	6	18000	10		● 0002-503 333	● 0002-503 343	
50	10	13	6	15000	10			● 0002-504 341	● 0002-504 361
50	17	13	6	15000	6	POS Card		● 3002-504 342	● 7002-504 362
50	17	13	6	15000	10		● 0002-504 332	● 0002-504 342	● 0002-504 362
50	23	13	6	15000	10			● 0002-504 343	● 0002-504 363
60	12	15	6	15000	10			● 0002-505 341	● 0002-505 361
60	18	15	6	15000	6	POS Card		● 7002-505 342	● 7002-505 362
60	18	15	6	15000	10		● 0002-505 332	● 0002-505 342	● 0002-505 362
60	23	15	6	15000	10			● 0002-505 343	● 0002-505 363
70	11	15	6	15000	10			● 0002-506 341	● 0002-506 361
70	18	15	6	15000	6	POS Card			● 7002-506 362
70	18	15	6	15000	10		● 0002-506 332	● 0002-506 342	● 0002-506 362
70	23	15	6	15000	10			● 0002-506 343	● 0002-506 363
80	10	20	6	15000	10				● 5162-507 361
80	12	20	6	15000	10				● 0002-507 361
80	19	20	6	15000	6	POS Card		● 7002-507 342	● 7002-507 362
80	19	20	6	15000	10			● 0002-507 342	● 0002-507 362

∅	A	T	S	RPM max.	DU	PKG.	Brass 0.20		
20	9	4	6	20000	10		● 0002-501 542		
30	9	6	6	20000	10		● 0002-502 542		
40	11	10	6	18000	10		● 0002-503 542		
50	17	13	6	15000	10		● 0002-504 542		
60	18	15	6	15000	6	POS Card	● 7002-505 542		
60	18	15	6	15000	10		● 0002-505 542		
70	18	15	6	15000	6	POS Card	● 7002-506 542		
70	18	15	6	15000	10		● 0002-506 542		
80	19	20	6	15000	10		● 0002-507 542		

# High Speed Machines

## Wheel Brushes



Appearance can vary from picture depending on variant.

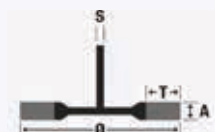

EUPBWB009 | SUPERIOR ★★☆☆☆

## Wheel brushes, knotted wire

**Knotted wheel brush, industrial quality, for use on power drills and high-speed machines.**

- Osborn bestseller
- High cleaning performance
- 6 mm shaft enables simple mounting
- Also suitable for use on high-speed machines
- TÜV-Süd certified (safety tested, production monitored)

**Application:** Cleaning, deburring, removal of slag and silicates, weld seam finishing, removal of protective undercoating in car workshops.

Available on a practical display card with Eurostandard hole for ideal presentation at the POS.



ø	A	T	S	RPM max.	PKG.	DU	Steel 0.35	Steel 0.50	INOX 0.50
75	8	18	6	20000	POS Card	8		● 7202-611 151	
75	12	15.5	6	20000		12		● 0202-611 151	
75	12	18	6	20000		12	● 0202-611 131		● 0202-611 351
75	12	18	6	20000	POS Card	8			● 7012-611 351



Appearance can vary from picture depending on variant.

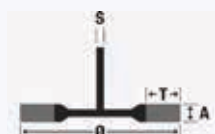

EUPBWB030 | XTREME ★★★★★★

## Wheel brushes, Xtreme Wire, crimped

**Wheel brush with shank and crimped Xtreme wire in high-end quality for use on power drills and high-speed machines.**

- Significantly increased service life
- Fine finish
- Low vibration, low noise
- The relatively small diameter enables machining of hard-to-reach places
- Adapts ideally to the workpiece

**Application:** Rounding edges, machining holes, deburring, cleaning

ø	A	T	S	RPM max.	DU	Steel 0.30
50	17	13	6	15000	10	● 3902-504 162
70	18	15	6	15000	10	● 3902-506 162



Appearance can vary from picture depending on variant.



EUPBWB034 | EVOLUTION ★★★★★

## Ringlock Wheel brushes, abrasive filament

**Ringlock wheel brush, industrial quality, with abrasive silicone carbide trim for attaching to high-speed machines.**

- Also suitable for non-ferrous metals and synthetics
- The small diameter enables access to hard to reach areas

**Application:** Deburring, edge rounding and surface finishing, can be used on a large number of materials.

ø	A	T	B	RPM max.	DU	Grit Size	Silicon Carbide 120	Silicon Carbide 180	Silicon Carbide 320
38	10	6	12.7	20000	12	120	● 9906-011 146		
38	10	6	12.7	20000	12	180		● 9906-011 147	
38	10	6	12.7	20000	12	320			● 9906-011 148
50	10	11	15.87	15000	12	120	● 9906-011 149		
50	10	11	15.87	15000	12	180		● 9906-011 150	
50	10	11	15.87	15000	12	320			● 9906-011 151
63	13	17	15.87	15000	12	120	● 9906-011 153		
63	13	17	15.87	15000	12	180		● 9906-011 154	
63	13	17	15.87	15000	12	320			● 9906-011 155

# High Speed Machines

## End Brushes



Appearance can vary from picture depending on variant.



EUPBEB001 | SUPERIOR ★★☆☆☆

## End brushes, crimped wire

**Crimped end brush, industrial quality, for use on high-speed machines and power drills.**

- Flexible trim material, adjusts perfectly to the workpiece
- For pinpoint work in places difficult to access, such as boreholes

**Application:** Rust removal, paint stripping, smoothing, edge rounding, deburring, internal finishing.

ø	T	L	S	RPM max.	DU	Steel 0.20	Steel 0.30	Steel 0.50
10	20	60	6	20000	12	● 0003-509 141	● 0003-509 161	
10	20	65	6	20000	12			● 0003-509 191
17	25	68	6	18000	12	● 0002-509 142		● 0002-509 192
17	25	69	6	18000	8		● 7002-509 162	
17	25	69	6	18000	12		● 0002-509 162	
25	25	75	6	18000	12	● 0002-509 143	● 0002-509 163	● 0002-509 193
30	25	68	6	15000	8		● 7002-509 164	
30	25	68	6	15000	12	● 0002-509 144	● 0002-509 164	● 0002-509 194

ø	T	L	S	RPM max.	DU	INOX 0.20	INOX 0.30	Brass 0.30
10	20	60	6	20000	12	● 0003-509 341	● 0003-509 361	
10	20	65	6	20000	12			● 0003-509 561
17	25	68	6	18000	12	● 0002-509 342	● 0002-509 362	● 0002-509 562
25	25	75	6	18000	12	● 0002-509 343	● 0002-509 363	● 0002-509 563
30	25	68	6	15000	12	● 0002-509 344	● 0002-509 364	● 0002-509 564



EUPBEB006 | SUPERIOR ★★☆☆☆

## End brushes, knotted wire

**Knotted end brush, industrial quality, for use on high-speed machines.**

- The diameter of the brush changes with increasing work speed; the brush flares, meaning different bore diameters can be worked on
- TÜV-Süd certified (design tested, production monitored)

**Application:** Rust removal, paint stripping, deburring, weld seams.

Appearance can vary from picture depending on variant.



### Important

The brushes flare when the machine is running (see picture). The table below provides information on the extent of brush flaring in relation to body diameter and rotation speed.

Recommended working speed about 50% of the max. min<sup>-1</sup>

Body Ø	Wire thickness	At speed ≤ min <sup>-1</sup> 5,000	At speed ≤ min <sup>-1</sup> 8,000	At speed ≤ min <sup>-1</sup> 15,000
20	0.26	55	70	75
20	0.35	25	50	70
23	0.26	40	65	75
23	0.35	35	55	70
30	0.26	55	70	85
30	0.35	50	70	80

Ø	T	L	S	RPM max.	DU	Steel 0.25	Steel 0.35	INOX 0.25	INOX 0.35
20	29	72	6	20000	12	● 0002-630 304	● 0002-630 305	● 0002-630 328	
20	29	72	6	22000	8		● 7002-630 305		
23	29	72	6	20000	12	● 0002-630 310	● 0002-630 311	● 0002-630 334	● 0002-630 335
30	29	72	6	20000	12	● 0002-630 316	● 0002-630 317	● 0002-630 340	● 0002-630 341

# High Speed Machines

## End Brushes



Appearance can vary from picture depending on variant.



EUPBEB007 | EVOLUTION ★★★★★

## End brushes, knotted wire

**Ruftuf end brushes, high-end quality, with high-performance wire developed by Osborn, for use on high-speed machines.**

- High-performance wire developed by Osborn
- Particularly cost-effective, long life, high tensile strength, high breaking strain and short set-up times
- The diameter of the brush changes with increasing work speed; the brush flares, meaning different bore diameters can be worked on
- Aggressive cleaning performance
- TÜV-Süd certified (design tested, production monitored)

**Application:** Rust removal, paint stripping, deburring, weld seams.

**Please note:** Stainless steel variants are degreased



### Important

The brushes flare when the machine is running (see picture). The table below provides information on the extent of brush flaring in relation to body diameter and rotation speed.

Recommended working speed about 50% of the max. min<sup>-1</sup>

Body Ø	Wire thickness	At speed ≤ min <sup>-1</sup> 5,000	At speed ≤ min <sup>-1</sup> 8,000	At speed ≤ min <sup>-1</sup> 15,000
20	0.26	55	70	75
20	0.35	25	50	70
23	0.26	40	65	75
23	0.35	35	55	70
30	0.26	55	70	85
30	0.35	50	70	80

Ø	T	L	S	RPM max.	DU	Steel 0.15	Steel 0.25	Steel 0.35	Steel 0.50
20	29	72	6	20000	12	● 9906-030 302	● 9906-030 304	● 9906-030 305	
23	29	72	6	20000	12	● 9906-030 308	● 9906-030 310	● 9906-030 311	● 9906-030 312
30	29	72	6	20000	12	● 9906-030 314	● 9906-030 316	● 9906-030 317	● 9906-030 318

Ø	T	L	S	RPM max.	DU	INOX 0.15	INOX 0.25	INOX 0.26	INOX 0.35
20	29	72	6	20000	12	● 9906-030 326		● 9906-030 328	● 9906-030 329
23	29	72	6	20000	12	● 9906-030 332	● 9906-030 334		● 9906-030 335
30	29	72	6	20000	12	● 9906-030 338	● 9906-030 340		● 9906-030 341





Appearance can vary from picture depending on variant.



EUPBEB008 | SUPERIOR ★★★★★☆

## End brushes, knotted wire

**Knotted end brush, industrial quality, for use on high-speed machines.**

- Particularly suited for areas extremely difficult to access
- For pinpoint work

**Application:** Removal of oxide layers and for deburring.

ø	T	L	S	RPM max.	DU	Steel 0.25	Steel 0.35	Steel 0.50
10	26	72	6	4500	12	● 9803-630 151	● 9803-630 171	● 9803-630 101

ø	T	L	S	RPM max.	DU	INOX 0.25	INOX 0.35	INOX 0.50
10	26	72	6	4500	1			● 9803-630 301
10	26	72	6	4500	12	● 9803-630 351	● 9803-630 371	



Appearance can vary from picture depending on variant.

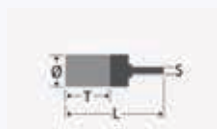

EUPBEB009 | SUPERIOR ★★★★★☆

## End brushes, crimped wire

**Crimped end brush, industrial quality, for use on high-speed machines.**

- Extra long shape
- Can penetrate deep into bores to reach places difficult to access
- Flexible

**Application:** Internal finishing, rust removal, paint stripping, deburring, rounding edges.

ø	T	L	S	RPM max.	DU	Steel 0.20	Steel 0.30	INOX 0.20	INOX 0.30
10	20	118	6	9000	10				● 0003-509 369
10	20	118	6	10000	25		● 0003-509 169		
10	20	120	6	9000	10	● 0003-509 149		● 0003-509 349	

# High Speed Machines

## End Brushes



Appearance can vary from picture depending on variant.



EUPBEB011 | SUPERIOR ★★★★★

### End brushes, crimped wire

**Crimped end brush, industrial quality, for use on high-speed machines.**

- Flexible
- The special shape of the brush means frontal and radial processing is possible in one step

**Application:** Minor cleaning work, removal of corrosion and coating.

ø	T	S	RPM max.	DU	Steel 0.30
50	14	6	18000	5	● 0002-509 165
70	20	6	15000	5	● 0002-509 167

EUPBEB012 | SUPERIOR ★★★★★

### End brushes, crimped wire

**Crimped end brush, industrial quality, for use on high-speed machines.**

- Particularly suited for areas extremely difficult to access
- For pinpoint work
- Adapts very well to the component's outline

**Application:** Removal of oxide layers, deburring, removal of coatings such as paint and primers.



Appearance can vary from picture depending on variant.



ø	T	L	S	RPM max.	DU	Steel 0.40
8	29	86	6	12000	12	● 0024-509 101
9.5	29	85	6	12000	12	● 0024-509 102
10	27	186	6	12000	6	● 1224-509 101
12	29	88	6	12000	12	● 0024-509 111
12	55	114	6	12000	6	● 0014-509 102
20	25	72	6	12000	6	● 0024-509 103

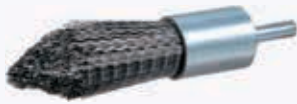

Appearance can vary from picture depending on variant.



EUPBEB013 | SUPERIOR ★★☆☆☆

## End brushes, straight/crimped wire

**End brush with pointed shape, industrial quality, for use on high-speed machines.**

- Particularly aggressive
- For places difficult to access and internal surfaces

**Application:** Removal of burrs, scales, slag, paint, moulding sand and other debris.

ø	T	L	S	RPM max.	DU	Steel 0.40	Steel 0.50	INOX 0.30	INOX 0.50
9.5	32	89	6	12000	12	● 0124-509 101		● 0074-509 301	
10	27	186	6	7000	6	● 2224-509 101			
10	31	87	6	12000	12	● 0224-509 101			
11	32	91	6	12000	6				● 0004-509 302
12	30	89	6	12000	12	● 0124-509 111			
19	31	82	6	12000	6		● 0124-509 103		● 0124-509 303
19	64	115	6	4000	6		● 0024-509 100		
25	35	86	6	12000	6				● 0014-509 304



Appearance can vary from picture depending on variant.



EUPBEB014 | EVOLUTION ★★★★★

## End brushes, abrasive filament

**End brush with abrasive filament in high-end quality for use on high-speed machines and power drills.**

- High flexibility
- Suitable for wet and dry work and long service life given perfect conditions
- Low contact pressure and low build-up of heat
- Resistant to weak acids and bases
- No clogging of the trim surface with working residues

**Application:** Deburring, edge rounding, surface finishing.

ø	T	L	S	RPM max.	DU	Silicon Carbide 120	Silicon Carbide 180	Silicon Carbide 320
10	25	75	6	8000	12	● 9906-030 488	● 9906-030 489	● 9906-030 490
15	25	68	6	5000	12	● 9906-030 492	● 9906-030 493	● 9906-030 494
22	25	75	6	5000	12	● 9906-030 496	● 9906-030 497	● 9906-030 498
28	25	68	6	5000	12	● 9906-030 500	● 9906-030 501	● 9906-030 502

# High Speed Machines

## Flap Wheels



Appearance can vary from picture depending on variant.



EUPSW001 | SUPERIOR ★★☆☆☆

## Flap wheels

Coated abrasive flap wheels with aluminium oxide, industrial quality, for use on high-speed machines.

- Homogeneous pattern
- Adapt perfectly to complex contours
- Small surfaces that are difficult to access can be reached perfectly
- Can be used universally on many different materials

**Application:** Pre-sanding and texturing. Burrs and scratches can be removed. For the surface treatment of almost all parts made of steel, aluminium, non-ferrous metals, wood and hard plastic.

ø	A	S	RPM max.	DU	Aluminium Oxide 40	Aluminium Oxide 60	Aluminium Oxide 80	Aluminium Oxide 120
30	10	6	25400	10	● 0043-003 010	● 0063-003 010	● 0083-003 010	● 0123-003 010
30	15	6	25400	10	● 0043-003 015	● 0063-003 015	● 0083-003 015	● 0123-003 015
40	15	6	19100	10	● 0043-004 015	● 0063-004 015	● 0083-004 015	
40	20	6	19100	10	● 0043-004 020	● 0063-004 020	● 0083-004 020	● 0123-004 020
40	30	6	17000	10	● 0063-004 030	● 0083-004 030		● 0123-004 030
50	15	6	15200	10	● 0043-005 015	● 0063-005 015	● 0083-005 015	● 0123-005 015
50	20	6	15200	10	● 0043-005 020	● 0063-005 020	● 0083-005 020	● 0123-005 020
50	30	6	15200	10	● 0043-005 030	● 0063-005 030	● 0083-005 030	● 0123-005 030
60	20	6	12700	10	● 0043-006 020	● 0063-006 020	● 0083-006 020	● 0123-006 020
60	30	6	12700	10	● 0043-006 030	● 0063-006 030	● 0083-006 030	● 0123-006 030
60	40	6	12700	10	● 0043-006 040	● 0063-006 040	● 0083-006 040	● 0123-006 040
60	50	6	12700	10	● 0043-006 050	● 0063-006 050		
80	30	6	8900	10	● 0043-008 030	● 0063-008 030	● 0083-008 030	● 0123-008 030
80	40	6	8900	10		● 0063-008 040	● 0083-008 040	
80	50	6	8900	10	● 0043-008 050	● 0063-008 050	● 0083-008 050	● 0123-008 050

ø	A	S	RPM max.	DU	Aluminium Oxide 150	Aluminium Oxide 180	Aluminium Oxide 240
30	10	6	25400	10			● 0243-003 010
30	15	6	25400	10	● 0153-003 015		● 0243-003 015
40	15	6	19100	10		● 0183-004 015	● 0243-004 015
40	20	6	19100	10	● 0153-004 020		● 0243-004 020
50	15	6	15200	10	● 0153-005 015		
50	20	6	15200	10	● 0153-005 020		
50	30	6	15200	10	● 0153-005 030	● 0183-005 030	● 0243-005 030
60	20	6	12700	10	● 0153-006 020	● 0183-006 020	● 0243-006 020
60	30	6	12700	10	● 0153-006 030	● 0183-006 030	● 0243-006 030
60	40	6	12700	10	● 0153-006 040	● 0183-006 040	● 0243-006 040
60	50	6	12700	10	● 0153-006 050	● 0183-006 050	● 0243-006 050
80	40	6	8900	10	● 0153-008 040		● 0243-008 040
80	50	6	8900	10		● 0183-008 050	● 0243-008 050



Appearance can vary from picture depending on variant.



EUPSFW002 | SUPERIOR ★★☆☆☆

## Coated abrasive and non-woven combi flap wheels

**Combi flap wheel with coated abrasives and non-woven material, industrial quality, for use on high-speed machines.**

- The combination of two trim materials means minor scratches can be removed, and simultaneously the workpiece can be perfectly readied for satin finishing
- The surface pattern can be tailored to individual needs depending on cutting speed and contact pressure
- The combination of abrasive fleece and non-woven material enhances the sanding effect of the fleece

**Application:** Fine surface pattern and readying for satin finishing. Ideal for removing minor scratches; final finish also possible depending on grit size.

ø	A	S	RPM max.	DU	Aluminium Oxide 60	Aluminium Oxide 80	Aluminium Oxide 150	Silicon Carbide 240
40	20	6	17100	10	● 0063-404 020	● 0083-404 020	● 0153-404 020	● 1243-404 020
40	30	6	17100	10	● 0063-404 030		● 0153-404 030	● 1243-404 030
50	20	6	13700	10	● 0063-405 020		● 0153-405 020	● 1243-405 020
50	30	6	13700	10	● 0063-405 030	● 0083-405 030	● 0153-405 030	● 1243-405 030
50	40	6	13700	10	● 0063-405 040			● 1243-405 040
60	30	6	11500	10	● 0063-406 030		● 0153-406 030	● 1243-406 030
60	40	6	11500	10	● 0063-406 040	● 0083-406 040	● 0153-406 040	● 1243-406 040
60	50	6	11500	10	● 0063-406 050			● 1243-406 050
80	40	6	8600	10	● 0063-408 040		● 0153-408 040	● 1243-408 040
80	50	6	8600	10	● 0063-408 050	● 0083-408 050	● 0153-408 050	● 1243-408 050

# High Speed Machines

## Flap Wheels



Appearance can vary from picture depending on variant.



EUPSFW003 | SUPERIOR ★★☆☆☆

## Non-woven abrasive flap wheels

**Non-woven abrasive flap wheel with aluminium oxide abrasive grit, industrial quality, for use on high-speed machines.**

- Fine and harmonious surface finish due to the dense structure of the non-woven material
- Besides the main application, oxide layers can be cleaned off and wood and plastic can be smoothed

**Application:** Matting, satin and final finishing.

### Comparable grits Fleece vs. FEPA

- Coarse = 80 - 120
- Medium = 150 - 220
- Fine = 240 - 360
- Very fine = 400 - 600

### Good to know

Flap wheels are excellently suited to surface cleaning. They generate a surface pattern of high density on all metal surfaces.

With aluminium oxide.

ø	A	S	RPM max.	DU	Aluminium Oxide coarse	Aluminium Oxide fine	Aluminium Oxide medium	Aluminium Oxide very fine
40	20	6	17100	10	● 0083-304 020	● 0243-304 020	● 0153-304 020	● 0323-304 020
40	30	6	17100	10	● 0083-304 030	● 0243-304 030	● 0153-304 030	
50	30	6	13700	10	● 0083-305 030	● 0243-305 030	● 0153-305 030	● 0323-305 030
50	40	6	13700	10	● 0083-305 040	● 0243-305 040	● 0153-305 040	● 0323-305 040
60	30	6	11500	10	● 0083-306 030	● 0243-306 030	● 0153-306 030	● 0323-306 030
60	50	6	11500	10		● 0243-306 050	● 0153-306 050	
80	50	6	8600	10	● 0083-308 050	● 0243-308 050	● 0153-308 050	



# Burnishing Machines

# Burnishing Machines

## Abrasive Rollers



Appearance can vary from picture depending on variant.

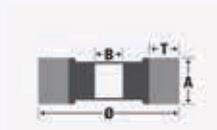

EUPSRB001 | SUPERIOR ★★★★★

## Coated abrasive flap rollers

Coated abrasive flap rollers, industrial quality, with bore 19 and 4 keyways.

- Coated abrasive with aluminium oxide
- Generates a homogeneous surface pattern

**Application:** For pre-sanding and texturing.

ø	A	B	RPM max.	DU	PKG.	Aluminium Oxide 40	Aluminium Oxide 60	Aluminium Oxide 80	Aluminium Oxide 120
100	100	19	5000	1	POS Box	● 0043-010 100	● 0063-010 100	● 0083-010 100	● 0123-010 100



Appearance can vary from picture depending on variant.

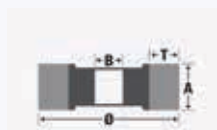

EUPSRB002 | SUPERIOR ★★★★★

## Coated abrasive and non-woven combi rollers

Abrasive flap rollers with non-woven and abrasive cloth combined, industrial quality.

- Coated abrasive with aluminium oxide
- Generates a fine surface pattern
- Ideal for removing small scratches

**Application:** For preparation of a satin finishing process.

ø	A	B	RPM max.	DU	PKG.	Aluminium Oxide 60 coarse	Aluminium Oxide 80 medium	Aluminium Oxide 120 fine
100	100	19	5000	1	POS Box	● 0063-410 100	● 0083-410 100	● 0123-410 100





Appearance can vary from picture depending on variant.

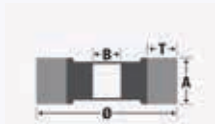

EUPSRB003 | SUPERIOR ★★★★★

## Non-woven (satin) finishing rollers

**Satin finish rollers with non-woven abrasive material, industrial quality.**

- Generates a satin, matted surface on all materials
- The surface pattern varies depending on the grit (from coarse to very fine)

**Application:** For creating satin finished surfaces.

ø	A	B	RPM max.	DU	PKG.	Aluminium Oxide coarse	Aluminium Oxide fine	Aluminium Oxide very fine
100	100	19	5000	1	POS Box	● 0083-310 100	● 0183-310 100	● 0283-310 100

## Stationary Machines

Wheel Bruhes .....	88
Roller Brushes .....	102
End Brushes .....	102
Accessories .....	103

# Stationary Machines

## Technical and General Information

### General Information

#### Changing of the Standard Bore

For single-row as well as multi-row brushes, we provide brushes with standard bore "Min. B" if no other bore is specified. Alternative bores are provided in the following tables.

#### Standard Bores for Single-Row Brushes

We will be glad to change the standard bore dimension to suit your mounting. The relevant part number starts with 000200- and ends with the 4-digit code in the table. Brushes bored to bore 50.8 mm (2") can be reduced further with a 4-M adapter.

Brush Ø		Bore Ø														
mm		13		16	19	20			30		32	35	38	40	44	50.8
	inch		5/8		3/4		7/8	1		1 1/4						2
75	3	7413														
100	4	7413	7415	7416	7419	7420										
125	5	7413	7415	7416	7419	7420	7422	7425	7430	7431						
150	6	7413	7415	7416	7419	7420	7422	7425	7430	7431	7432	7435		7440	7444	
175	7	7413	7415	7416	7419	7420	7422	7425	7430	7431	7432	7435	7483			
200	8				7419	7420	7422	7425	7430	7431	7432	7435	7483			7450
250	10					7420	7422	7425	7430	7431	7432	7435		7440		7450
300	12							7425	7430	7431	7432	7435		7440		7450
350	14									7431	7432	7435		7440		7450

#### Standard Bores for Multi-Row Brushes

Multi-row brushes mounted via tube are reduced by pressing in our robust metal adapters (kept in stock). The adapters available for every tube diameter are in the following table. The relevant part number starts with 000200- and ends with the 4-digit code in the following table.

Tube Ø		Bore Ø														
mm		9.35	10	12.7	13	16	19	20	22.2	25.4	30	31.8	32	35	40	50.8
	inch	3/8		1/2		5/8	3/4		7/8	1		1 1/4				2
20		8109	8110	8112	8113	8116										
30		8109	8110	8112	8113	8116	8219	8220	8222	8225						
50.8	2			8112	8113	8116	8219	8220	8222	8225	8430	8431	8432	8435		
80						8116	8219	8220	8222	8225	8430	8431	8432	8435	8640	8642
100								8220	8222	8225	8430	8431	8432	8435	8640	8642
120										8225	8430	8431	8432	8435	8640	8642



Appearance can vary from picture depending on variant.



EUPBWB018 | SUPERIOR ★★☆☆☆

## Wheel brushes, knotted wire

**Knotted wheel brush, industrial quality, for mounting on stationary machines.**

- Knots are guided and secured in position, thereby prevent early wire breaks
- Slightly open knotting

**Application:** Weld seam cleaning, deburring of cast iron and steel parts with high burr generation, removal of overruns on rubber-bonded- to-metal components, removal of insulation/coatings.

**Please note:** For other bore sizes, refer to table "Standard Bores for Single-Row Brushes"

**0002-664 152** B min. and B max. = pipe diameter – for reducing the bore size, refer to the 1-A adapter

∅	A	T	B min.	B max.	RPM max.	DU	Steel 0.35	Steel 0.50	Steel 0.80
200	13	42	20	50.8	8500	1	● 0002-664 131	● 0002-664 151	● 0002-664 181
200	26	42	12.7	50.8	8500	1		● 0002-664 152	
250	15	42	25.4	50.8	4500	2	● 0002-676 131	● 0002-676 151	● 0002-676 181
300	18	55	25.4	50.8	3600	2	● 0002-686 131	● 0002-686 151	● 0002-686 181

# Stationary Machines

## Wheel Brushes



Appearance can vary from picture depending on variant.



EUPBWB019 | SUPERIOR ★★☆☆☆

### Joint brushes, knotted wire

**Knotted joint brush, industrial quality, for use on a cutting machine for road-construction.**

- For speedy and efficient work
- Excellent cleaning of tight spaces that are difficult to access

**Application:** Removal of stones, gravel and other debris from (expansion) joints during road-construction.

**Please note:** For other bore sizes, refer to table "Standard Bores for Single-Row Brushes"



Joint brush used in road construction



before



after

∅	A	T	B	RPM max.	DU	Steel 0.50	Steel 0.80
300	4	65	20	4500	6	● 9802-026 560	
300	6	65	20	4500	6	● 9802-026 561	● 9802-026 581
300	8	65	20	4500	6	● 9802-026 562	● 9802-026 582
300	10	65	20	4500	6	● 9802-026 563	● 9802-026 583



Appearance can vary from picture depending on variant.



EUPBWB020 | SUPERIOR ★★★★★

## Wheel brushes, crimped wire

**Wheel brush with crimped wire, industrial quality, for mounting on stationary machines.**

- Several brushes of the same kind can be mounted on one shaft to increase the working width
- TÜV-Süd certified (safety tested, production monitored)
- Very high flexibility
- Suitable for geometrically challenging parts

**Application:** Smoothing, deburring, edge rounding, texturing, rust removal and paint stripping of steel, cast steel and stainless steel.

**Please note:** For other bore sizes, refer to table "Standard Bores for Single-Row Brushes"

Ø	A	T	B min.	B max.	RPM max.	DU	Steel 0.20	Steel 0.30
75	11	15	13	13	10000	5		● 0002-511 161
100	13	23	13	20	8000	8	● 0002-522 141	● 0002-522 161
125	15	35	13	20	6000	5		● 0002-532 161
150	16	32	13	32	6000	4	● 0002-544 141	
150	16	32	13	32	6000	8		● 0002-544 161
178	18	45	13	32	6000	4	● 0002-554 141	
178	18	45	13	32	6000	8		● 0002-554 161
200	19	33	19	50.8	4500	1		● 0002-566 161
200	19	38	19	50.8	4500	2	● 0002-566 141	
250	22	35	20	50.8	3600	2	● 0002-576 141	● 0002-576 161
300	26	58	20	50.8	3000	1		● 0002-587 161

Ø	A	T	B min.	B max.	RPM max.	DU	INOX 0.20	INOX 0.30
100	13	23	13	20	8000	8	● 0002-522 341	● 0002-522 361
125	15	35	13	20	6000	5		● 0002-532 361
150	16	32	13	32	6000	2		● 0002-544 361
150	16	32	13	32	6000	3	● 0002-544 341	
178	18	45	13	32	6000	4	● 0002-554 341	● 0002-554 361
200	19	38	19	50.8	4500	2		● 0002-566 361
250	22	35	20	50.8	3600	2	● 0002-576 341	● 0002-576 361
300	26	58	20	50.8	3000	2	● 0002-587 341	

# Stationary Machines

## Wheel Bruhes



Appearance can vary from picture depending on variant.

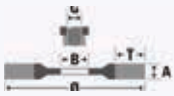

EUPBWB021 | SUPERIOR ★★☆☆☆

## Band saw brush

**Band saw brush with nylon trim, industrial quality, for mounting on stationary machines.**

- Long service life; efficient working
- Prolonged saw blade life
- The saw blade can work through the wood easier because there is no great generation of chips

**Application:** Cleaning the chip chambers of saw blades. When the brush presses against the moving saw blade, the brush is set into motion and the brush cleans the chip chambers of saw blades

ø	A	T	B	RPM max.	DU	Nylon 0.80
100	15	20	13	8000	10	● 0003-515 827



Appearance can vary from picture depending on variant.



EUPBWB022 | EVOLUTION ★★★★★

## Wheel brushes, crimped Osborn wire

**Crimped wheel brush, high-end quality, for mounting on stationary machines.**

- Specially hardened Osborn wire for industrial applications
- Several brushes of the same kind can be mounted on one shaft
- Very high wire count / wire density
- Filled without gaps; Lower wear
- Homogeneous results

**Application:** Automated manufacturing processes for the deburring of machined and sawn cutting edges and surfaces.

**Please note:** For other bore sizes, refer to table "Standard Bores for Single-Row Brushes"



MONITOR® – Round bore



MATIC® – Keyway bore



MASTER® – Turtle bore

∅	A	T	B	B Type	Adapt.	RPM max.	DU	Steel 0.15	Steel 0.20
200	18	38	50.8	keyways	1A	4500	2	● 9906-021 183	● 9906-021 184
200	22	37	50.8	keyways	1A	4500	1	● 9906-022 081	● 9906-022 082
250	26	60	50.8	turtle	4M	3600	2		● 9906-013 008

∅	A	T	B	B Type	Adapt.	RPM max.	DU	Steel 0.30	INOX 0.26
150	14	29	31.8	round	3A	6000	6		● 9906-021 059
200	22	37	50.8	keyways	1A	4500	2	● 9906-022 085	
250	26	60	50.8	turtle	4M	3600	2	● 9906-013 009	
300	28	60	50.8	turtle	4M	3000	2	● 9906-013 021	
380	32	72	50.8	turtle	4M	2400	1	● 9906-013 057	



# Stationary Machines

## Wheel Brushes



Appearance can vary from picture depending on variant.

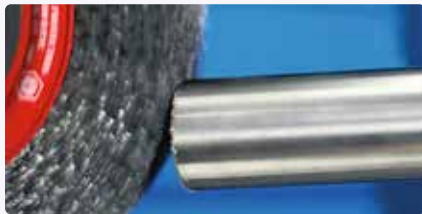

EUPBWB023 | SUPERIOR ★★☆☆☆

## Wheel brushes, crimped wire

**Multi-row wheel brush with crimped wire, industrial quality, for mounting on stationary machines.**

- Aggressive variant
- TÜV-Süd certified (safety tested, production monitored)
- Larger body, so more wire tips are simultaneously in use
- High wire density

**Application:** On a workbench grinder or table deburrer for rust/paint removal, cleaning, roughening or deburring.

**Please note:** For other bore sizes, refer to table "Standard Bores for Multi-Row Brushes"

### Bore reduction pieces included

- Ø 75-125 mm: 20 mm | 1/2" and 5/8"
- Ø 150-200 mm: 31.75 | 13 | 15 | 16 | 19 | 20 mm | 7/8" and 1"

Ø	A	T	B max.	RPM max.	DU	Steel 0.20	Steel 0.30	Steel 0.50
75	19	16	20	10000	4		● 9902-511 162	
100	20	23	20	8000	5	● 9902-522 142	● 9902-522 162	
100	28	23	20	8000	5		● 9902-522 163	
125	22	30	20	6000	5	● 9902-532 142	● 9902-532 162	
125	30	30	20	6000	5		● 9902-532 163	
150	21	25	31.75	6000	3	● 9902-544 441	● 9902-544 461	● 9902-544 491
150	30	29	31.75	6000	3	● 9902-544 142	● 9902-544 162	
150	37	29	31.75	6000	3		● 9902-544 163	● 9902-544 193
178	23	38	31.75	6000	1	● 9902-554 441	● 9902-554 461	
178	32	38	31.75	6000	1	● 9902-554 142	● 9902-554 162	● 9902-554 192
178	38	38	31.75	6000	1		● 9902-554 163	
200	20	38	31.75	4500	1	● 9902-566 441	● 9902-566 461	● 9902-566 491
200	30	38	31.75	4500	1	● 9902-566 142	● 9902-566 162	● 9902-566 192
200	38	38	31.75	4500	1	● 9902-566 143	● 9902-566 163	● 9902-566 193
250	28	47	50.8	3600	1	● 9902-576 142	● 9902-576 162	● 9902-576 192
250	38	47	50.8	3600	1	● 9902-576 143	● 9902-576 163	● 9902-576 193
250	55	47	50.8	3600	1		● 9902-576 464	
300	32	50	50.8	3000	1	● 9902-587 142	● 9902-587 162	● 9902-587 192
300	44	50	50.8	3000	1	● 9902-587 143	● 9902-587 163	● 9902-587 193
300	46	50	101.6	3000	1		● 0002-587 162	

more on next page →

## Wheel Bruhes

∅	A	T	B max.	RPM max.	DU	INOX 0.20	INOX 0.30
75	19	16	20	10000	4		● 9902-511 362
100	20	23	20	8000	4	● 9902-522 342	● 9902-522 362
100	28	23	20	8000	4		● 9902-522 363
125	22	30	20	6000	2	● 9902-532 342	● 9902-532 362
125	30	30	20	6000	2		● 9902-532 363
150	21	25	31.75	6000	2	● 9902-544 341	● 9902-544 361
150	30	29	31.75	6000	2	● 9902-544 342	● 9902-544 362
178	23	38	31.75	6000	1	● 9902-554 341	● 9902-554 361
178	32	38	31.75	6000	1		● 9902-554 362
200	20	38	31.75	4500	1	● 9902-566 341	● 9902-566 361
200	30	38	31.75	4500	1	● 9902-566 342	● 9902-566 362
200	38	38	31.75	4500	1		● 9902-566 363
250	28	47	50.8	3600	1	● 9902-576 342	● 9902-576 362
250	38	47	50.8	3600	1	● 9902-576 343	● 9902-576 363
300	32	50	50.8	3000	1	● 9902-587 342	● 9902-587 362
300	44	50	50.8	3000	1	● 9902-587 343	● 9902-587 363

# Stationary Machines

## Wheel Brushes



Appearance can vary from picture depending on variant.

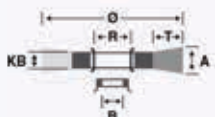

EUPBWB024 | SUPERIOR ★★★★★

## Wheel brushes, crimped wire

**Multi-row wheel brush with crimped wire, industrial quality, for mounting on stationary machines.**

- Flexible variant due to extra long trim length
- TÜV-Süd certified (safety tested, production monitored)
- Adapts perfectly to the contours of the workpiece
- High wire density

**Application:** Fine surface finishing on geometrically challenging parts.

**Please note:** For other bore sizes, refer to table "Standard Bores for Multi-Row Brushes"

### Bore reduction pieces included

- Ø 75-125 mm: 20 mm | 1/2" and 5/8"
- Ø 150-200 mm: 31.75 | 13 | 15 | 16 | 19 | 20 mm | 7/8" and 1"

Ø	A	T	B max.	R	RPM max.	DU	Steel 0.20	Steel 0.30	INOX 0.20
150	24	43	20	20	6000	3	● 9902-543 142	● 9902-543 162	
178	32	43	31.75	31.75	6000	1		● 9902-553 162	
200	33	55	31.75	31.75	4500	1	● 9902-565 142	● 9902-565 162	
200	42	55	31.75	31.75	4500	1		● 9902-565 163	
250	32	63	50.8	80	3600	1	● 9902-575 142	● 9902-575 162	● 9902-575 342
250	42	63	50.8	80	3600	1		● 9902-575 163	
300	33	70	50.8	100	3000	1	● 9902-586 142	● 9902-586 162	● 9902-586 342
300	45	70	50.8	100	3000	1		● 9902-586 163	● 9902-586 343

Ø	A	T	B max.	R	RPM max.	DU	INOX 0.30	Brass 0.20	Brass 0.30
150	24	43	20	20	6000	2	● 9902-543 362	● 9902-543 542	● 9902-543 562
150	32	43		20	6000	2		● 9902-543 543	
150	32	43	20	20	6000	2			● 9902-543 563
200	33	55	31.75	31.75	4500	1	● 9902-565 362	● 9902-565 542	● 9902-565 562



Appearance can vary from picture depending on variant.

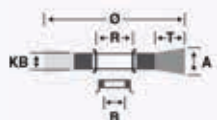

EUPBWB025 | SUPERIOR ★★☆☆☆

## Wheel brushes for table-deburring machines, crimped wire

Wheel brush with crimped wire, industrial quality, for mounting on deburring machines.

- Particularly dense and compact design with maximum number of wires for high deburring performance and excellent service life
- Statically balanced with high level of concentricity accuracy
- Adaptions with double keyways and regular holes for all common table deburrers
- Special adapters possible on request

**Application:** Cutting edge deburring of pipes, profiles and flat parts on table deburrer and automated machines.

ø	A	T	R	Adapt.	RPM max.	DU	Steel 0.20	Steel 0.30	Steel 0.35	Steel 0.50
250	55	35	100	AS-TE	3600	1			● 0042-576 175	
250	55	45	100	AS-TE	3600	1		● 0042-576 165		
250	65	45	100	AS-TE	3600	1	● 0002-576 145			● 0002-576 195
300	55	70	100	AS-TE	2800	1			● 0002-586 175	

ø	A	T	R	Adapt.	RPM max.	DU	INOX 0.20	INOX 0.30	INOX 0.35	INOX 0.50
250	55	45	100	AS-TE	3500	1			● 0042-576 375	
250	55	45	100	AS-TE	3600	1	● 0002-576 345			
250	65	45	100	AS-TE	3600	1		● 0042-576 365		● 0002-576 395

# Stationary Machines

## Wheel Bruhes



Appearance can vary from picture depending on variant.

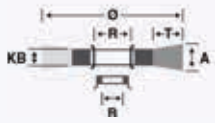

EUPBWB026 | SUPERIOR ★★☆☆☆

## Wheel brushes for table-deburring machines, abrasive filament

**Wheel brush with abrasive trim, industrial quality, for mounting on deburring machines.**

- Particularly dense and compact design with maximum number of bristles for high deburring performance and excellent service life
- Statically balanced with high level of concentricity accuracy
- Adaptions with double keyways and regular holes for all common table deburrers
- Special adapters possible on request

**Application:** Cutting edge deburring of pipes, profiles and flat parts on table deburrer and automated machines.

∅	A	T	R	Adapt.	RPM max.	DU	Silicon Carbide 80	Silicon Carbide 120	Silicon Carbide 180
250	65	45	100	AS-TE	3600	1	● 2102-576 916	● 0002-576 906	● 0002-576 916



Appearance can vary from picture depending on variant.



EUPBWB027 | EVOLUTION ★★★★★

## UNI-Master® wheel brushes, abrasive filament

Wheel brush with abrasive trim, industrial quality, for mounting on deburring machines.

- Particularly dense and compact design with maximum number of abrasive bristles for high deburring performance and excellent service life
- Statically balanced with high concentricity accuracy
- For dry and wet application
- Resistant to weak acids and bases
- Fitted individually or combined on shaft

**Application:** Cutting edge deburring of pipes, profiles and flat parts made of non-ferrous metals on table deburrer and automated machines.

∅	A	T	B	B Type	Adapt.	RPM max.	DU	Silicon Carbide 80	Silicon Carbide 120
75	12	15	15.88	round	HP	20000	6	● 9906-015 001	● 9906-015 002
100	13	20	15.88	round	HP	12000	6		● 9906-015 026
100	16	20	15.88	round	HP	12000	6	● 9906-015 025	
125	16	30	15.88	round	HP	12000	6	● 9906-015 035	● 9906-015 036
150	17	32	22.2	round	HP	8000	6	● 9906-015 079	
150	17	32.5	22.2	round	HP	8000	6		● 9906-015 080
178	20	47	22.2	round	HP	8000	2	● 9906-015 040	● 9906-015 041
200	18	35	50.8	turtle	4M	6000	2	● 9906-015 050	● 9906-015 051
250	18	35	50.8	turtle	4M	3000	2	● 9906-015 056	● 9906-015 057
250	18	60	50.8	turtle	4M	3600	2	● 9946-015 056	● 9946-015 057
300	18	35	50.8	turtle	4M	2400	2	● 9906-015 062	● 9906-015 063
300	18	60	50.8	turtle	4M	3000	2		● 9966-015 063
350	19	55	50.8	turtle	4M	2400	2		● 9906-015 069

∅	A	T	B	B Type	Adapt.	RPM max.	DU	Silicon Carbide 180	Silicon Carbide 320
75	12	15	15.88	round	HP	20000	6	● 9906-015 003	
75	12	15	16	round	HP	20000	6		● 9906-015 004
100	13	20	15.88	round	HP	12000	6		● 9906-015 028
100	16	20	15.87	round	HP	12000	6	● 9906-015 027	
125	16	30	15.87	round	HP	12000	6		● 9906-015 038
125	16	30	15.88	round	HP	12000	6	● 9906-015 037	
150	17	32	22.2	round	HP	8000	6	● 9906-015 081	● 9906-015 082
178	20	47	22.2	round	HP	8000	2	● 9906-015 042	● 9906-015 043
200	18	35	50.8	turtle	4M	6000	2	● 9906-015 052	● 9906-015 053
250	18	35	50.8	turtle	4M	3000	2	● 9906-015 058	● 9906-015 059
250	18	60	50.8	turtle	4M	3600	2	● 9946-015 058	● 9946-015 059
300	18	35	50.8	turtle	4M	2400	2	● 9906-015 064	● 9906-015 065
300	18	60	50.8	turtle	4M	3000	2	● 9966-015 064	● 9966-015 065
350	19	55	50.8	turtle	4M	2400	2	● 9906-015 070	● 9906-015 071

# Stationary Machines

## Wheel Bruhes



Appearance can vary from picture depending on variant.



EUPBWB028 | SUPERIOR ★★☆☆☆

## Wheel brushes, abrasive filament

**Wheel brush with abrasive bristles, industrial quality, for use on stationary machines.**

- Cost-effective finishing of components with many contours in dry applications
- Suitable for defined edge rounding
- NHS trim material - Also suitable for use with coolants

**Application:** Finishing of surfaces and pipe/profile sections, particularly good for aluminium, non-ferrous metals and synthetics.

**Please note:** For other bore sizes, refer to table "Standard Bores for Single-Row Brushes"

**9902-515 001** Suitable for use with coolants

**9902-515 025** Suitable for use with coolants

∅	A	T	B min.	B max.	B	RPM max.	DU	Silicon Carbide 80	Silicon Carbide 120
75	12	13	13	13	13	20000	6	● 9902-515 001	● 9902-515 002
100	18	18	13	20	13	12000	6	● 9902-515 025	● 9902-515 026
150	18	32	13	44	13	6000	6	● 9902-515 079	
150	18	32	13	44	13	8000	6		● 9902-515 080
178	18	45	13	32	13	8000	4	● 9902-515 040	● 9902-515 041
200	18	31	19	50.8	19	6000	2	● 9902-515 050	● 9902-515 051
250	18	60	20	50.8	20	3000	2	● 9962-515 056	● 9962-515 057
250	20	35	20	50.8	20	3600	2	● 9902-515 056	● 9902-515 057
300	20	35	20	50.8	20	2400	2	● 9902-515 062	● 9902-515 063
300	20	60	20	50.8	20	3000	2	● 9962-515 062	● 9962-515 063
350	20	57	32	50.8	32	2400	2		● 9902-515 069

∅	A	T	B min.	B max.	B	RPM max.	DU	Silicon Carbide 180	Silicon Carbide 320
75	12	13	13	13	13	20000	6	● 9902-515 003	● 9902-515 004
100	18	18	13	20	13	12000	6	● 9902-515 027	● 9902-515 028
150	18	32	13	32	13	6000	6		● 9902-515 082
150	18	32	13	44	13	6000	6	● 9902-515 081	
178	18	45	13	32	13	8000	4	● 9902-515 042	● 9902-515 043
200	18	31	19	50.8	19	6000	2	● 9902-515 052	● 9902-515 053
250	18	60	20	50.8	20	3000	2		● 9962-515 059
250	18	60	20	50.8	20	3600	2	● 9962-515 058	
250	20	35	20	50.8	20	3000	2	● 9902-515 058	
300	20	35	20	50.8	20	2400	2	● 9902-515 064	● 9902-515 065
300	20	60	20	50.8	20	3000	2	● 9962-515 064	● 9962-515 065



Appearance can vary from picture depending on variant.

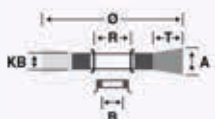

EUPBWB031 | XTREME ★★★★★

## Wheel brushes for table-deburring machines, Xtreme wire, crimped

Wheel brushes with crimped Xtreme wire in high-end quality for use on stationary machines.

- Particularly high wire density
- Aggressive design
- High deburring performance and outstanding tool life
- Adjustable immersion depth - adapts to the contours of complex components
- Fast and effective deburring of inner and outer edges of pipe ends in a single step

**Application:** For deburring the end faces of tubes, profiles and flat parts, edge deburring

∅	A	T	B	B Type	RPM max.	DU	Steel 0.30
250	60	53	50.8	keyways	3600	1	● 3902-576 175



Appearance can vary from picture depending on variant.



EUPBWB032 | XTREME ★★★★★

## UNI-Master® Wheel brushes, Xtreme wire, crimped

Wheel brush with crimped Xtreme wire in high-end quality for use on stationary machines.

- Higher removal rate, aggressive removal of burrs
- High wire density and very flexible at the same time
- Can be mounted individually or assembled on a shaft
- Excellently suited for machining geometrically complex components as the brush adapts to the contour of the workpiece

**Application:** Automated production processes for deburring of machined and sawn cutting edges and surfaces

∅	A	T	B	Adapt.	RPM max.	DU	Steel 0.30
250	26	60	50.8	4M	3600	2	● 3906-013 009
300	28	60	50.8	4M	3000	2	● 3906-013 021
380	32	72	50.8	4M	2400	2	● 3906-013 057



# Stationary Machines

## Roller Brushes



Appearance can vary from picture depending on variant.

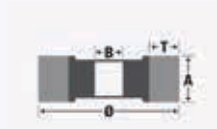

EUPBRB001 | SUPERIOR ★★★★★

## Roller brushes for deburring machines, crimped wire

**Roller brush with crimped wire, industrial quality, for use on deburring machines.**

- Dense and uniform trim distribution ensures homogeneous finish results; speedy and efficient deburring
- Long service life; therefore reduced tool and unit costs

**Application:** Deburring, weld seam finishing, rust/paint removal

**Please note:** Other circular and roller brushes for all popular deburring machines are available on request.

ø	A	T	B	RPM max.	DU	Steel 0.35	INOX 0.30
300	460	60	120	3600	1	● 4602-743 178	
300	600	60	120	3600	1	● 8802-753 478	● 1302-753 368



Appearance can vary from picture depending on variant.



EUPBEB015 | SUPERIOR ★★★★★

## End brushes for brush heads, crimped wire

**End brushes with crimped wire, high-end quality, for use in a brush head.**

- Long service life, so reduced tool costs
- For speedy and efficient working
- The eccentric and oscillating circular motion increases the working radius of the brush
- For all profile contours

**Application:** Deburring of the cutting edges of pipe ends and profiles, and surface deburring with eccentric and oscillating circular motion.

ø	T	L	DU	INOX 0.20	Steel 0.20
25	95	25	16	● 0002-509 348	● 0002-509 448

ø	T	L	DU	Steel 0.35	Steel 0.50
25	95	25	16	● 0002-509 478	● 0002-509 498



EUACAD006

## Axis discs

Axis discs for table deburring machines.

Appearance can vary from picture depending on variant.

adapt. from	adapt. to	DU	Item Number
100.00	50.80	1	● 5495-560 051
100.00	52.90	1	● 5495-560 052
100.00	54.70	1	● 5495-560 054
100.00	80.20	1	● 5495-560 080
100.00	82.00	1	● 5495-560 082



EUACAD007

## 4-M adapters for tortoise-shape bores

4-M adapters for the bore reduction of narrow wheel brushes with 2" / 50.8 mm turtle-shape bore. Reusable.

Appearance can vary from picture depending on variant.

adapt. from	adapt. to	DU	Item Number
50.80	19.05	1	● 0003-075 066
50.80	22.20	1	● 0003-075 067
50.80	25.40	1	● 0003-075 068
50.80	28.00	1	● 0003-075 069

# Stationary Machines

## Accessories



EUACAD008

## Reducing Ring "HP-Adapter"

Reducing Rings provide a reliable solution for precisely adapting standard bore sizes to smaller diameters.

Appearance can vary from picture depending on variant.

adapt. from	adapt. to	DU	Item Number
16.00	9.50	1	● 0003-000 222
16.00	12.70	1	● 0003-000 223
22.20	9.50	1	● 0003-000 242
22.20	12.70	1	● 0003-000 243
22.20	16.00	1	● 0003-000 244



Appearance can vary from picture depending on variant.

EUACAD004

## Interchangeable metal adapters

**1-A metal adapter interchangeable for reduction of arbor holes from bore 50,8 (2") to bore 12,7 (1/2"). Metal adapter 3-A for reducing the bore from 31,75 (1-1/4") to 13.**

- Contains 1 pair = 2 pieces
- Reusable

Adapt.	adapt. from	adapt. to	DU	Item Number
1A	50.80	12.70	1	● 0103-075 021
1A	50.80	31.75	1	● 0103-075 027
1A	50.80	38.00	1	● 0103-075 028
3A	31.75	12.70	1	● 0103-075 048
3A	31.75	19.00	1	● 0103-075 050
3A	31.75	22.20	1	● 0103-075 051
1A	50.80	10.00	1	● 0103-075 210
1A	50.80	13.00	1	● 0103-075 213
1A	50.80	16.00	1	● 0103-075 216
1A	50.80	20.00	1	● 0103-075 220
1A	50.80	25.00	1	● 0103-075 225
1A	50.80	30.00	1	● 0103-075 230
1A	50.80	32.00	1	● 0103-075 232
1A	50.80	35.00	1	● 0103-075 235
1A	50.80	40.00	1	● 0103-075 240
3A	31.75	13.00	1	● 0103-075 313
3A	31.75	16.00	1	● 0103-075 316
3A	31.75	20.00	1	● 0103-075 320
3A	31.75	25.00	1	● 0103-075 325

<b>0</b>	0002505341 .... 52, 52	0002509564 .... 60, 60	0002608184 ..... 22
0002501132 .... 51, 51	0002505342 .... 52, 52	0002511161 ..... 91	0002608185 ..... 22
0002501142 .... 51, 51	0002505343 .... 52, 52	0002512061 ..... 32	0002608331 ..... 21
0002501143 .... 51, 51	0002505361 .... 52, 52	0002512062 ..... 32	0002608333 ..... 22
0002501342 .... 52, 52	0002505362 .... 52, 52	0002512161 ..... 32	0002608334 ..... 22
0002501343 .... 52, 52	0002505363 .... 52, 52	0002512162 ..... 32	0002608351 ..... 21
0002501542 .... 52, 52	0002505542 .... 52, 52	0002512342 ..... 32	0002608353 ..... 22
0002502132 .... 51, 51	0002506132 .... 51, 51	0002512361 ..... 32	0002608354 ..... 22
0002502141 .... 51, 51	0002506141 .... 51, 51	0002512362 ..... 32	0002611131 ..... 16
0002502142 .... 51, 51	0002506142 .... 51, 51	0002514161 ..... 32	0002611151 ..... 16
0002502143 .... 51, 51	0002506143 .... 51, 51	0002514361 ..... 32	0002613141 ..... 24
0002502332 .... 52, 52	0002506161 .... 51, 51	0002522141 ..... 91	0002613142 ..... 24
0002502333 .... 52, 52	0002506162 .... 51, 51	0002522161 ..... 91	0002613143 ..... 25
0002502341 .... 52, 52	0002506163 .... 51, 51	0002522341 ..... 91	0002613144 ..... 25
0002502342 .... 52, 52	0002506332 .... 52, 52	0002522361 ..... 91	0002613145 ..... 25
0002502343 .... 52, 52	0002506341 .... 52, 52	0002532161 ..... 91	0002613146 ..... 25
0002502542 .... 52, 52	0002506342 .... 52, 52	0002532361 ..... 91	0002613161 ..... 24
0002503132 .... 51, 51	0002506343 .... 52, 52	0002544141 ..... 91	0002613162 ..... 24
0002503141 .... 51, 51	0002506361 .... 52, 52	0002544161 ..... 91	0002613163 ..... 25
0002503142 .... 51, 51	0002506362 .... 52, 52	0002544341 ..... 91	0002613164 ..... 25
0002503143 .... 51, 51	0002506363 .... 52, 52	0002544361 ..... 91	0002613165 ..... 25
0002503331 .... 52, 52	0002506542 .... 52, 52	0002554141 ..... 91	0002613166 ..... 25
0002503332 .... 52, 52	0002507142 .... 51, 51	0002554161 ..... 91	0002613193 ..... 25
0002503333 .... 52, 52	0002507162 .... 51, 51	0002554341 ..... 91	0002613194 ..... 25
0002503341 .... 52, 52	0002507342 .... 52, 52	0002554361 ..... 91	0002613195 ..... 25
0002503342 .... 52, 52	0002507361 .... 52, 52	0002566141 ..... 91	0002613196 ..... 25
0002503343 .... 52, 52	0002507362 .... 52, 52	0002566161 ..... 91	0002613361 ..... 24
0002503542 .... 52, 52	0002507542 .... 52, 52	0002566361 ..... 91	0002613362 ..... 24
0002504132 .... 51, 51	0002509142 .... 60, 60	0002576141 ..... 91	0002613363 ..... 25
0002504141 .... 51, 51	0002509143 .... 60, 60	0002576145 ..... 97	0002613364 ..... 25
0002504142 .... 51, 51	0002509144 .... 60, 60	0002576161 ..... 91	0002613365 ..... 25
0002504143 .... 51, 51	0002509162 .... 60, 60	0002576195 ..... 97	0002621131 ..... 16
0002504161 .... 51, 51	0002509163 .... 60, 60	0002576341 ..... 91	0002621151 ..... 16
0002504162 .... 51, 51	0002509164 .... 60, 60	0002576345 ..... 97	0002621351 ..... 16
0002504163 .... 51, 51	0002509165 ..... 78	0002576361 ..... 91	0002622131 ..... 30
0002504332 .... 52, 52	0002509167 ..... 78	0002576395 ..... 97	0002622151 ..... 30
0002504341 .... 52, 52	0002509192 .... 60, 60	0002576906 ..... 98	0002622331 ..... 30
0002504342 .... 52, 52	0002509193 .... 60, 60	0002576916 ..... 98	0002622351 ..... 30
0002504343 .... 52, 52	0002509194 .... 60, 60	0002586175 ..... 97	0002623131 ..... 30
0002504361 .... 52, 52	0002509342 .... 60, 60	0002587161 ..... 91	0002626061 ..... 18
0002504362 .... 52, 52	0002509343 .... 60, 60	0002587162 ..... 94	0002626251 ..... 18
0002504363 .... 52, 52	0002509344 .... 60, 60	0002587341 ..... 91	0002626650 ..... 18
0002504542 .... 52, 52	0002509348 ..... 102	0002608131 ..... 21	0002626651 ..... 18
0002505132 .... 51, 51	0002509362 .... 60, 60	0002608133 ..... 22	0002630304 ..... 75
0002505141 .... 51, 51	0002509363 .... 60, 60	0002608134 ..... 22	0002630305 ..... 75
0002505142 .... 51, 51	0002509364 .... 60, 60	0002608135 ..... 22	0002630310 ..... 75
0002505143 .... 51, 51	0002509448 ..... 102	0002608151 ..... 21	0002630311 ..... 75
0002505161 .... 51, 51	0002509478 ..... 102	0002608153 ..... 22	0002630316 ..... 75
0002505162 .... 51, 51	0002509498 ..... 102	0002608154 ..... 22	0002630317 ..... 75
0002505163 .... 51, 51	0002509562 .... 60, 60	0002608155 ..... 22	0002630328 ..... 75
0002505332 .... 52, 52	0002509563 .... 60, 60	0002608183 ..... 22	0002630334 ..... 75

0002630335	75	0003509191	60, 60	0024509103	78	0083003015	80
0002630340	75	0003509341	60, 60	0024509111	78	0083004015	80
0002630341	75	0003509349	77	0028600041	57	0083004020	80
0002631131	16	0003509361	60, 60	0028600061	57	0083004030	80
0002631151	16	0003509369	77	0042576165	97	0083005015	80
0002631331	16	0003509561	60, 60	0042576175	97	0083005020	80
0002631351	16	0003515827	92	0042576365	97	0083005030	80
0002632131	30	0003600211	53	0042576375	97	0083006020	80
0002632151	30	0003600311	53	0043003010	80	0083006030	80
0002632331	30	0004000127	67	0043003015	80	0083006040	80
0002632351	30	0004401052	65	0043004015	80	0083008030	80
0002641131	16	0004401132	65	0043004020	80	0083008040	80
0002641151	16	0004401942	66	0043005015	80	0083008050	80
0002641181	16	0004509302	79	0043005020	80	0083010100	84
0002641351	16	0008509061	61	0043005030	80	0083304020	82
0002653131	16	0008509062	61	0043006020	80	0083304030	82
0002653151	16	0008509063	61	0043006030	80	0083305030	82
0002653181	16	0008509064	61	0043006040	80	0083305040	82
0002653351	16	0008509161	61	0043006050	80	0083306030	82
0002664131	89	0008509162	61	0043008030	80	0083308050	82
0002664151	89	0008509163	61	0043008050	80	0083310100	85
0002664152	89	0008509164	61	0043010100	84	0083404020	81
0002664181	89	0008509363	61	0063003010	80	0083405030	81
0002676131	89	0008600010	53	0063003015	80	0083406040	81
0002676151	89	0008600051	53	0063004015	80	0083408050	81
0002676181	89	0008600075	53	0063004020	80	0083410100	84
0002686131	89	0008600221	53	0063004030	80	0088600221	53
0002686151	89	0008600321	53	0063005015	80	0088600521	53
0002686181	89	0008600361	57	0063005020	80	0102512161	32
0002911941	54	0008600411	53	0063005030	80	0102512162	32
0002911951	54	0008600421	53	0063006020	80	0102512342	32
0002921874	19	0008600422	53	0063006030	80	0102512362	32
0002921875	19	0008600432	53	0063006040	80	0102608131	21
0002930821	58	0008600511	53	0063006050	80	0102608151	21
0002930902	62	0008600521	53	0063008030	80	0102608331	21
0002930907	62	0008600522	53	0063008040	80	0102608351	21
0002930912	62	0008600531	53	0063008050	80	0102613142	24
0003000100	67	0008600811	57	0063010100	84	0102613161	24
0003000222	47, 47	0008600821	57	0063404020	81	0102613162	24
0003000223	47, 47	0008600831	57	0063404030	81	0102622131	30
0003000242	47, 47	0008600832	57	0063405020	81	0102622151	30
0003000243	47, 47	0008600911	57	0063405030	81	0102622331	30
0003000244	47, 47	0008600921	57	0063405040	81	0102622351	30
0003075066	103	0011401912	65	0063406030	81	0103075021	105
0003075067	103	0014509102	78	0063406040	81	0103075027	105
0003075068	103	0014509304	79	0063406050	81	0103075028	105
0003075069	103	0023600851	57	0063408040	81	0103075048	105
0003509141	60, 60	0023600951	57	0063408050	81	0103075050	105
0003509149	77	0024509100	79	0063410100	84	0103075051	105
0003509161	60, 60	0024509101	78	0074509301	79	0103075210	105
0003509169	77	0024509102	78	0083003010	80	0103075213	105

0103075216	105	0153406040	81	0802608133	22	1402631351	16
0103075220	105	0153408040	81	0802608134	22	1418600005	66
0103075225	105	0153408050	81	0802608135	22	1518600005	67
0103075230	105	0182600491	55	0802608153	22	1602608131	21
0103075232	105	0182600591	55	0802608154	22	1602608151	21
0103075235	105	0182600891	59	0802608155	22	1602608331	21
0103075240	105	0182600991	59	0802608183	22	1602613162	24
0103075313	105	0183004015	80	0802608184	22	1602613361	24
0103075316	105	0183005030	80	0802608185	22	1802509911	63
0103075320	105	0183006020	80	0802613142	24	1802509912	63
0103075325	105	0183006030	80	0802613144	25	1802509913	63
0123003010	80	0183006040	80	0802613162	24	1802509914	63
0123003015	80	0183006050	80	0802613164	25	1802607914	28
0123004020	80	0183008050	80	0802613165	25	1812509913	64
0123004030	80	0183310100	85	0802613166	25	<b>2</b>	
0123005015	80	0202611131	50, 50	0802613194	25	2008512061	33
0123005020	80	0202611151	50, 50	0802613195	25	2008512161	33
0123005030	80	0202611351	50, 50	0802613196	25	2008608131	23
0123006020	80	0224509101	79	0802613362	24	2008608151	23
0123006030	80	0243003010	80	0802613363	25	2008608152	23
0123006040	80	0243003015	80	0802613364	25	2008608153	23
0123008030	80	0243004015	80	0802632131	30	2008608154	23
0123008050	80	0243004020	80	0802632151	30	2008613061	26
0123010100	84	0243005030	80	0812509913	64	2008613062	26
0123410100	84	0243006020	80	0908507061	54	2008613063	26
0124509101	79	0243006030	80	<b>1</b>		2008613064	26
0124509103	79	0243006040	80	1004608151	56	2008613065	26
0124509111	79	0243006050	80	1202509912	63	2008613161	26
0124509303	79	0243008040	80	1202509913	63	2008613162	26
0153003015	80	0243008050	80	1202509914	63	2008613163	26
0153004020	80	0243304020	82	1202631131	17	2008613164	26
0153005015	80	0243304030	82	1202631151	17	2008613165	26
0153005020	80	0243305030	82	1202653131	17	2008622151	31
0153005030	80	0243305040	82	1202653151	17	2008631151	17
0153006020	80	0243306030	82	1212631131	17	2102576916	98
0153006030	80	0243306050	82	1212631151	17	2118631151	17
0153006040	80	0243308050	82	1224509101	78	2202631151	16
0153006050	80	0283310100	85	1243404020	81	2202631331	16
0153008040	80	0323304020	82	1243404030	81	2202631351	16
0153304020	82	0323305030	82	1243405020	81	2224509101	79
0153304030	82	0323305040	82	1243405030	81	2312607914	28
0153305030	82	0323306030	82	1243405040	81	2352512161	32
0153305040	82	0402631131	16	1243406030	81	2352512342	32
0153306030	82	0402631151	16	1243406040	81	2352512362	32
0153306050	82	0402631331	16	1243406050	81	2352608131	21
0153308050	82	0402631351	16	1243408040	81	2352608151	21
0153404020	81	0502600451	53	1243408050	81	2352608331	21
0153404030	81	0802600491	55	1302753368	102	2352622151	30
0153405020	81	0802600591	55	1402631131	16	2352622351	30
0153405030	81	0802600891	59	1402631151	16	2812522051	19
0153406030	81	0802600991	59	1402631331	16	2902632151	30

2906026501 .....	18	5231006100 .....	39	5411401913 .....	20	7003600911 .....	57
<b>3</b>		5231007100 .....	39	5421401913 .....	20	7003600921 .....	57
3002504342 ....	52, 52	5231009100 .....	39	5495560051 .....	103	7004401132 .....	65
3202509911 .....	63	5231184100 .....	40	5495560052 .....	103	7004608151 .....	56
3202509912 .....	63	5231186100 .....	40	5495560054 .....	103	7008509363 .....	61
3202509913 .....	63	5231187100 .....	40	5495560080 .....	103	7008600361 .....	57
3202509914 .....	63	5231204100 .....	39	5495560082 .....	103	7008600432 .....	53
3602632131 .....	30	5231206100 .....	39	5541204100 .....	45	7008600832 .....	57
3602632331 .....	30	5231207100 .....	39	5541206100 .....	45	7012611351 ....	50, 50
3602632351 .....	30	5231384100 .....	40	5541207100 .....	46	7018600521 .....	53
3892608131 .....	21	5231386100 .....	40	5541220100 .....	46	7023600451 .....	53
3902504162 .....	72	5231387100 .....	40	5542204100 .....	45	7182600491 .....	55
3902506162 .....	72	5232004100 .....	39	5542206100 .....	45	7182600591 .....	55
3902512161 .....	33	5232006100 .....	39	5542207100 .....	46	7182600891 .....	59
3902576175 .....	101	5232007100 .....	39	5542220100 .....	46	7182600991 .....	59
3902613161 .....	27	5232009100 .....	39	5652613142 .....	24	7202611151 ....	50, 50
3902613163 .....	27	5232184100 .....	40	<b>6</b>		7602504142 ....	51, 51
3902613164 .....	27	5232186100 .....	40	6152631131 .....	16	7602506162 ....	51, 51
3906013009 .....	101	5232187100 .....	40	6700001100 .....	38	7702921875 .....	19
3906013021 .....	101	5232204100 .....	39	6700002100 .....	38	7801401912 .....	65
3906013057 .....	101	5232206100 .....	39	6700003100 .....	38	7802509913 .....	64
3912613163 .....	27	5232207100 .....	39	6912613561 .....	35	7802600491 .....	55
<b>4</b>		5232384100 .....	40	6912613891 .....	36	7802600591 .....	55
4102921051 .....	19	5232386100 .....	40	6912622891 .....	37	7802600891 .....	59
4306026904 .....	16	5232387100 .....	40	<b>7</b>		7802600991 .....	59
4602626131 .....	16	5241104100 .....	41	7002503142 ....	51, 51	7811401912 .....	65
4602743178 .....	102	5241106100 .....	41	7002503342 ....	52, 52	7812509913 .....	64
4612626331 .....	16	5241107100 .....	41	7002504362 ....	52, 52	7902613196 .....	29
4802622131 .....	30	52411304100 .....	41	7002505142 ....	51, 51	7922613196 .....	29
4802622331 .....	30	5241306100 .....	41	7002505162 ....	51, 51	7932613196 .....	29
4902613561 .....	24	5241307100 .....	41	7002505342 ....	52, 52	7942613196 ....	29
4902613562 .....	24	5241434100 .....	43	7002505362 ....	52, 52	<b>8</b>	
4902613563 .....	25	5241436100 .....	43	7002505542 ....	52, 52	8802753478 .....	102
4912613561 .....	24	5241437100 .....	43	7002506362 ....	52, 52	8812607914 .....	28
<b>5</b>		5241444100 .....	43	7002506542 ....	52, 52	<b>9</b>	
5162507361 ....	52, 52	5241446100 .....	43	7002507162 ....	51, 51	9301614916 .....	28
5211104100 .....	42	5241447100 .....	43	7002507342 ....	52, 52	9311614916 .....	28
5211106100 .....	42	5242104100 .....	41	7002507362 ....	52, 52	9321614916 .....	28
5211107100 .....	42	5242106100 .....	41	7002509162 ....	60, 60	9331614916 .....	28
5211109100 .....	42	5242107100 .....	41	7002509163 .....	61	9502626251 .....	16
5211304100 .....	42	5242304100 .....	41	7002509164 ....	60, 60	9502626301 .....	16
5211306100 .....	42	5242306100 .....	41	7002630305 .....	75	9502626311 .....	16
5211307100 .....	42	5242307100 .....	41	7002911941 .....	54	9502626501 .....	16
5212104100 .....	42	5242434100 .....	43	7003507061 .....	54	9502626651 .....	16
5212106100 .....	42	5242436100 .....	43	7003600221 .....	53	9502664151 .....	16
5212107100 .....	42	5242437100 .....	43	7003600321 .....	53	9706026904 .....	18
5212109100 .....	42	5242444100 .....	43	7003600411 .....	53	9802026560 .....	90
5212304100 .....	42	5242446100 .....	43	7003600421 .....	53	9802026561 .....	90
5212306100 .....	42	5242447100 .....	43	7003600511 .....	53	9802026562 .....	90
5212307100 .....	42	5401401913 .....	20	7003600521 .....	53	9802026563 .....	90
5231004100 .....	39	5402921873 .....	18	7003600821 .....	57	9802026581 .....	90



9802026582	90	9902532363	95	9902575163	96	9906015037	99
9802026583	90	9902543142	96	9902575342	96	9906015038	99
9802921873	18	9902543162	96	9902576142	94	9906015040	99
9802921875	18	9902543362	96	9902576143	94	9906015041	99
9803630101	77	9902543542	96	9902576162	94	9906015042	99
9803630151	77	9902543543	96	9902576163	94	9906015043	99
9803630171	77	9902543562	96	9902576192	94	9906015050	99
9803630301	77	9902543563	96	9902576193	94	9906015051	99
9803630351	77	9902544142	94	9902576342	95	9906015052	99
9803630371	77	9902544162	94	9902576343	95	9906015053	99
9902511162	94	9902544163	94	9902576362	95	9906015056	99
9902511362	95	9902544193	94	9902576363	95	9906015057	99
9902515001	100	9902544341	95	9902576464	94	9906015058	99
9902515002	100	9902544342	95	9902586142	96	9906015059	99
9902515003	100	9902544361	95	9902586162	96	9906015062	99
9902515004	100	9902544362	95	9902586163	96	9906015063	99
9902515025	100	9902544441	94	9902586342	96	9906015064	99
9902515026	100	9902544461	94	9902586343	96	9906015065	99
9902515027	100	9902544491	94	9902587142	94	9906015069	99
9902515028	100	9902553162	96	9902587143	94	9906015070	99
9902515040	100	9902554142	94	9902587162	94	9906015071	99
9902515041	100	9902554162	94	9902587163	94	9906015079	99
9902515042	100	9902554163	94	9902587192	94	9906015080	99
9902515043	100	9902554192	94	9902587193	94	9906015081	99
9902515050	100	9902554341	95	9902587342	95	9906015082	99
9902515051	100	9902554361	95	9902587343	95	9906021059	93
9902515052	100	9902554362	95	9902587362	95	9906021183	93
9902515053	100	9902554441	94	9902587363	95	9906021184	93
9902515056	100	9902554461	94	9906011146	73	9906022081	93
9902515057	100	9902565142	96	9906011147	73	9906022082	93
9902515058	100	9902565162	96	9906011148	73	9906022085	93
9902515062	100	9902565163	96	9906011149	73	9906026011	18
9902515063	100	9902565362	96	9906011150	73	9906026051	18
9902515064	100	9902565542	96	9906011151	73	9906026116	18
9902515065	100	9902565562	96	9906011153	73	9906026117	18
9902515069	100	9902566142	94	9906011154	73	9906026247	18
9902515079	100	9902566143	94	9906011155	73	9906026500	18
9902515080	100	9902566162	94	9906013008	93	9906026501	18
9902515081	100	9902566163	94	9906013009	93	9906030302	76
9902515082	100	9902566192	94	9906013021	93	9906030304	76
9902522142	94	9902566193	94	9906013057	93	9906030305	76
9902522162	94	9902566341	95	9906015001	99	9906030308	76
9902522163	94	9902566342	95	9906015002	99	9906030310	76
9902522342	95	9902566361	95	9906015003	99	9906030311	76
9902522362	95	9902566362	95	9906015004	99	9906030312	76
9902522363	95	9902566363	95	9906015025	99	9906030314	76
9902532142	94	9902566441	94	9906015026	99	9906030316	76
9902532162	94	9902566461	94	9906015027	99	9906030317	76
9902532163	94	9902566491	94	9906015028	99	9906030318	76
9902532342	95	9902575142	96	9906015035	99	9906030326	76
9902532362	95	9902575162	96	9906015036	99	9906030328	76

## SKU Index

---

9906030329 .....	76	9906030492 .....	79	9906033126 .....	23	9962515059 .....	100
9906030332 .....	76	9906030493 .....	79	9908608132 .....	22	9962515062 .....	100
9906030334 .....	76	9906030494 .....	79	9908608152 .....	22	9962515063 .....	100
9906030335 .....	76	9906030496 .....	79	9946015056 .....	99	9962515064 .....	100
9906030338 .....	76	9906030497 .....	79	9946015057 .....	99	9962515065 .....	100
9906030340 .....	76	9906030498 .....	79	9946015058 .....	99	9966015063 .....	99
9906030341 .....	76	9906030500 .....	79	9946015059 .....	99	9966015064 .....	99
9906030488 .....	79	9906030501 .....	79	9962515056 .....	100	9966015065 .....	99
9906030489 .....	79	9906030502 .....	79	9962515057 .....	100		
9906030490 .....	79	9906033125 .....	23	9962515058 .....	100		

## **Finish. First.**

The Global Leader in Surface Treatment Solutions and Finishing Tools

Osborn GmbH  
Ringstraße 10  
35099 Burgwald  
Germany

Phone: +49 (0)6451 588-0

Fax: +49 (0)6451 588-206

[info@osborn.de](mailto:info@osborn.de)

**[www.osborn.com](http://www.osborn.com)**

### General

The tools shown in this catalogue, and the information on delivery scopes, appearances, performances and dimensions, correspond to information available at the time of print. We are enhancing our products continually. We reserve the right to make changes to products and prices.

In the event prices are printed in the catalogue, all previous price lists are rendered void on publication of this catalogue. All prices are recommended retail prices in Euro per piece. VAT, packaging, transport/postal charges and insurance are extra. Our general terms and conditions apply for all orders.

Print date: 04.11.2024



[osborn.com](http://osborn.com)