



Tools for Angle Grinders

Product Catalog

Osborn worldwide



Osborn offers the best solutions for your mechanical surface treatment challenges. Our experts are highly trained to serve you with the best off-the-shelf or customized tools, when and where you need them. Unlike others, we help you optimize your process, meet the highest quality and safety requirements and reduce your costs.

General Information	4
Angle Grinders	9
SKU Index	44

General Information

For efficient and safe deployment, always select the maximum possible brush diameter that can be fitted on the drive unit.

Because the circumferential speed is defined by the brush diameter, as mentioned above under working speeds, the performance of a brush can also be changed with this factor.

The following table provides an overview:

Remember the following before fitting a brush:

- The speed of the drive shaft of your machine must not exceed the maximum safety speed of the brush.
- The length of the drive shaft must fit firmly in the chuck.
- Brushes with clamp shaft can easily be fitted into standard drill chucks or collet chucks.
- The connecting threads of brushes have spanner flats, guaranteeing easy fitting and removal.

RPM min-1	Brush diameters (in mm)											
	20	40	50	80	100	125	150	180	200	250	300	350
800				3.35	4.19	5.23	6.28	7.53	8.37	10.47	12.56	14.75
900			2.35	3.77	4.71	5.88	7.06	8.48	9.41	11.77	14.12	16.47
1,150			3.01	4.81	6.01	7.52	9.02	10.83	12.03	15.04	18.04	21.04
1,200	1.25	2.51	3.14	5.02	6.28	7.85	9.41	11.30	12.55	15.69	18.83	21.97
1,400	1.46	2.93	3.66	5.86	7.32	9.15	10.98	13.18	14.64	18.31	21.97	25.63
1,500	1.57	3.14	3.92	6.28	7.85	9.81	11.77	14.13	15.69	19.61	23.54	27.46
1,800	1.88	3.77	4.71	7.54	9.41	11.77	14.12	16.95	18.83	23.54	28.24	32.95
2,000	2.09	4.19	5.23	8.37	10.26	13.08	15.69	18.84	20.92	26.15	31.38	36.61
2,500	2.62	5.23	6.54	10.47	13.08	16.35	19.61	23.55	26.15	32.67	39.23	45.76
2,800	2.93	5.86	7.32	11.72	14.64	18.31	21.97	26.37	29.29	36.61	43.93	51.25
3,000	3.14	6.28	7.85	12.56	15.69	19.62	23.54	28.26	31.38	39.23	47.07	54.92
3,200	3.35	6.70	8.37	13.40	16.74	20.92	25.10	30.14	33.47	41.84	50.12	58.58
3,500	3.66	7.33	9.15	14.65	18.31	22.89	27.46	32.97	36.61	45.76	54.92	64.07
4,000	4.19	8.37	10.46	16.75	20.92	26.16	31.38	37.68	41.84	52.33	62.76	73.22
4,500	4.70	9.42	11.77	18.84	23.54	29.43	35.30	42.40	47.07	58.84	70.61	82.43
5,000	5.23	10.47	13.08	20.93	26.15	32.70	39.23	47.10	52.33	65.38	78.50	
5,400	5.65	11.30	14.12	22.94	28.24	35.31	42.36	50.67	56.48	70.61	84.78	
6,000	6.28	12.56	15.69	25.12	31.38	39.24	47.07	56.52	62.76	78.50		
7,000	7.33	14.66	18.31	29.31	36.61	45.78	54.92	65.94	73.22	91.58		
8,000	8.37	16.75	20.92	33.94	41.48	52.32	62.76	75.36	83.73			
9,000	9.42	18.84	23.54	37.68	47.07	58.86	70.61	84.78	94.20			
10,000	10.47	20.93	26.17	41.86	52.33	65.40	78.50	94.20				
12,500	13.08	26.17	32.71	52.33	65.42	81.75	98.13					
15,000	15.70	31.40	39.25	62.80								
17,500	18.32	36.63	45.79	73.26								
20,000	20.93	41.87	52.33	83.73								
22,500	23.55	47.10	58.88	94.20								
25,000	26.17	52.33	65.42	104.66								

Technical information & safety information for brushes



Working and clamping width of a brush

The working width defines the contact surface between brush and workpiece. To measure the working width, gently press together the trim area. The clamping width is measured between the cover plates. For products without cover plates, the clamping width corresponds to the body width.



Working and safety speeds

The maximum safety speed must be observed in line with workplace safety requirements. Information is in the product overview in this catalogue, on the packaging and on the brush itself (see picture). The working speed is defined by factors circumferential speed and brush diameter. The optimum working speed is generally far below the safety speed.



Brush diameter and trim length

The diameter of the brush (body of the brush) and the length of the respective trim are the determining factors for the working characteristics of the brush. Generally applicable:

- **Soft, flexible brushes,**
e.g. for working with textured workpieces and for gentle surface finishing.
- **More aggressive brushes,**
e.g. for deburring or removing dirt.



Optimal positioning of the brush in relation to the workpiece

One of the factors defining the contact pressure of a brush is its penetration depth at the workpiece. Never press a brush into the workpiece and only work with the tips of the filament. Excessive contact pressure lowers the brush performance and expedites wear. For manually operated machines, the recommendation is to only work with the weight of the machine. For an abrasive trim, a filament diameter of 3 times applies, e.g. 1.0 mm penetration depth for a filament diameter of 0.35 mm.

We will be glad to help out if you have questions.



Filament density of brushes

The filament density is determined by the number of filament tips per surface unit. High filament densities optimise cutting performance and useful lives (for deburring work for example). Lower filament densities increase the flexibility of the brushes and are the prerequisite for processing strongly profiled surfaces.

Fill Materials. Types and Usage.

For our tools, we only use filling materials developed in our house or selected specially. Regular quality tests in our R&D labs guarantee highest material quality at all times. Below you find pictures of all the facing materials used for the tools in this catalog. The table shows the properties of all fill materials used by Osborn.



Steel wire



Stainless steel wire



Osborn special steel wire



Cordwire



Brass-coated steel wire



Brass wire

Material	Property	Additional Properties	Benefits	Used on
Steel wire	straight or flat	Most common trim material for brushes	<ul style="list-style-type: none"> Dimensionally stable Diversity of applications 	Steel, cast iron, softwood, hardwood
	crimped			Steel, cast steel
	knotted			
Stainless steel wire	straight	Standard alloys: 1.4310 and 1.4401 (1.4571 on request)	<ul style="list-style-type: none"> Usage in particular where residues of steel wires would adversely affect the surface (such as rust spots) 	Stainless steel, non-ferrous metals, aluminium
	crimped			
	knotted			
Osborn special steel wire	straight		<ul style="list-style-type: none"> High-performance wire with high tensile strength Long service life For extreme brush applications 	Steel, cast iron, softwood, hardwood
	crimped			
	knotted			
XTREME wire (steel wire)	stranded		<ul style="list-style-type: none"> Extremely long life Combines the benefits of crimped and knotted wire 	Steel, cast iron, softwood, hardwood
Brass-coated steel wire	Mono wire	stranded	<ul style="list-style-type: none"> High tensile strength 	Steel, cast iron, softwood, hardwood
	Cordwire		<ul style="list-style-type: none"> Particularly well suited to texturing wood 	
Brass wire	crimped			Non-ferrous metals, softwood

General Information



Abrasive bristle

Novofil®

Material	Property	Additional Properties	Benefits	Used on
Synthetic bristles	straight		<ul style="list-style-type: none"> ■ Abrasion-resistant ■ Resistant to weak acids and bases ■ Flexible 	Steel, cast iron, stainless steel, non-ferrous metals, aluminium
Abrasive bristle	Aluminium oxide	Nylon threads with aluminium oxide; red trim material	<ul style="list-style-type: none"> ■ High elasticity without risk of breakage ■ Uniform abrasive effect 	Steel, cast iron, stainless steel, non-ferrous metals, aluminium, wood
	Silicone carbide	Nylon threads with silicone carbide; blue trim material.	<ul style="list-style-type: none"> ■ High elasticity without risk of breakage ■ Uniform abrasive effect 	
	Ceramic, sintered twice	Aluminium oxide sintered twice; available in different hardness grades, light grey trim material	<ul style="list-style-type: none"> ■ Particularly hard and aggressive abrasive grit ■ The abrasive grit released during brushing has a better breaking edge and makes possible faster, more efficient deburring ■ Perfect results through uniform, homogeneous abrasive effect 	Steel, cast iron, stainless steel, non-ferrous metals, aluminium
Novofil®	round	High temperature resistance; available with different hardness, grit and filament thicknesses; abrasive can be made of chromium oxide, silicone carbide, aluminium oxide, zirconium, diamond or nylon resistant to extreme heat.	<ul style="list-style-type: none"> ■ High flexibility and trim density, prolonged life ■ For working with workpieces particular high in contours 	Steel, cast iron, stainless steel, non-ferrous metals, aluminium
	flat		<ul style="list-style-type: none"> ■ Very high abrasive grit content, higher removal rate (approx. 50% lower processing time) ■ Ideal for honing 	
Novoflex-B®	spherical	Trim material with aluminium oxide or silicone carbide; grit sizes from 60 to 400 possible	<ul style="list-style-type: none"> ■ Abrasive balls on flexible design ■ Tool is self-centring 	Steel, cast iron, stainless steel, non-ferrous metals, aluminium

Angle Grinders

Wheel Brushes	12
Cup Brushes	17
Bevel Brushes	26
Tools for Cordless Machines	30
Coarse Cleaning Fleece	34
Flap Discs for Grinding	35
Flap Discs for Polishing	40
Accessoires	43

Angle Grinders

Technical and General Information

Brushes for Angle Grinders. Important user information.

Determining the maximum working speed

The maximum working speed of a brush is dependent on its diameter. The wider the diameter of a brush, the lower the maximum working speed. The maximum working speed has a relevance to safety. It must never be exceeded. This information is on the brush itself. Additionally you will find below an aid for the most popular angle grinder sizes with their maximum speeds.

Angle grinder size (mm)	115 mm	125mm	150 mm	180 mm	230 mm
Angle grinder size (in)	4 1/2"	5"	6"	7"	9"
Max. working speed	12,500 min ⁻¹	12,500 min ⁻¹	8,500 min ⁻¹	8,500 min ⁻¹	6,500 min ⁻¹

Which brush is used on which angle grinder?



Not every brush can be fitted to every angle grinder. There are safety specifications for this too. To get the best out of your device and brush, please use the angle grinder sizes specified here for the respective brush (refer to the table).

Important: You must on no account use a smaller angle grinder size than specified here. For our retail packs, the suitable angle grinder size is generally on the packaging itself, with symbol.

Brush	Filament	Brush diameter in mm													
		60	65	75	80	90	100	115	120	125	130	140	150	178	230
Wheel brush	knotted						115	115		125			150	180	230
	crimped						115	115							
	abrasive										150*	150*			
Bevel brush	knotted						115	115		125					
	crimped						115	115							
	abrasive						115*	115/125							
Cup brush	knotted		115/125	125	150		180		230						
	crimped	115/125		125	150		150/180			230			230		
	abrasive		115/125				150*								

*variable speed angle grinders or cordless angle grinders

Product Advice for Weld Seam Cleaning

MMA, TIG/MIG/MAG and plasma welding techniques leave different debris and inclusions on the surface of the weld seam. Slag, spatters, silicates and blue discolouring must be removed. If the welded part is not optimally cleaned, faults/defects in the coating and corrosion can occur in the area of the inclusions.

Osborn can offer you the right cleaning tool for every welding technique and type of seam treated (root and closure welds, fill layers). In the product range for this work, we have brushes as well as roughing, flap and polishing flap discs, coarse cleaning fleeces, and carbide cutters.

MMA



Slag

Residue formed when the electrodes wear. Use coarsely knotted wires with a diameter of 0.50 - 0.80 mm to remove slag.

TIG, MIG, MAG, Plasma



Spatters

Abrasive discs are required to grind of these residues.

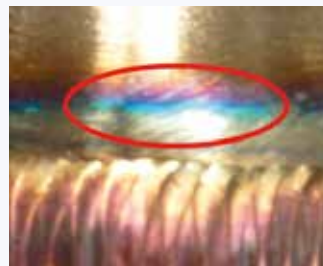

Blue discolouration

Oxide deposits, formed mainly when welding stainless steel. Crimped fine stainless steel wires with a diameter of 0.20 - 0.30 mm are ideal for removing blue discolouration.



Silicates

They form when silicone, present in most steel alloys, is burnt during the welding process and turn to silicone dioxide. Use a medium wire with a diameter of 0.35 - 0.50 mm to remove silicates.



Treatment of Weld Seams. When to use what.

Our practical welding matrix shows you the right tool for every application.

www.osborn.com/en/service/catalogues



Angle Grinders

Wheel Brushes



Appearance can vary from picture depending on variant.



EUPBWB001 | SUPERIOR ★★☆☆☆

Wheel brushes, knotted wire

Knotted wheel brush, industrial quality, for general use on all common angle grinders.

- Aggressive and speedy cleaning; all wire tips are in use at the same time
- Long service life
- TÜV-Süd certified (safety tested, production monitored)
- Available in diverse specifications with arbor hole or thread M14

Application: For roughing, deburring and simple rust removal work.

Available in practical POS box packaging with Euro-standard hole for ideal presentation at the POS.



∅	A	T	B	G	Adapt.	RPM max.	DU	PKG.	Steel 0.35	Steel 0.50	Steel 0.80
75	12	15	13			20000	12		● 0002-611 131	● 0002-611 151	
100	12	20	22.2		HP	12500	8	POS Box	● 0002-621 131	● 0002-621 151	
115	6	19	22.2			12000	10	POS Box	● 9502-626 301	● 9502-626 501	
115	12	12	22.2		HP	12500	10	POS Box	● 0002-631 131		
115	12	22	22.2		HP	12500	10	POS Box		● 0002-631 151	
115	12	23		M14		12500	6	POS Box	● 0402-631 131	● 0402-631 151	
125	6	24	22.2			12000	8	POS Box	● 9502-626 311	● 9502-626 251	
125	13	28		M14		12500	8	POS Box	● 1402-631 131	● 1402-631 151	
125	13	28	22.2		HP	12500	8	POS Box	● 6152-631 131	● 2202-631 151	
150	13	37	22.2		HP	12000	5	POS Box	● 0002-641 131	● 0002-641 151	● 0002-641 181
178	6	38	22.2			12000	12		● 4602-626 131		
178	13	42	22.2		HP	10000	6	POS Box	● 0002-653 131	● 0002-653 151	● 0002-653 181
230	6	57	22.2			12000	1	POS Box		● 4306-026 904	
230	13	58	22.2		HP	8500	1	POS Box		● 9502-664 151	

∅	A	T	B	G	Adapt.	RPM max.	DU	PKG.	INOX 0.35	INOX 0.50	
100	12	20	22.2		HP	12500	4	POS Box		● 0002-621 351	
115	12	22		M14		12500	4	POS Box	● 0402-631 331		
115	12	23		M14		12500	4	POS Box		● 0402-631 351	
115	12	23	22.2		HP	12500	4	POS Box	● 0002-631 331	● 0002-631 351	
125	6	24	22.2			12000	3	POS Box		● 9502-626 651	
125	13	26		M14		12500	3	POS Box		● 1402-631 351	
125	13	27.5	22.2		HP	12500	3	POS Box		● 2202-631 351	
125	13	28		M14		12500	3	POS Box	● 1402-631 331		
125	13	28	22.2		HP	12500	3	POS Box	● 2202-631 331		
150	13	37	22.2		HP	12000	3	POS Box		● 0002-641 351	
178	6	38	22.2		HP	12000	12		● 4612-626 331		
178	13	42	22.2		HP	10000	3	POS Box		● 0002-653 351	



Appearance can vary from picture depending on variant.



EUPBWB002 | PERFECT ★★☆☆☆

Wheel brushes, knotted wire

Knotted wheel brush, quality craftsman quality, for general use on all common angle grinders.

- Speedy cleaning
- Satisfactory removal rate
- Suitable for many DIY projects

Application: For simple deburring and cleaning work.

Available in practical PET packaging with Euro-standard hole for ideal presentation at the POS.



Ø	A	T	B	RPM max.	DU	PKG.	Steel 0.50
115	10	20	22.2	12500	10	POS PET	● 2008-631 151
125	12	27	22.2	12500	12	POS PET	● 2118-631 151



Appearance can vary from picture depending on variant.



EUPBWB003 | SUPERIOR ★★★★★

Wheel brushes, knotted wire

Knotted wheel brush with special left/right knotting, industrial quality, for simple fitting on all common angle grinders.

- Low-vibration and quiet operation
- Prolonged life and high removal rate
- “untwisting” of the knots during use is minimised
- Reduced kick-back
- TÜV-Süd certified (safety tested, production monitored)

Application: Deburring, cleaning of weld seams (slag, silicates, blue discolouring), removal of stubborn rust deposits.

Ø	A	T	B	RPM max.	DU	Steel 0.35	Steel 0.50
115	12	23	22.2	12500	10	● 1202-631 131	● 1202-631 151
125	13	28	22.2	12500	8	● 1212-631 131	● 1212-631 151
178	13	42	22.2	10000	6	● 1202-653 131	● 1202-653 151

Angle Grinders

Wheel Brushes



Appearance can vary from picture depending on variant.

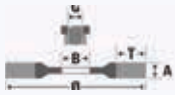

EUPBWB004 | EVOLUTION ★★★★★

Wheel brushes, knotted Osborn wire

Knotted wheel brush, high-end quality, for simple fitting on all common angle grinders.

- High-performance wire developed by Osborn
- Particularly cost-effective
- Long life, high tensile strength, high breaking strain and short set-up times
- Wire ensures the brush is worn uniformly

Application: Deburring, cleaning of weld seams (slag, silicates, blue discolouring), removal of stubborn rust deposits.

∅	A	T	B	G	Adapt.	RPM max.	DU	Steel 0.35	Steel 0.50	INOX 0.50
75	13	17	12.7			20000	12	● 9906-026 011		
100	13	22	15.88			18000	12	● 9906-026 116		
100	13	22	15.88		HP	18000	12		● 9906-026 117	
115	6	19	22.2		HP	12500	12		● 2906-026 501	● 0002-626 650
125	6	24	22.2		HP	12000	12		● 0002-626 251	● 0002-626 651
150	6	38		M14		12000	10		● 9906-026 500	
150	6	38	22.2		HP	12000	12		● 9906-026 501	
150	25	38	22.2			12000	12	● 9906-026 247		
165	6	29	22.2		HP	10000	12		● 0002-626 061	
171	6	29	22.2		HP	12000	12		● 9706-026 904	
178	6	38	22.2		HP	12000	12		● 9906-026 051	



Appearance can vary from picture depending on variant.



EUPBWB005 | EVOLUTION ★★★★★

Wheel brushes, knotted Osborn wire, plastic-bonded

Plastic-bonded, knotted wheel brush, high-end quality.

- Reduced wire breakage due to plastic bonding
- Very long service life
- More aggressive cleaning effect than conventional wheel brushes

Application: Removal of slag and silicates, suitable for root welds and fill layers, recommended for hand-welded joints with high levels of dirt.

∅	A	T	B	RPM max.	DU	Steel 0.50
115	6	19	22.2	12000	10	● 5402-921 873
125	6	24	22.2	12000	10	● 9802-921 873
178	6	38	22.2	8500	12	● 9802-921 875



Appearance can vary from picture depending on variant.



EUPBWB006 | EVOLUTION ★★★★★

Wheel brushes, crimped wire, plastic-bonded

Plastic-bonded, crimped wheel brush, high-end quality.

- Particularly narrow design for tight joints
- Precision working
- Reduced wire breakage due to plastic bonding
- Lower applied force, lower contact pressure

Application: Removal of silicate and weld residues, recommended for root seams welded using TIG/MIG/MAG.

∅	A	T	B	G	RPM max.	DU	Brass Coated Steel 0.38
125	5	32.5		M14	12000	12	● 4102-921 051
152.4	5	29	22.23		8500	12	● 0002-921 874
178	3	41	22.23		8500	1	● 7702-921 875
178	5	41	22.23		8500	12	● 0002-921 875



Appearance can vary from picture depending on variant.



EUPBWB007 | SUPERIOR ★★★★★☆

Wheel brushes, stranded, crimped wire

Wheel brush with Cordwire for angle grinders with M14 thread.

- Brass-coated, stranded steel wire
- Effective woodworking, high friction on soft and hardwood
- TÜV-Süd certified (safety tested, production monitored)

Application: Excellently suited to texturing wood. The natural grain of the wood is emphasized and an antique or rustic effect is created. The filaments of the brush ream the softer places of the wood more than the hard ones. So they expose the wood grain and leave a sort of relief surface.

Available in practical POS box packaging with Euro-standard hole for ideal presentation at the POS.



∅	A	T	G	RPM max.	DU	PKG.	Brass Coated Steel 0.27
115	12	27.5	M14	12500	6	POS Box	● 2812-522 051

Angle Grinders

Wheel Brushes



Appearance can vary from picture depending on variant.

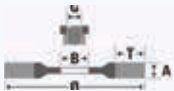

EUPBWB008 | SUPERIOR ★★★★★

Wheel brushes, abrasive filament

Wheel brush for woodworking, with abrasive trim.

- Suited well to following exactly the material direction for texturing and finishing of wood profiles
- Varying surface patterns possible depending on grit selected
- The low weight of the plastic body ensures it is easy to guide and that work is effortless

Application: Removal of lacquer and pickling, cleaning, texturing, finishing and intermediate lacquer sanding.

∅	A	T	G	RPM max.	DU	Novofil NN-S 46	Novofil NN-S 60	Novofil NN-S 80
140	55	30	M14	4500	6	● 5421-401 913	● 5411-401 913	● 5401-401 913



Appearance can vary from picture depending on variant.

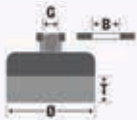

EUPBCB001 | SUPERIOR ★★☆☆☆

Cup brushes, knotted wire

Knotted cup brush, industrial quality, for use on angle grinders.

- General-purpose talent, Osborn bestseller
- Impressive cleaning effect
- Solution of choice for cleaning large surfaces
- Long service life, low set-up costs/time
- TÜV-Süd certified (safety tested, production monitored)

Application: Rust removal, paint stripping, removing slag, silicate residuals and blue discolouring.

3892-608 131 extra long Trim

Available in practical POS box packaging with Euro-standard hole for ideal presentation at the POS.



∅	T	B	G	RPM max.	DU	PKG.	Steel 0.35	Steel 0.50
65	20		M10x1,25	12500	10	POS Box	● 2352-608 131	● 2352-608 151
65	20		M10x1,5	12500	10	POS Box	● 0102-608 131	● 0102-608 151
65	20		M14	12500	10	POS Box	● 0002-608 131	● 0002-608 151
65	20	16		12500	10	POS Box	● 1602-608 131	● 1602-608 151
65	30		M14	12500	10		● 3892-608 131	

∅	T	B	G	RPM max.	DU	PKG.	INOX 0.35	INOX 0.50
65	20		M10x1,25	12500	6	POS Box	● 2352-608 331	
65	20		M10x1,5	12500	6	POS Box	● 0102-608 331	● 0102-608 351
65	20		M14	12500	6	POS Box	● 0002-608 331	● 0002-608 351
65	20	16		12500	6	POS Box	● 1602-608 331	

Angle Grinders

Cup Brushes



Appearance can vary from picture depending on variant.

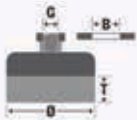

EUPBCB002 | SUPERIOR ★★☆☆☆

Cup brushes, knotted wire

Knotted cup brush, industrial quality, for use on angle grinders.

- Long life, low set-up costs / short set-up times
- Impressive cleaning effect
- Solution of choice for cleaning large surfaces
- Additional stabilisation of the trimming by the support ring
- Support ring is easy to remove. Afterwards the left trim length is useable

Application: Rust removal, paint stripping, removing slag, silicate residuals and blue discolouring.

Available in practical POS box packaging with Euro-standard hole for ideal presentation at the POS.



Did you know?

The support ring is there to stabilise the fill material. After the free filament has worn down, the support ring can be removed, enabling to continue work with the filament material available.



Scan the QR code for video instructions or visit our YouTube channel.

∅	T	G	RPM max.	DU	PKG.	Steel 0.35	Steel 0.50	Steel 0.80
75	20	M14	11000	10	POS Box	● 9908-608 132	● 9908-608 152	
80	20	5/8"	8500	6	POS Box	● 0802-608 133	● 0802-608 153	● 0802-608 183
80	20	M14	8500	6	POS Box	● 0002-608 133	● 0002-608 153	● 0002-608 183
100	20	5/8"	8500	3	POS Box	● 0802-608 134	● 0802-608 154	● 0802-608 184
100	20	M14	8500	3	POS Box	● 0002-608 134	● 0002-608 154	● 0002-608 184
120	20	5/8"	6500	4	POS Box	● 0802-608 135	● 0802-608 155	● 0802-608 185
120	20	M14	6500	4	POS Box	● 0002-608 135	● 0002-608 155	● 0002-608 185

∅	T	G	RPM max.	DU	PKG.	INOX 0.35	INOX 0.50	
80	20	M14	8500	3	POS Box	● 0002-608 333	● 0002-608 353	
100	20	M14	8500	3	POS Box	● 0002-608 334	● 0002-608 354	



Appearance can vary from picture depending on variant.

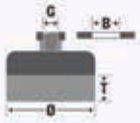

EUPBCB003 | EVOLUTION ★★★★★

Cup brushes, knotted wire

Knotted cup brush, high-end quality, for use on angle grinders.

- High-performance wire developed by Osborn
- Particularly cost-effective
- Long life, high tensile strength, high breaking strain and short set-up times
- Special feature: individual knot ends are slightly open, so that the wire tips are in use immediately and directly
- Higher removal rate, aggressive cleaning performance

Application: Paint/rust removal, deburring, descaling, removal of slag, silicate residues and blue discoloration, cleaning of fill layers and surfaces in the oil and gas industries.

ø	T	G	DU	Steel 0.50
90	32	5/8"	6	● 9906-033 126
90	32	M14	6	● 9906-033 125



Appearance can vary from picture depending on variant.

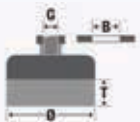

EUPBCB004 | PERFECT ★★★☆☆

Cup brushes, knotted wire

Knotted cup brush, craftsman quality, for use on angle grinders.

- Osborn bestseller in the DIY sector
- Good cleaning performance
- Best price/performance ratio
- Easy cleaning of larger areas

Application: Paint/rust removal, removal of slag.

Available in practical PET packaging with Euro-standard hole for ideal presentation at the POS.



ø	T	G	RPM max.	DU	PKG.	Steel 0.35	Steel 0.50
65	20	M14	12500	10	POS PET	● 2008-608 131	● 2008-608 151
75	27	M14	11000	10	POS PET		● 2008-608 152
80	22	M14	8500	10	POS PET		● 2008-608 153
100	22	M14	8500	5	POS PET		● 2008-608 154

Angle Grinders

Cup Brushes



Appearance can vary from picture depending on variant.

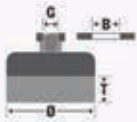

EUPBCB005 | SUPERIOR ★★☆☆☆

Cup brushes, crimped wire

Crimped cup brush, industrial quality, for use on angle grinders.

- Flexible trim material that adapts perfectly to the workpiece contour
- The optimum angle for the brush to operate at is already specified by the trim shape of the brush
- TÜV-Süd certified (safety tested, production monitored)

Application: Cleaning, removal of paint, rust, slag, blue discolouration.

Available in practical POS box packaging with Euro-standard hole for ideal presentation at the POS.



ø	T	G	B	RPM max.	DU	PKG.	Steel 0.20	Steel 0.30
60	21	M10x1,5		12500	10	POS Box		● 0102-613 161
60	21	M14		12500	10	POS Box	● 0002-613 141	● 0002-613 161
75	23		16	12500	10	POS Box		● 1602-613 162
75	23	5/8"		12500	10	POS Box	● 0802-613 142	● 0802-613 162
75	23	M10x1,25		12500	10	POS Box	● 5652-613 142	
75	23	M10x1,5		12500	10	POS Box	● 0102-613 142	● 0102-613 162
75	23	M14		12500	10	POS Box	● 0002-613 142	
75	25	M14		12500	10	POS Box		● 0002-613 162

ø	T	G	B	RPM max.	DU	PKG.	INOX 0.30	Brass 0.30
60	21		16	12500	4	POS Box	● 1602-613 361	
60	21	M10x1,25		12500	10	POS Box		● 4912-613 561
60	21	M14		12500	4	POS Box	● 0002-613 361	
60	21	M14		12500	10	POS Box		● 4902-613 561
75	23	5/8"		12500	4	POS Box	● 0802-613 362	
75	25	M14		12500	10	POS Box	● 0002-613 362	● 4902-613 562



Appearance can vary from picture depending on variant.

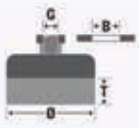

EUPBCB006 | SUPERIOR ★★☆☆☆

Cup brushes, crimped wire

Crimped cup brush, industrial quality, for use on angle grinders.

- Flexible trim material that adapts perfectly to the workpiece contour
- The optimum angle for the brush to operate is already specified by the trim shape of the brush
- TÜV-Süd certified (safety tested, production monitored)

Application: Cleaning, removal of paint, rust, slag, blue discolouration.

Available in practical POS box packaging with Euro-standard hole for ideal presentation at the POS.



ø	T	G	RPM max.	DU	PKG.	Steel 0.20	Steel 0.30	Steel 0.50
80	25	M14	8500	5	POS Box	● 0002-613 143	● 0002-613 163	● 0002-613 193
100	30	5/8"	8500	3	POS Box	● 0802-613 144	● 0802-613 164	● 0802-613 194
100	30	M14	8500	3	POS Box	● 0002-613 144		● 0002-613 194
100	30	M14	8500	4	POS Box		● 0002-613 164	
125	30	5/8"	6500	4	POS Box		● 0802-613 165	● 0802-613 195
125	30	M14	6500	4	POS Box	● 0002-613 145	● 0002-613 165	
125	35	M14	6500	4	POS Box			● 0002-613 195
150	40	5/8"	4500	3	POS Box		● 0802-613 166	● 0802-613 196
150	40	M14	4500	3	POS Box	● 0002-613 146	● 0002-613 166	● 0002-613 196

ø	T	G	RPM max.	DU	PKG.	INOX 0.30	Brass 0.30	
80	25	5/8"	8500	4	POS Box	● 0802-613 363		
80	25	M14	8500	4	POS Box	● 0002-613 363		
80	25	M14	8500	5	POS Box		● 4902-613 563	
100	25	M14	8500	3	POS Box	● 0002-613 364		
100	30	5/8"	8500	3	POS Box	● 0802-613 364		
125	30	M14	6500	2	POS Box	● 0002-613 365		

Angle Grinders

Cup Brushes



Appearance can vary from picture depending on variant.

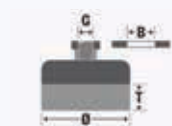

EUPBCB007 | PERFECT ★★☆☆☆

Cup brushes, crimped wire

Crimped cup brush, craftsman quality, for use on angle grinders.

- Osborn bestseller in the DIY sector
- Flexible trim material that adapts perfectly to the workpiece contour
- Good cleaning performance
- Best price/performance ratio

Application: Paint stripping and rust removal from surfaces.

Available in practical PET packaging with Euro-standard hole for ideal presentation at the POS.



ø	T	G	RPM max.	DU	PKG.	Steel 0.30	Brass Coated Steel 0.30
60	18	M14	12500	10	POS PET	● 2008-613 161	● 2008-613 061
75	25	M14	12500	10	POS PET	● 2008-613 162	● 2008-613 062
80	25	M14	8500	10	POS PET	● 2008-613 163	● 2008-613 063
100	25	M14	8500	5	POS PET	● 2008-613 164	● 2008-613 064
125	30	M14	6500	5	POS PET	● 2008-613 165	● 2008-613 065



Appearance can vary from picture depending on variant.

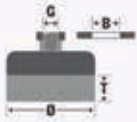

EUPBCB008 | XTREME ★★★★★

Cup brushes, crimped Xtreme wire

Crimped cup brush with stranded, special Xtreme wire for use on angle grinders.

- Four times longer service life than common, crimped cup brushes, Highest removal rate in this segment
- Risks of wire breaks low to none, Ergonomic, low contact pressure necessary
- Effective cleaning performance, Creates a uniform, almost satin surface finish
- Combines the aggressive cleaning performance of knotted brushes with the flexibility of soft, crimped brushes
- TÜV-Süd certified (safety tested, production monitored)

Application: Deburring, edge rounding, removal of rust, paint, scales, slag, silicate residues and blue discolouration.

Available in practical POS box packaging with Euro-standard hole for ideal presentation at the POS.



ø	T	G	RPM max.	DU	PKG.	Steel 0.30
60	20	M14	12500	10	POS Box	● 3902-613 161
75	25	M14	12500	10	POS Box	● 3912-613 163
80	25	M14	12500	5	POS Box	● 3902-613 163
100	22	M14	8500	4	POS Box	● 3902-613 164

Angle Grinders

Cup Brushes



Appearance can vary from picture depending on variant.

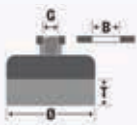

EUPBCB009 | SUPERIOR ★★☆☆☆

Cup brushes, arbor hole, abrasive filament

Cup brush with abrasive trim, industrial quality, for use on angle grinders.

- Powerful high-tech material
- Pinpoint, controlled application on surfaces
- Very flexible trim material; If individual filaments lie flat during use, continue working with the edge nevertheless because the length of the trim material has end-to-end abrasive grit
- Different grits are available for selection: the higher the grit size, the finer the surface pattern

Application: Paint removal, deburring and cleaning of metal and wooden surfaces.

ø	T	B	G	RPM max.	DU	Novofil NN-S 80	Novofil NN-S 120	Novofil NN-S 180
100	25	22.2		8500	3	● 8812-607 914	● 2312-607 914	● 1802-607 914



Appearance can vary from picture depending on variant.

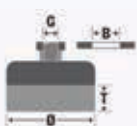

EUPBCB010 | SUPERIOR ★★☆☆☆

Cup brushes, abrasive filament

Punched disc brush with abrasive trim material for woodworking, for use on angle grinders with adjustable speed.

- For use on large surfaces
- Varying surface pattern possible depending on grit selected
- The low weight of the plastic body ensures it is easy to guide and that work is effortless

Application: Particularly well suited for removing lacquer and stains, for cleaning, texturing, finshing and intermediate lacquer sanding.

- 9301-614 916** Grit 46 – For creating a depth texture in the wood
- 9311-614 916** Grit 60 – For removing minor to medium levels of dirt, and uniform texturing of the wood
- 9321-614 916** Grit 80 – Preparation before finishing, evens out minor surface irregularities
- 9331-614 916** Korn 120 – Erzeugung des finalen Schriff auf der Holzoberfläche

A	T	G	RPM max.	DU	Novofil NN-S 46	Novofil NN-S 60	Novofil NN-S 80	Novofil NN-S 120
130	50	M14	2500	4	● 9301-614 916	● 9311-614 916	● 9321-614 916	● 9331-614 916



Appearance can vary from picture depending on variant.



EUPBCB011 | SUPERIOR ★★☆☆☆

Cup brushes, abrasive filament

Cup brush with abrasive Novofil® trim material, industrial quality, for use on angle grinders.

- Long service life
- Low set-up costs / short set-up times
- For effortless and efficient working

Application: Very well suited to treating vertical surfaces and walls made of assembled flat or round wood elements.

7902-613 196 Grit 46 – For creating a depth texture in the wood

7922-613 196 Grit 60 – For removing minor to medium levels of dirt, and uniform texturing of the wood

7932-613 196 Grit 80 – Preparation before finishing, evens out minor surface irregularities

7942-613 196 Grit 120 – Creation of the final finish on the wood surface

ø	T	G	RPM max.	DU	Novofil NH-S 46	Novofil NH-S 60	Novofil NH-S 80	Novofil NN-S 120
150	25	M14	8500	2	● 7902-613 196	● 7922-613 196	● 7932-613 196	● 7942-613 196

Angle Grinders

Bevel Brushes



Appearance can vary from picture depending on variant.

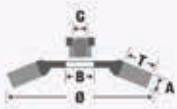

EUPBBB001 | SUPERIOR ★★★★★

Bevel brushes, twist knot wire

Knotted bevel brush, industrial quality, for use on angle grinders.

- Aggressive cleaning performance
- Long service life
- Combines the best properties of a cup brush with those of a wheel brush
- Workpieces with large areas and difficult to access places can be treated perfectly
- TÜV-Süd certified (safety tested, production monitored)

Application: Deburring, removal of rust, paint, slag, silicates and blue discoloration on complex workpieces.

Available in practical POS box packaging with Euro-standard hole for ideal presentation at the POS.



∅	A	T	G	Knots	RPM max.	DU	PKG.	Steel 0.35	Steel 0.50
100	13	22	M10x1,25	18	12500	10	POS Box	● 4802-622 131	● 2352-622 151
100	13	22	M10x1,5	18	12500	10	POS Box	● 0102-622 131	● 0102-622 151
100	13	22	M14	18	12500	10	POS Box	● 0002-622 131	● 0002-622 151
100	13	22	M14	22	12500	10	POS Box	● 0002-623 131	
115	15	20	5/8"	18	12500	10	POS Box	● 0802-632 131	● 0802-632 151
115	15	20	M14	18	12500	10	POS Box	● 0002-632 131	● 0002-632 151
125	15	23	M14	24	12500	10	POS Box	● 3602-632 131	● 2902-632 151

∅	A	T	G	Knots	RPM max.	DU	PKG.	INOX 0.35	INOX 0.50
100	13	22	M10x1,25	18	12500	10	POS Box	● 4802-622 331	● 2352-622 351
100	13	22	M10x1,5	18	12500	10	POS Box	● 0102-622 331	● 0102-622 351
100	13	22	M14	18	12500	10	POS Box	● 0002-622 331	● 0002-622 351
115	15	20	M14	18	12500	5	POS Box	● 0002-632 331	
115	15	20	M14	18	12500	10	POS Box		● 0002-632 351
125	15	23	M14	24	12500	10	POS Box	● 3602-632 331	● 3602-632 351



Appearance can vary from picture depending on variant.



EUPBBB002 | PERFECT ★★☆☆☆

Bevel brushes, twist knot wire

Knotted bevel brush, craftsman quality, for use on angle grinders.

- Good cleaning performance and service life
- Best price/performance ratio
- Processing of large surfaces and hard to reach areas

Application: Rust removal, paint stripping, deburring.

Available in practical PET packaging with Euro-standard hole for ideal presentation at the POS.



∅	A	T	G	RPM max.	DU	PKG.	Steel 0.50
100	13	22	M14	12500	8	POS PET	● 2008-622 151

Angle Grinders

Bevel Brushes



Appearance can vary from picture depending on variant.

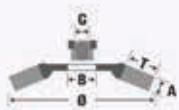

EUPBBB003 | SUPERIOR ★★★★★

Bevel brushes, crimped wire

Crimped bevel brush, industrial quality, for use on angle grinders.

- Flexible trim material, adjusts perfectly to the workpiece
- The longer the trim material, the more flexible the brush. Combines the best properties of a cup brush with those of a wheel brush
- Processing of large surfaces and hard to reach areas
- Depending on the workpiece geometry, the brush is available in different working widths guaranteeing pinpoint deployment
- TÜV-Süd certified (safety tested, production monitored)

Application: Rust removal, paint stripping, deburring, silicates.

Ø	A	T	G	RPM max.	DU	Steel 0.30	INOX 0.20
100	10	20	M10x1,25	12500	10	● 2352-512 161	
100	10	20	M10x1,5	12500	10	● 0102-512 161	
100	10	20	M14	12500	10	● 0002-512 161	
100	20	20	M10x1,25	12500	10		● 2352-512 342
100	20	20	M10x1,5	12500	10	● 0102-512 162	● 0102-512 342
100	20	20	M14	12500	10	● 0002-512 162	● 0002-512 342
125	10	25	M14	12500	10	● 0002-514 161	

Ø	A	T	G	RPM max.	DU	INOX 0.30	Brass Coated Steel 0.30
100	10	20	M14	12500	10	● 0002-512 361	● 0002-512 061
100	20	20	M10x1,25	12500	10	● 2352-512 362	
100	20	20	M10x1,5	12500	10	● 0102-512 362	
100	20	20	M14	12500	10	● 0002-512 362	● 0002-512 062
125	10	25	M14	12500	10	● 0002-514 361	



Appearance can vary from picture depending on variant.



EUPBBB004 | PERFECT ★★☆☆☆

Bevel brushes, crimped wire

Crimped bevel brush, craftsman quality, for use on angle grinders.

- Ideal for processing areas and surfaces difficult to access
- Suitable for easy to semi-difficult cleaning work
- Best price/performance ratio

Application: Edge rounding, paint/rust removal.

Available in practical PET packaging with Euro-standard hole for ideal presentation at the POS.



∅	A	T	G	RPM max.	DU	PKG.	Steel 0.30	Brass Coated Steel 0.30
100	10	20	M14	12500	10	POS PET		● 2008-512 061
100	16	20	M14	12500	10	POS PET	● 2008-512 161	



Appearance can vary from picture depending on variant.



EUPBBB006 | XTREME ★★★★★★

Bevel brushes, Xtreme Wire, crimped

Bevel Brush with crimped Xtreme wire in high-end quality for use on angle grinders.

- Up to 8 times longer service life than conventional crimped wire brushes
- Flexible Xtreme wire, adjusts perfectly to the workpiece
- Combines the best properties of a cup brush with those of a wheel brush
- Processing of large surfaces and hard to reach areas
- Low vibration, low noise, unique satin finish

Application: Derusting, paint stripping, deburring, removal of silicates

∅	A	T	G	RPM max.	DU	Steel 0.30
100	10	20	M14	12500	10	● 3902-512 161

Angle Grinders

Technical and General Information



Cordless is King.

More power, longer runtimes and all wireless. These are the new generations of cordless tools that make it easy to work wherever there is no power socket. The battery runtimes and performance of the tools have made a quantum leap in the last years. This makes them interesting for more and more users. Particularly in the construction industry, in sanitary and heating construction, caretakers, but also fire brigades, road maintenance and other mobile helpers, the devices are now indispensable without electricity.

Important: Please note that our cordless power tool accessories are also suitable for variable-speed angle grinders



Why special tools?

Cordless power tools are commonly used by mobile services, where the full range of accessories is not available. Users therefore need universal tools which can tackle a variety of tasks on different materials.

In this way the amount of accessories to be carried along on a construction site can be reduced when working on steel, stainless steel and wood.

Commonly cordless angle grinders run with a 30 % reduced working speed compared to usual angle grinders. Having specifically developed accessories for common cordless power tools means that the perfect result of brushes can be reached with a speed of 7,000 to 8,000 RPM.

Osborn Brushes are lighter and therefore prolong the battery life between recharges by 20-25 %.

We make it easy for you!

Osborn has developed tools which are flexible in use, light weight, easy to handle and assure highest precision. The end result will meet all your expectations and fulfill all aspects of work safety. This is the only way to work effectively and get the best out of your cordless power tool.

Benefits

- Low weight
- Precision working
- Multifunctional
- Ease of use
- Reduced imbalance and vibration
- Longer battery life (by 20 to 25 %)
- Fewer charging cycles
- Universal usage on all materials

Good to know

Refer to the respective sections for the grinding and polishing products that are suitable for use on battery-operated angle grinders.



Appearance can vary from picture depending on variant.

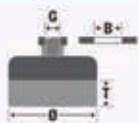

EUPBCB012 | SUPERIOR ★★☆☆☆

Cup brushes, crimped wire

Crimped cup brush, industrial quality, for use on cordless angle grinders and variable-speed angle grinders.

- Low weight
- Extended battery life
- Multifunctional
- reduced imbalance and vibration
- TÜV-Süd certified

Application: Cleaning, satin finishing, smoothing and texturing of different materials.

Available in practical PET packaging with Euro-standard hole for ideal presentation at the POS.



ø	T	G	RPM max.	DU	PKG.	Brass 0.30
60	21	M14	12500	5	POS PET	● 6912-613 561

Angle Grinders

Tools for Cordless Machines



Appearance can vary from picture depending on variant.

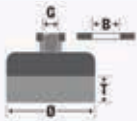

EUPBCB013 | SUPERIOR ★★☆☆☆

Cup brushes, abrasive filament

Cup brush with abrasive trim material, industrial quality, for use on cordless angle grinders and variable-speed angle grinders.

- Weight-optimised
- TÜV-Süd certified
- Very flexible trim material; If individual filaments lie flat during use, continue working with the edge nevertheless because the length of the trim material has end-to-end abrasive grit
- Extended battery life
- reduced imbalance and vibration

Application: Cleaning, satin finishing, smoothing and texturing of different materials.

Available in practical PET packaging with Euro-standard hole for ideal presentation at the POS.



Ø	T	G	Ø Fill	RPM max.	DU	PKG.	Novofil NH-S 46
60	21	M14	1.6	12500	5	POS PET	● 6912-613 891



Appearance can vary from picture depending on variant.

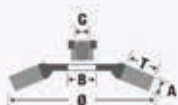

EUPBBB005 | SUPERIOR ★★☆☆☆

Bevel brushes, abrasive filament

Bevel brush with abrasive trim material Novofil NH-S, industrial quality, for use on cordless angle grinders and variable-speed angle grinders.

- Weight-optimised
- TÜV-Süd certified
- Extended battery life
- This means workpieces with large areas and difficult to access places can be treated perfectly
- Reduced imbalance and vibration

Application: Weld seam finishing for TIG/MIG/MAG, paint removal, cleaning, texturing, deburring.

Available in practical PET packaging with Euro-standard hole for ideal presentation at the POS.



∅	A	T	G	∅ Fill	RPM max.	DU	PKG.	Novofil NH-S 46
100	10	20	M14	1.6	12500	5	POS PET	● 6912-622 891

Angle Grinders

Coarse Cleaning Fleece



Appearance can vary from picture depending on variant.



EUGMCF009 | SUPERIOR ★★☆☆☆

Coarse cleaning fleece for angle grinders

Coarse cleaning fleece on glass fibre backing. Suitable for cleaning and polishing all surfaces. Cleaning fleeces attain the best results in sanding and cleaning metals, stainless steel, wood and plastic, and can be used as a preliminary stage before polishing. They are made of intertwined nylon fibres which are immersed in synthetic resin and gently hardened. They are available with a glass fibre backing or for the use with straight or cylindrical grinders.

- Removes old paint, rust and weld spots without scratching the surface of the workpiece
- Cleaning and smoothing wood and plastic

Application: General-purpose use for metals, stainless steel, wood and plastic.

Please note: Coarse cleaning fleeces are not suitable for edge finishing. They remove foreign matter and are non-stock removing.

∅	B	RPM max.	DU	flat
115	22.23	11000	10	● 6700-001 100
125	22.23	10000	10	● 6700-002 100
180	22.23	8500	10	● 6700-003 100



Appearance can vary from picture depending on variant.

EUGMFD001 | PERFECT ★★☆☆☆

ALOX POWER

Cost-effective product for processing steel and wood. A tough, hard abrasive grain enables good removal rates, particularly when grinding surfaces. The glass fibre backing is characterised by an even grinding finish until the abrasive grain is completely consumed. No scratches appear on the workpiece.

- Quick machining
- Fine surface structure
- Good lifetime

Application: Very suitable for processing unalloyed steel, alloyed steel and tool steel. Also suitable for weldseams, wood and plastic.

∅	B	RPM max.	DU	flat 40	flat 60	flat 80	flat 120
115	22.23	13300	10	● 5231-004 100	● 5231-006 100	● 5231-007 100	● 5231-009 100
125	22.23	12250	10	● 5232-004 100	● 5232-006 100	● 5232-007 100	● 5232-009 100

∅	B	RPM max.	DU	tapered 40	tapered 60	tapered 80	
115	22.23	13300	10	● 5231-204 100	● 5231-206 100	● 5231-207 100	
125	22.23	12250	10	● 5232-204 100	● 5232-206 100	● 5232-207 100	

Angle Grinders

Flap Discs for Grinding



Appearance can vary from picture depending on variant.

EUGMFD003 | PERFECT ★★☆☆☆

ZIRCON POWER

All-round flap disc with zirconium corundum band on a cotton polyester cloth. Good removal rate and service life.

- Ideal for surface grinding on steel and stainless steel
- High removal rate and effortless work without clogging
- The glass fibre backing is characterised by an even grinding finish until the abrasive grain is completely consumed. No scratches appear on the workpiece.

Application: Very suitable for processing stainless steel, (un)alloyed steel, weldseams, cast. Also suitable for wood and plastic.

∅	B	RPM max.	DU	flat 40	flat 60	flat 80
115	22.23	13300	10	● 5231-184 100	● 5231-186 100	● 5231-187 100
125	22.23	12250	10	● 5232-184 100	● 5232-186 100	● 5232-187 100

∅	B	RPM max.	DU	tapered 40	tapered 60	tapered 80
115	22.23	13300	10	● 5231-384 100	● 5231-386 100	● 5231-387 100
125	22.23	12250	10	● 5232-384 100	● 5232-386 100	● 5232-387 100



Appearance can vary from picture depending on variant.

EUGMFD006 | SUPERIOR ★★☆☆☆

ZIRCON PLUS

Top-quality zirconium flap disc. Well-suited for deburring, processing welding seams and surface grinding. Very balanced and universally applicable flap disc with brilliant removal rate and outstanding service life. For processing steel and stainless steel. A true four-star all-round disc.

- Ideal for processing edges
- Also very good for surface grinding
- Outstanding grinding performance with superior lifetime
- High removal rate and effortless work without clogging
- Very good surface quality on workpiece

Application: Suits perfectly for (stainless) steel sheets and cast. Very suitable for (un)alloyed steel and weldseams. Also suitable for wood and plastic.

∅	B	RPM max.	DU	flat 40	flat 60	flat 80
115	22.23	13300	10	● 5241-104 100	● 5241-106 100	● 5241-107 100
125	22.23	12250	10	● 5242-104 100	● 5242-106 100	● 5242-107 100

∅	B	RPM max.	DU	tapered 40	tapered 60	tapered 80
115	22.23	13300	10	● 5241-304 100	● 5241-306 100	● 5241-307 100
125	22.23	12250	10	● 5242-304 100	● 5242-306 100	● 5242-307 100

Angle Grinders

Flap Discs for Grinding



Appearance can vary from picture depending on variant.

EUGMFD007 | SUPERIOR ★★★★★

ZIRCON PRIME G-AZ

Special flap disc with zirconium corundum. This abrasive grain cloth is less hard, but very tough, and gives the disc very good all purpose characteristics.

- Robust abrasive belt for high demands
- Brilliant grinding capacity
- Outstanding service
- It is used for such demanding operations as deburring, machining welding seams and breaking edges
- The glass fibre backing is characterised by an even grinding finish until all of the abrasive grain has been worn away. Leaves no scratches on the workpiece

Application: Suits perfectly for (stainless) steel sheets and cast. Very suitable for (un)alloyed steel and weldseams. Also suitable for wood and plastic.

∅	B	RPM max.	DU	flat 40	flat 60	flat 80	flat 120
115	22.23	13300	10	● 5211-104 100	● 5211-106 100	● 5211-107 100	● 5211-109 100
125	22.23	12250	10	● 5212-104 100	● 5212-106 100	● 5212-107 100	● 5212-109 100

∅	B	RPM max.	DU	tapered 40	tapered 60	tapered 80
115	22.23	13300	10	● 5211-304 100	● 5211-306 100	● 5211-307 100
125	22.23	12200	10		● 5212-306 100	
125	22.23	12250	10	● 5212-304 100		● 5212-307 100



Appearance can vary from picture depending on variant.

EUGMFD011 | SUPERIOR ★★☆☆☆

CERA PLUS

Flap disc with self-sharpening ceramic grain, which permanently enables an extremely high removal rate and guarantees a long service life. Outstanding results for surface and edge grinding of steel or stainless steel. The robust polyester backing and a full resin bond with additives that actively support grinding guarantee that the abrasive grain on the backing remains resistant to wear, even under high stress. This makes CERA PLUS ideal for extreme grinding work or demanding special tasks.

- Extremely aggressive removal rate with a minimum of effort
- Substantial time savings, clear plus in terms of service life
- Highly resilient
- Self-sharpening
- Cool grinding on surfaces and edges, reduces thermal discolouration on the workpiece

Application: Suits perfectly for high alloy steel, titanium alloys, nickel-base alloys, chrome and chrome-nickel-steel. Very suitable for brass, bronze and cast.

∅	B	RPM max.	DU	flat 40	flat 60	flat 80
115	22.23	13300	10	● 5241-434 100	● 5241-436 100	● 5241-437 100
125	22.23	12250	10	● 5242-434 100	● 5242-436 100	● 5242-437 100

∅	B	RPM max.	DU	tapered 40	tapered 60	tapered 80
115	22.23	13300	10	● 5241-444 100	● 5241-446 100	● 5241-447 100
125	22.23	12250	10	● 5242-444 100	● 5242-446 100	● 5242-447 100

Angle Grinders

Technical and General Information

Efficient Solutions for Surface Processing.



Osborn polishing flap discs deliver outstanding results for the processing of stainless steel, steel, aluminium and non-ferrous metals thanks to an innovative, highly effective grinding fleece arranged in a fan-shaped lamella structure.

- **Highly effective for welding technology and metal processing applications**
Delivers optimal results, for example when preparing welding seams, reworking welding seams and removing weld spatter in accordance with EN ISO 5817. Removes oxide films and thermal discolouration after the welding of pipelines, containers and apparatuses or after the plasma cutting of stainless steel sheets in accordance with DIN 50930, DIN 25410 and DVGW W541.
- **Highly effective for painting technology applications**
Ideal for derusting, paint stripping and preparing surfaces for painting.
- **Extremely versatile**
For cleaning and polishing unalloyed steel, high alloy steel, aluminium and non-ferrous metals. Suitable for edge and surface grinding.



Surfaces descaled prior to welding result in clean welding seams (see image at left)



Quick, professional derusting and descaling



Sanding fine welding seams and removing thermal discolouration



Appearance can vary from picture depending on variant.

EUGMFD013 | SUPERIOR ★★★★★

Polimaxx 1 - coarse

Fleece flap disc with coarse fleece texture (slight machining effect).

- For descaling and derusting workpieces, preparing welding seams, smoothing welding seam flaking, sanding very fine welding seams, removing weld spatters.
- Polimaxx 1 flap discs are also available in sets with Polimaxx 2 and 3 discs.

Application: Universally applicable for stainless steel, steel, aluminium and non-ferrous metals.

∅	B	RPM max.	DU	flat
115	22.23	13300	10	● 5541-204 100
125	22.23	12250	10	● 5542-204 100



Appearance can vary from picture depending on variant.

EUGMFD014 | SUPERIOR ★★★★★

Polimaxx 2 - medium

Fleece flap disc with medium fleece texture (no machining effect).

- For descaling and derusting workpieces, removing paints and varnishes, preparing surfaces for painting, matting of V2A welding seams or surfaces. Removing oxide films and thermal discolouration.
- Polimaxx 2 flap discs are also available in sets with Polimaxx 1 and 3 discs.

Application: Universally applicable for stainless steel, steel, aluminium and non-ferrous metals.

∅	B	RPM max.	DU	flat
115	22.23	13300	10	● 5541-206 100
125	22.23	12250	10	● 5542-206 100

Angle Grinders

Flap Discs for Polishing



Appearance can vary from picture depending on variant.



EUGMFD015 | SUPERIOR ★★☆☆☆

Polimaxx 3 - fine

Fleece flap disc with fine fleece texture (no machining effect).

- For preparing and re-polishing welding seams, sanding fine welding seams, matting of surfaces, removing oxide films, thermal discolouration or thin layers of varnish on metals, polishing stainless steel.
- Polimaxx 4 for mirror finishes available.
- Polimaxx 3 flap discs are also available in sets with Polimaxx 1 and 2 discs.

Application: Universally applicable for stainless steel, steel, aluminium and non-ferrous metals.

∅	B	RPM max.	DU	flat
115	22.23	13300	10	● 5541-207 100
125	22.23	12250	10	● 5542-207 100



Appearance can vary from picture depending on variant.



EUPOBU001 | SUPERIOR ★★☆☆☆

Polimaxx 4 - gloss

The gloss polishing flap disc for angle grinders is equipped with lamellas made of a special high-quality felt.

- Please use with polishing compounds
- Gives a mirror finish

Application: Universally applicable for stainless steel, steel, aluminium and non-ferrous metals.

∅	B	RPM max.	DU	tapered
115	22.23	13300	10	● 5541-220 100
125	22.23	12250	10	● 5542-220 100



EUACAD008

Reducing Ring "HP-Adapter"

Reducing Rings provide a reliable solution for precisely adapting standard bore sizes to smaller diameters.

Appearance can vary from picture depending on variant.

adapt. from	adapt. to	DU	Item Number
16.00	9.50	1	● 0003-000 222
16.00	12.70	1	● 0003-000 223
22.20	9.50	1	● 0003-000 242
22.20	12.70	1	● 0003-000 243
22.20	16.00	1	● 0003-000 244

0				
0002512061	28	0002621151	12	0402631331
0002512062	28	0002621351	12	0402631351
0002512161	28	0002622131	26	0802608133
0002512162	28	0002622151	26	0802608134
0002512342	28	0002622331	26	0802608135
0002512361	28	0002622351	26	0802608153
0002512362	28	0002623131	26	0802608154
0002514161	28	0002626061	14	0802608155
0002514361	28	0002626251	14	0802608183
0002608131	17	0002626650	14	0802608184
0002608133	18	0002626651	14	0802608185
0002608134	18	0002631131	12	0802613142
0002608135	18	0002631151	12	0802613144
0002608151	17	0002631331	12	0802613162
0002608153	18	0002631351	12	0802613164
0002608154	18	0002632131	26	0802613165
0002608155	18	0002632151	26	0802613166
0002608183	18	0002632331	26	0802613194
0002608184	18	0002632351	26	0802613195
0002608185	18	0002641131	12	0802613196
0002608331	17	0002641151	12	0802613362
0002608333	18	0002641181	12	0802613363
0002608334	18	0002641351	12	0802613364
0002608351	17	0002653131	12	0802632131
0002608353	18	0002653151	12	0802632151
0002608354	18	0002653181	12	1
0002611131	12	0002653351	12	1202631131
0002611151	12	0002921874	15	1202631151
0002613141	20	0002921875	15	1202653131
0002613142	20	0003000222	43	1202653151
0002613143	21	0003000223	43	1212631131
0002613144	21	0003000242	43	1212631151
0002613145	21	0003000243	43	1402631131
0002613146	21	0003000244	43	1402631151
0002613161	20	0102512161	28	1402631331
0002613162	20	0102512162	28	1402631351
0002613163	21	0102512342	28	1602608131
0002613164	21	0102512362	28	1602608151
0002613165	21	0102608131	17	1602608331
0002613166	21	0102608151	17	1602613162
0002613193	21	0102608331	17	1602613361
0002613194	21	0102608351	17	1802607914
0002613195	21	0102613142	20	2
0002613196	21	0102613161	20	2008512061
0002613361	20	0102613162	20	2008512161
0002613362	20	0102622131	26	2008608131
0002613363	21	0102622151	26	2008608151
0002613364	21	0102622331	26	2008608152
0002613365	21	0102622351	26	2008608153
0002621131	12	0402631131	12	2008608154
		0402631151	12	2008613061
				2008613062
				2008613063
				2008613064
				2008613065
				2008613161
				2008613162
				2008613163
				2008613164
				2008613165
				2008622151
				2008631151
				2118631151
				2202631151
				2202631331
				2202631351
				2312607914
				2352512161
				2352512342
				2352512362
				2352608131
				2352608151
				2352608331
				2352622151
				2352622351
				2812522051
				2902632151
				2906026501
				3
				3602632131
				3602632331
				3602632351
				3892608131
				3902512161
				3902613161
				3902613163
				3902613164
				3912613163
				4
				4102921051
				4306026904
				4602626131
				4612626331
				4802622131
				4802622331
				4902613561
				4902613562
				4902613563
				4912613561
				5
				5211104100
				5211106100

5211107100	38	5232184100	36	5242437100	39	7932613196	25
5211109100	38	5232186100	36	5242444100	39	7942613196	25
5211304100	38	5232187100	36	5242446100	39	8	
5211306100	38	5232204100	35	5242447100	39	8812607914	24
5211307100	38	5232206100	35	5401401913	16	9	
5212104100	38	5232207100	35	5402921873	14	9301614916	24
5212106100	38	5232384100	36	5411401913	16	9311614916	24
5212107100	38	5232386100	36	5421401913	16	9321614916	24
5212109100	38	5232387100	36	5541204100	41	9331614916	24
5212304100	38	5241104100	37	5541206100	41	9502626251	12
5212306100	38	5241106100	37	5541207100	42	9502626301	12
5212307100	38	5241107100	37	5541220100	42	9502626311	12
5231004100	35	5241304100	37	5542204100	41	9502626501	12
5231006100	35	5241306100	37	5542206100	41	9502626651	12
5231007100	35	5241307100	37	5542207100	42	9502664151	12
5231009100	35	5241434100	39	5542220100	42	9706026904	14
5231184100	36	5241436100	39	5652613142	20	9802921873	14
5231186100	36	5241437100	39	6		9802921875	14
5231187100	36	5241444100	39	6152631131	12	9906026011	14
5231204100	35	5241446100	39	6700001100	34	9906026051	14
5231206100	35	5241447100	39	6700002100	34	9906026116	14
5231207100	35	5242104100	37	6700003100	34	9906026117	14
5231384100	36	5242106100	37	6912613561	31	9906026247	14
5231386100	36	5242107100	37	6912613891	32	9906026500	14
5231387100	36	5242304100	37	6912622891	33	9906026501	14
5232004100	35	5242306100	37	7		9906033125	19
5232006100	35	5242307100	37	7702921875	15	9906033126	19
5232007100	35	5242434100	39	7902613196	25	9908608132	18
5232009100	35	5242436100	39	7922613196	25	9908608152	18

Finish. First.

The Global Leader in Surface Treatment Solutions and Finishing Tools

Osborn GmbH
Ringstraße 10
35099 Burgwald
Germany

Phone: +49 (0)6451 588-0

Fax: +49 (0)6451 588-206

info@osborn.de

www.osborn.com

General

The tools shown in this catalogue, and the information on delivery scopes, appearances, performances and dimensions, correspond to information available at the time of print. We are enhancing our products continually. We reserve the right to make changes to products and prices.

In the event prices are printed in the catalogue, all previous price lists are rendered void on publication of this catalogue. All prices are recommended retail prices in Euro per piece. VAT, packaging, transport/postal charges and insurance are extra. Our general terms and conditions apply for all orders.

Print date: 04.11.2024



osborn.com